



| Model | Voltage | Hz | HP | kW | SCFM | Pressure mbar "H2O | Vacuum mbar "H2O | Noise Level | Net Weight kg lbs | *Percent Eff Pf |
|------------|---------|----|-----|-----|------|-----------------------|---------------------|-------------|----------------------|--------------------|
| RBH3-101-1 | 1 | 60 | 1.1 | .85 | 105 | 144 58 | 148 59 | 64 db(A) | 15.5 35 | NA NA |
| RBH3-101-3 | 3 | 50 | .75 | .87 | 87 | 139 56 | 148 59 | 63 db(A) | 15.5 35 | 81.5 78.4 |
| RBH3-2-2 | 2 | 60 | 2 | 1.5 | 105 | 224 90 | 205 82 | 64 db(A) | 19 43 | NA NA |
| RBH3-2-3 | 3 | 50 | 1.3 | .87 | 87 | 202 81 | 180 72 | 63 db(A) | 19 43 | 84.4 81.78 |

Refer to curves below for detailed performance data. Performance data and product specifications are subject to change without prior notice.
Actual performance may vary by $\pm 10\%$. Eff = Efficiency Pf = Power Factor NA = Not Applicable *Efficiency and power factor only applies to 3/60/460 models NR= Not required

NEW STANDARD FEATURES EC ie3 & DOE EISA

Each All-Star blower is now delivering High Efficiency Performance without added cost or extended deliveries. **How and Why?**



EC ie3 and DOE EISA regulations allow exceptions in their harmonized efficiency standards for certain types of motors. All-Star motors meet the Definite Purpose Partial Motors exceptions, therefore All-Star motors are exempt to these two regulations.

Secondly, All-Star is the only blower company that manufactures their own motors in-house. All-Star three phase motors from 1 to 30 horsepower have been redesigned to high efficiency with out added cost.



Beside the high efficiency performance, All-Star motors provide major features that extend the life and service above all of our competitors. For example, All-Star motors include Class H motor insulation rated 365° F; blower end bearing lubrication is rated 536° F; and the internal seal is rated 500° F - *all standard - and without added cost.*

For more information, visit All-Star at www.all-star-usa.com

Registered and approved by one or more of these standards agency

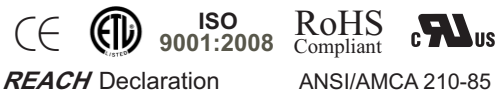

Note: To obtain warranty protection, a properly set relief valve and an air filter must be installed.

Features

- IP 54 TEFC 2 pole squirrel cage ac motor
- 40 Deg C ambient
- Class H insulation 1.15 service factor
- Performance tested ANSI/AMCA210-85
- Quite Duty - below OSHA sound level
- High Efficiency Design

Voltage

- 1 = 1/60/115/230 & 1/50/220
- 2 = 1/60/50/230
- 3 = 3/60/208-230/460 3/50/220/380
- 5 = 3/60/575 available from stock without additional cost

Recommended Accessories

Relief Valve

- Pressure RVA-01
- Vacuum RVA-01

Filter

- Pressure F19P-150
- Vacuum CSL 849-150HC

PRESSURE DATA CURVES $\pm 10\%$

[See reverse side for Vacuum Curves]

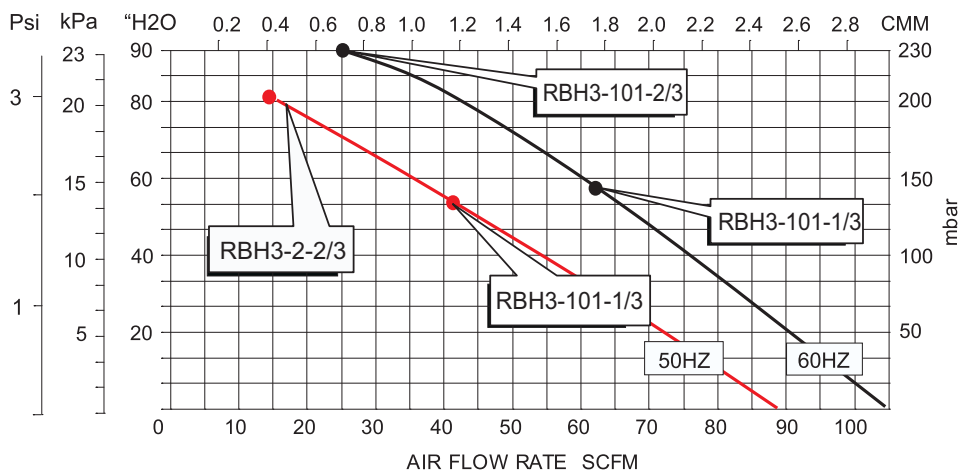

RBH3-101-1/3 RBH3-2-2/3

Revised October 2017

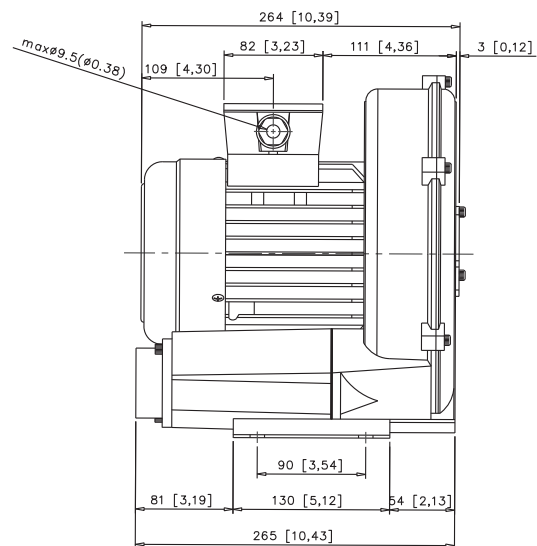
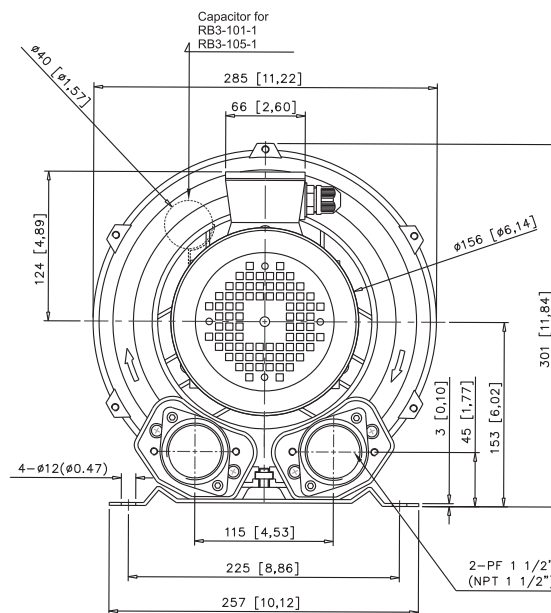
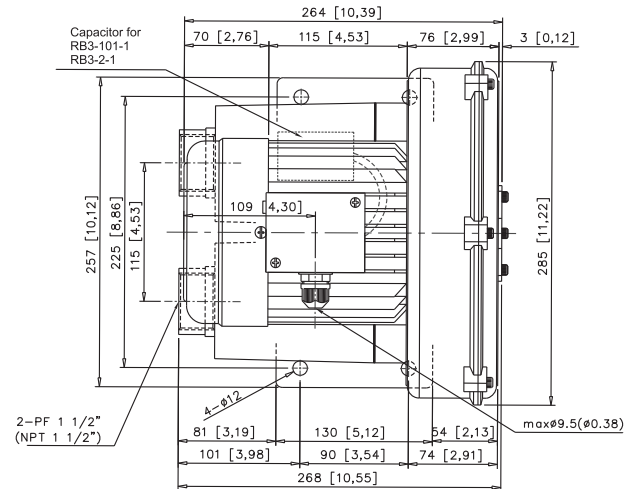
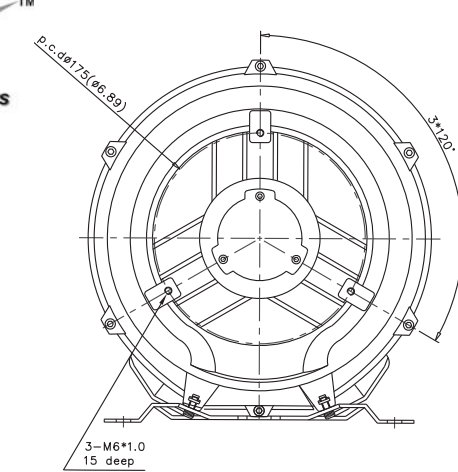

VACUUM DATA CURVES

