



Built in conformance with NSF 50, SPS3, UL1081, UL1563 and CAN/CSA-C 22.2



## FEATURES

Bonding plate and copper wire connection meet NEC section 680.2 C

Conforms to UL 1081, UL 1563, CAN/CSA-C22.2

Bonding plate is safely placed behind the skimmer basket, for constant water contact, even when the pump is off

Adjustable collar

New weir clip lock secures the clips in the weir door

Large self-contained basket with lock-in feature (will not float)

Underwater dampers on face plate for noise reduction on weir plate – especially on windy days

Super strong engineered polymer upper housing

Extra heavy duty PVC lower unit (no transitional glue required)

2½" outside slip and 2" inside slip (outside skimmer)

2" threads for pressure testing (inside skimmer)

Built-in overflow or fill line knock out

Upper housing has pre-cut rebar cut outs with pre-drilled holes for tie wire

Skimmer Lid and Collar G154 UV tested

NSF 50 approved for commercial use, 25 GPM min, 55 GPM max – approved for residential use up to 100 GPM

Optional custom name/logo engraved on lid (requires minimum 500 piece lid order)

1 per case



Part # SKR17xxx

## STANDARD COLORS

- SKR17101 – White
- SKR17102 – Black
- SKR17103 – Light Gray
- SKR17104 – Blue
- SKR17105 – Dark Gray
- SKR17108 – Tan

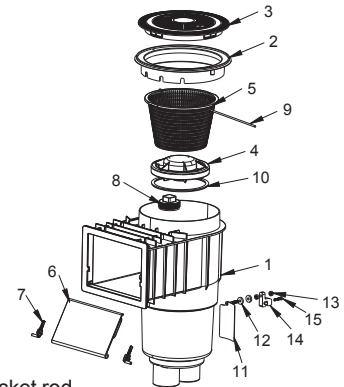
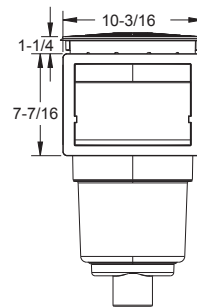
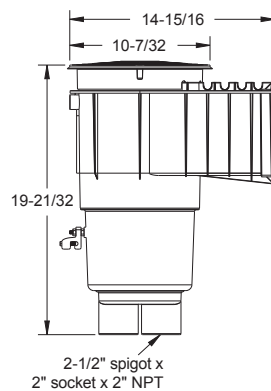

- |                     |  |
|---------------------|--|
| 1. Skimmer body     | 9. Basket rod                          |
| 2. Collar           | 10. Gasket                             |
| 3. Lid              | 11. Bonding plate                      |
| 4. Float assembly   | 12. Rubber washer, bonding seal, qty 2 |
| 5. Basket           | 13. 1/4-20 hex nut, 316 ss, qty 2      |
| 6. Weir assembly    | 14. Bonding clamp                      |
| 7. Weir clip, qty 2 | 15. Bonding screw                      |
| 8. 2" NPT port plug |  |

# SKIMMER OPTIONS

STANDARD COLORS



101



102



103



104



105



108

## Standard Waterstop Face Round Lid

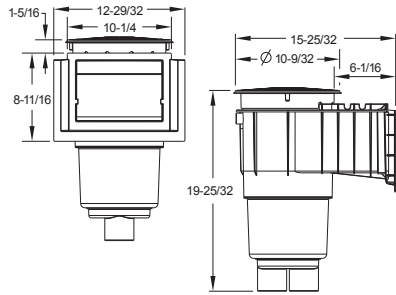

**SKR1xx**  
Standard Skimmer  
with Waterstop Face  
Dual Bottom Port  
2½" Spigot x 2" Socket

**SKR1xxD**  
Single Bottom Port  
4" Socket\*

**SKR1xxF**  
Single Bottom Port  
6" Socket\*

## Standard Flush Face Round Lid

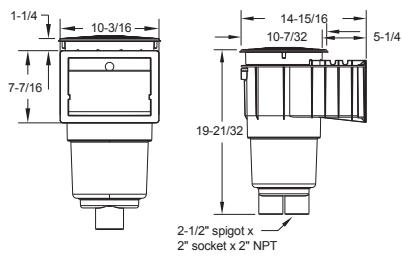

**SKR2xx**  
Standard Skimmer  
with Flush Face  
Dual Bottom Port  
2½" Spigot x 2" Socket

**SKR2xxD**  
Single Bottom Port  
4" Socket\*

**SKR2xxF**  
Single Bottom Port  
6" Socket\*

## Standard Waterstop Face Square Lid

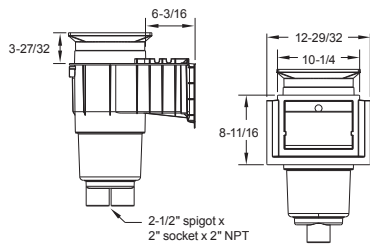

**SK64xxx** Square Lid and  
Collar (sold separately)

**SKR1xx**  
Standard Skimmer  
with Waterstop Face  
Dual Bottom Port  
2½" Spigot x 2" Socket

**SKR1xxD**  
Single Bottom Port  
4" Socket\*

**SKR1xxF**  
Single Bottom Port  
6" Socket\*

## Standard Flush Face Square Lid

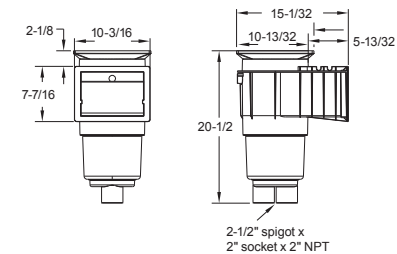

**SK64xxx** Square Lid and  
Collar (sold separately)

**SKR2xx**  
Standard Skimmer  
with Flush Face  
Dual Bottom Port  
2½" Spigot x 2" Socket

**SKR2xxD**  
Single Bottom Port  
4" Socket\*

**SKR2xxF**  
Single Bottom Port  
6" Socket\*

## Standard Waterstop Face Round/Square Snap-in Lid

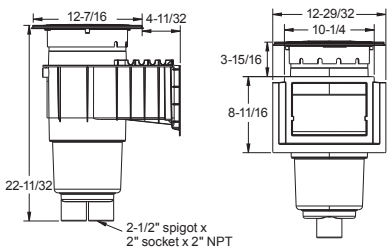

**SK65xxx** Snap-in  
Round/Square Lid and  
Collar (sold separately)

**SKR1xxx**  
with Float Assembly  
Dual Bottom Port  
2½" Spigot x 2" Socket

**SKR1xxxD**  
Single Bottom Port  
4" Socket\*

**SKR1xxxF**  
Single Bottom Port  
6" Socket\*

## Standard Flush Face Round/Square Snap-in Lid

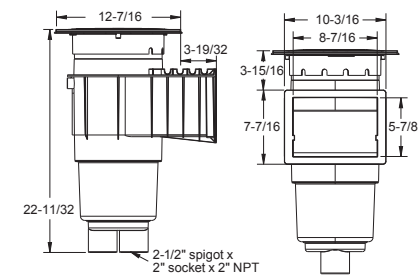

**SK65xxx** Snap-in  
Round/Square Lid and  
Collar (sold separately)

**SKR2xxx**  
with Float Assembly  
Dual Bottom Port  
2½" Spigot x 2" Socket

**SKR2xxxD**  
Single Bottom Port  
4" Socket\*

**SKR2xxxF**  
Single Bottom Port  
6" Socket\*

## Standard Waterstop Face Round/Square Snap-in Lid

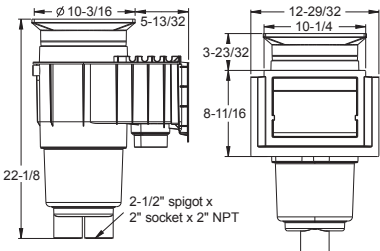

**SK65xxx** Snap-in  
Round/Square Lid and  
Collar (sold separately)

**SKR1xx-OZ**  
with Float Assembly  
and new Ozone Port  
Dual Bottom Port  
2½" Spigot x 2" Socket

## All AquaStar products are made in the U.S.



Every AquaStar pool product is designed and manufactured in the United States, ensuring the highest quality merchandise. Our entire product line is designed to provide the very best look, feel and performance.

\*Includes Pressure Test Plug