

6" Socket Deep PVC Sump

NSF

Certified to
NSF/ANSI/CAN 50
ANSI/APSP/ICC-16 2017

Open Area
90.8 in²

For SOFA Specific Flow Ratings and
specifications please scan QR code or visit
www.aquastarpoolproducts.com/flowcode



Part #
WAV12WRxxxF
4 per case

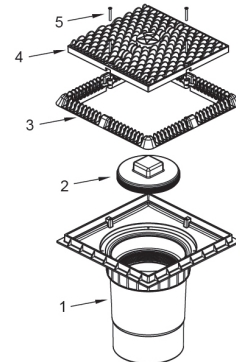
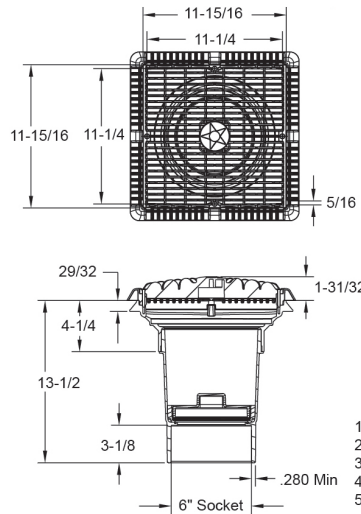

1. 6" Socket Deep PVC Sump
2. 6" Tapered Threaded Pipe Plug
3. 12" Square Vented Riser Ring
4. 12" Square "Wave" Suction Outlet
5. 10 x 1-3/4" Flat Head Phillips, 316 SS, Qty 4

3" Socket x 4" Spigot Side Port PVC Sump

NSF

Certified to
NSF/ANSI/CAN 50
ANSI/APSP/ICC-16 2017

Open Area
90.8 in²

For SOFA Specific Flow Ratings and
specifications please scan QR code or visit
www.aquastarpoolproducts.com/flowcode



NEW Hassle-free pressure testing
and winterizing



**Hassle-free pressure
testing and winterizing**
Comes with a 3" and
2" NPT cap with O-ring.
No knock-outs required.



Optional 2"
hydrostatic relief
valve available
p/n HV101

Part #
WAV12WRxxxSSB
1 per case

2" Plug and O-Ring, p/n 2SBP101
3" Plug and O-Ring, p/n 3SBP101

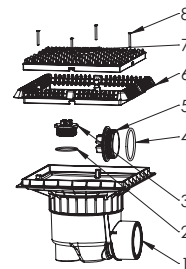
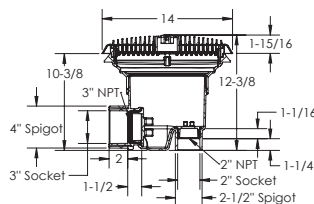
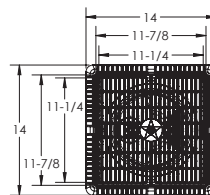

1. Side Port Sump Bucket, 12" Square Frame
2. 2" Plug O-Ring
3. 2" NPT Plug
4. 3" Plug O-Ring
5. 3" NPT Plug
6. 12" Square Riser Ring
7. 12" Square "Wave" Suction Outlet Cover
8. 10 x 13/4" Flat Head Phillips, 316 SS, Qty 4