

32" CHANNEL DRAIN PINHOLE ANTI-ENTRAPMENT SUCTION OUTLET COVER AND THREE-PORT PVC MANUFACTURED SUMP

VGB Series

The AquaStar line of suction outlet covers, compliant with the Virginia Graeme-Baker Pool and Spa Safety Act (ANSI/APSP 16-2011 and NSF/ANSI 50-2009a)

FEATURES

For single or multiple drain use (see installation instructions for plumbing, hydrostatic valve/drain pipe and single or multi-pump connections)

Single

Floor: 268 GPM at 3.1 fps
Wall: 172 GPM at 2.0 fps

Floor/wall: 131 at 1.5 fps
Floor/wall: 87 GPM at 1.0 fps

27.9 square inch opening

#316 stainless steel screws

PVC sump (standard)

Manufactured from superior UV-resistant engineered polymers

Three ports: bottom 2½" OD, 2" ID S/S; inside 2" threaded FPT; two 2" threaded plugs included

All components meet or exceed ANSI/APSP 16-2011 and NSF/ANSI 50-2009a national standards and ASTM G154 UV testing exposure

Disposable plastic pre-gunite/plaster insert keeps debris out and retains sump shape during construction

Does not require use of transition glue

Replace every five years from the date of installation

4 per case

Unblockable!



New waterstop feature

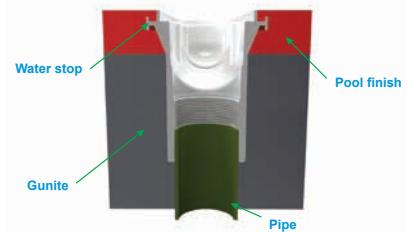

With sump (concrete pools)
Part # 32CDPHxxx

STANDARD COLORS

- 32CDPH101 – White
- 32CDPH102 – Black
- 32CDPH103 – Light Gray
- 32CDPH104 – Blue
- 32CDPH105 – Dark Gray
- 32CDPH108 – Tan

Also available as sump only
32CDPxxx
4 per case

Also available cover only without sump/frame p/n 32CDPHNFxxx
40 per case

VGB 2008 Compliant

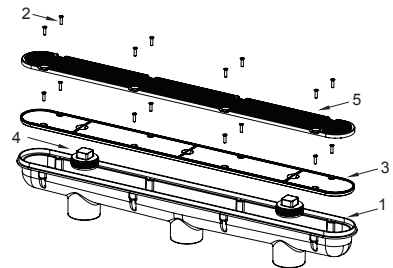
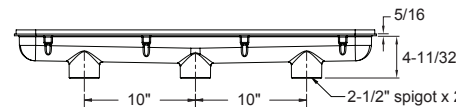
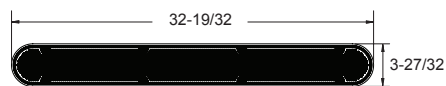

1. 32" three-port manufactured sump
2. #10 x 3/4" flat head Phillips Type A screw, 316 ss, qty 16
3. 32" channel drain, plaster shield
4. 2" NPT plug, qty 2
5. 32" channel drain anti-entrapment suction outlet "pinhole" cover