

4" Adjustable Floor Return Fitting with Water Stop

FEATURES

Diverter plate molded as one piece – no glue joints for longer lasting commercial use
Integrated water stop to reduce leaks
2" x 1½" slip pipe adapter included
Full 360-degree flow
Flow rate up to 80 GPM
CAUTION: NOT to be used as a suction outlet
Manufactured from engineered polymer
UV-resistant ABS material
Stainless steel screws
25 per case
Also available as return diverter plate only for remodels, repairs, etc. p/n DIV0xxx 25 per case

Part # DIV0xxx

Diverter plate fits:
Pentair/Sta-Rite



Part # 4DIVxxx

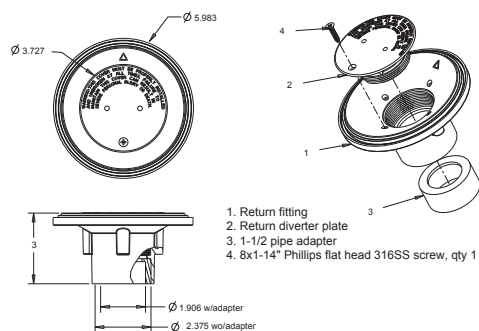

Australian Return Fitting with Adjustable Eyeball 1" Knock-In

FEATURES

Knocks into 1" pipe, no glue necessary
Self-leveling for out-of-square pipes
Flange camouflages pipe and surface construction variations
Adjustable eyeball available in three orifice sizes (1", ¾", ½")
Manufactured from engineered polymer
UV-resistant polypropylene material
500 per case
Additional orifice size suffix: ¾"-B, ½"-C (i.e. 501B = white ¾" orifice)

Part # 5xx

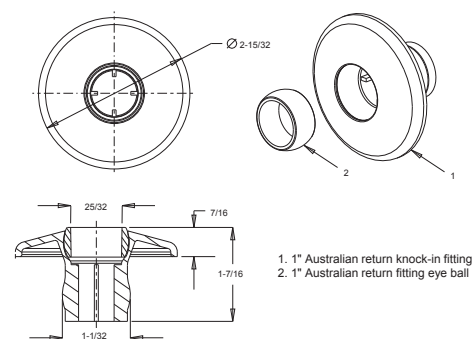

Three-Piece Directional Eyeball Fitting 1" Knock-In with Flange

FEATURES

Knocks into standard 1" pipe, no glue necessary
Self-leveling for out-of-square pipes
Adjustable eyeball available in four orifice sizes (1", ¾", ½", slotted)
Large flange camouflages pipe and surface construction variations
Manufactured from engineered polymer
UV-resistant ABS material
250 per case
Orifice size part #s: 1"-51xx, ¾"-52xx, ½"-53xx, slotted-54xx (i.e. 5201 = white ¾" orifice)

Part # 51xx, 52xx, 53xx, 54xx

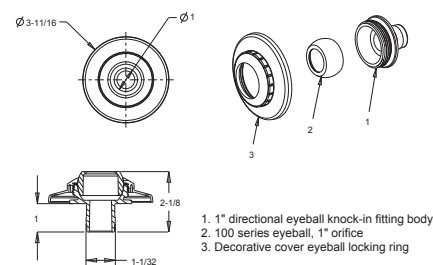

Rope Anchor

FEATURES

Sturdy center pin
Manufactured from engineered polymer UV-resistant ABS
200 per case

Part # 6xx

