

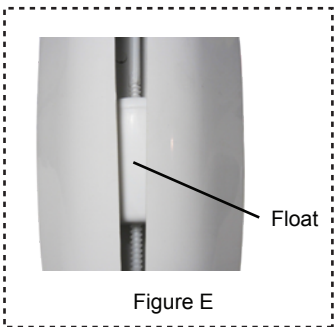

*For Aboveground Models with clamp, see other side first*

### Assembly Instructions:

1. Remove the top cover from the base. Take a flat head screwdriver wrap the tip in tape to be used to release the snaps if needed. Install the float housing onto the base by sliding the two tabs at the top of the float housing into the corresponding slots on the base. (Fig. A) Be sure the valve arm is resting on the upper flange of the float adjustment rod. (Fig. B)
2. **IMPORTANT:** Check tightness between hose connection and fill tube. If there is any visible gap, tighten with a 10mm allen wrench or attach garden hose and twist to tighten. (Fig C)
3. Ensure the fill tube is seated properly on the base. The groove on the fill tube should rest on the support in the center of the base. (See Fig. D) Then snap the top cover back onto the base.

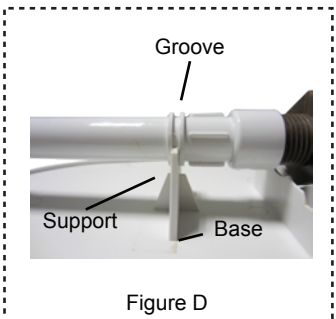
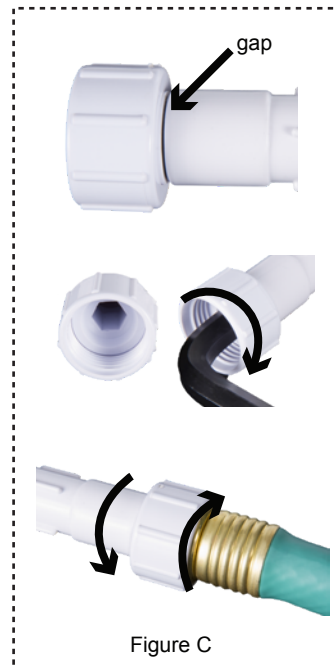
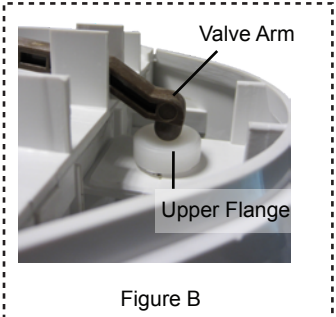
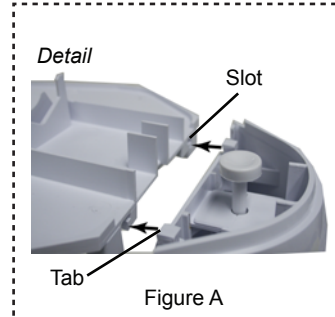

### Operation Instructions:

1. Attach garden hose to the hose connection on the fill tube.
2. Adjust the level of the float to the desired level by turning the threaded adjustment rod at the bottom of the float housing. The horizontal line on the float approximates where the water level of the pool will be maintained. (see Fig. E)
3. Adjust the rear leveling foot to the appropriate height. It is recommended that the unit tilt toward the pool slightly.
4. The unit is weighted. If more weight is necessary, weights such as rocks, can be placed inside the base to help stabilize the unit.

