

# Fastlane® Swim Steel Panel Vinyl Liner Pool Mounting Kit Supplemental Guide



## Description

The Wall Mount Fastlane® Swim mounting kit for a steel panel vinyl liner pool MUST be installed during the construction of the pool and prior to installing the vinyl liner. The mounting kit serves as a hanging system for the Current Unit and connection point for the PVC conduits that run under the pool deck to the remotely located Hydraulic Power Unit.

## Mounting Kit Parts Diagram

PART	QTY	DESCRIPTION
A	1	Mounting Bracket
B	2	Coupler
C	4	Jam Nut
D	2	Threaded Rod
E	2	Bonding Clamp
F	2	Liquid Tight Fitting
G	2	1-1/2" (38mm) x 1" (25mm) Bushing Reducer
H	2	Star Thru-Wall Faceplate
I	2	Star Thru-Wall Fitting
J	2	Star Thru-Wall Fitting Locknut
K	2	1-1/2" (38mm) FSlip x MPT Adapter
L	2	1-1/2" (38mm) PVC Pipe (supplied locally)
M	2	Threaded Stud
N	2	Rubber Washer
O	2	Flat Washer
P	2	Lock Washer
Q	2	Sacrificial Washer
R	2	Sacrificial Bolt

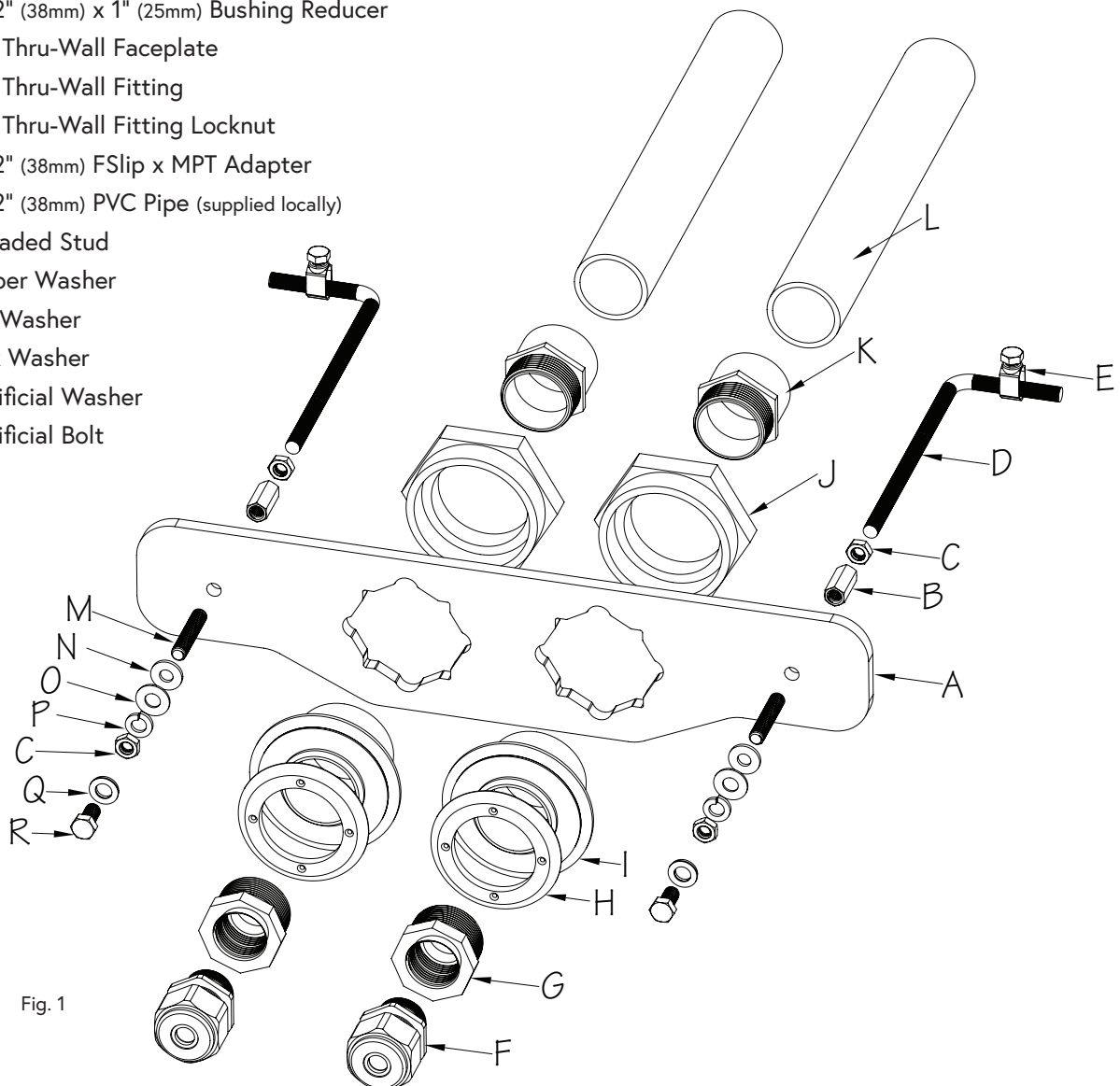

Fig. 1

## Installation Instructions

1. The Mounting Bracket (A) will serve as a template to trace the holes that need to be drilled into the steel pool wall in the desired Fastlane® Swim mounting location.

The template MUST be positioned so that the "Waterline" marking (B), engraved into the bracket, sits along the pool's expected waterline, which will typically be located at the centerline of the skimmer (C). Be sure that the template is level and use duct tape to temporarily adhere the template to the pool wall.

Mark the center points of the two Thru-Wall holes (D) and trace outlines of the two mounting holes (E). Use a 3" (76mm) hole saw to cut the holes for the Thru-Walls and a 3/8" (9,5mm) drill bit to drill the mounting holes (Fig. 2).

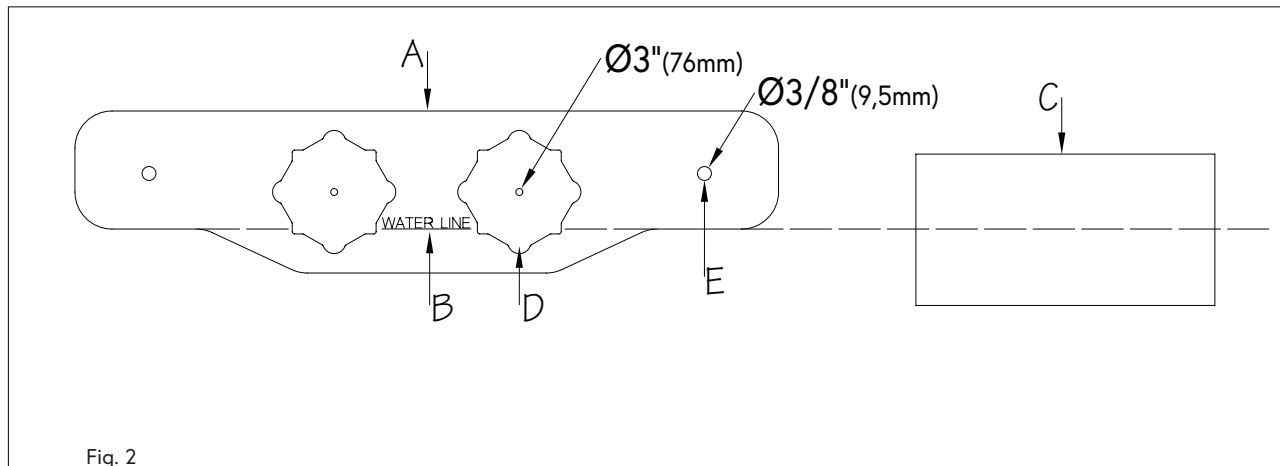

2. On the inside of the pool, insert the Star Thru-Wall Fittings (A) through the holes cut out in the pool wall, making sure the holes around the perimeter of the fitting are oriented in the 12, 3, 6, and 9 o'clock positions as shown.

Thread the Locknuts (B) onto the fittings from the backside of the pool wall. Apply Teflon tape or sealant to the threads of the FSlip x MPT Adapters (C) and then thread the Adapters into the Star Thru-Wall Fittings (Fig. 3).

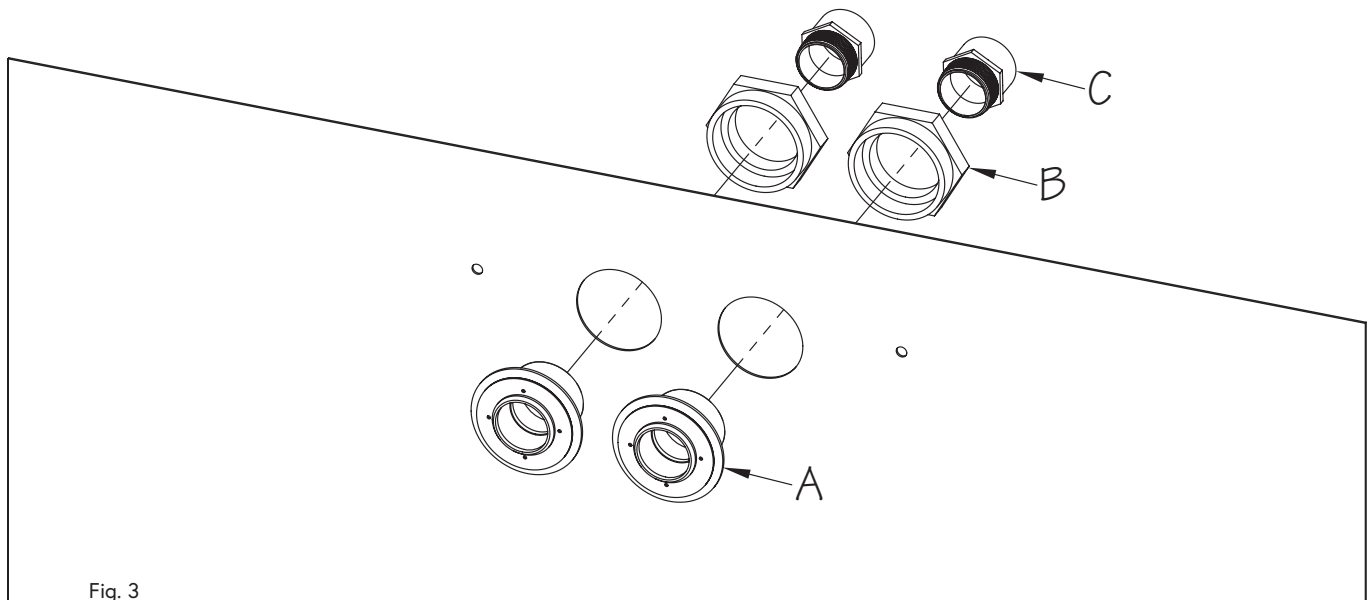

# Fastlane® Swim Steel Panel Vinyl Liner Pool Mounting Kit Supplemental Guide



3. Thread the Jam Nut (A) and Coupler (B) onto the Threaded Rod (C) so that the rod is inserted halfway into the Coupler. Align the Coupler and Threaded Rod with the mounting hole drilled into the pool wall. On the inside of the pool, insert the Sacrificial Bolt (D) through the hole and thread into the Coupler, making sure there is a Sacrificial Washer (E) between the bolt and pool wall (Fig. 4)

**NOTE:** The Sacrificial Washer is made of neoprene on one side and Stainless Steel on the other side. The steel side should face out.

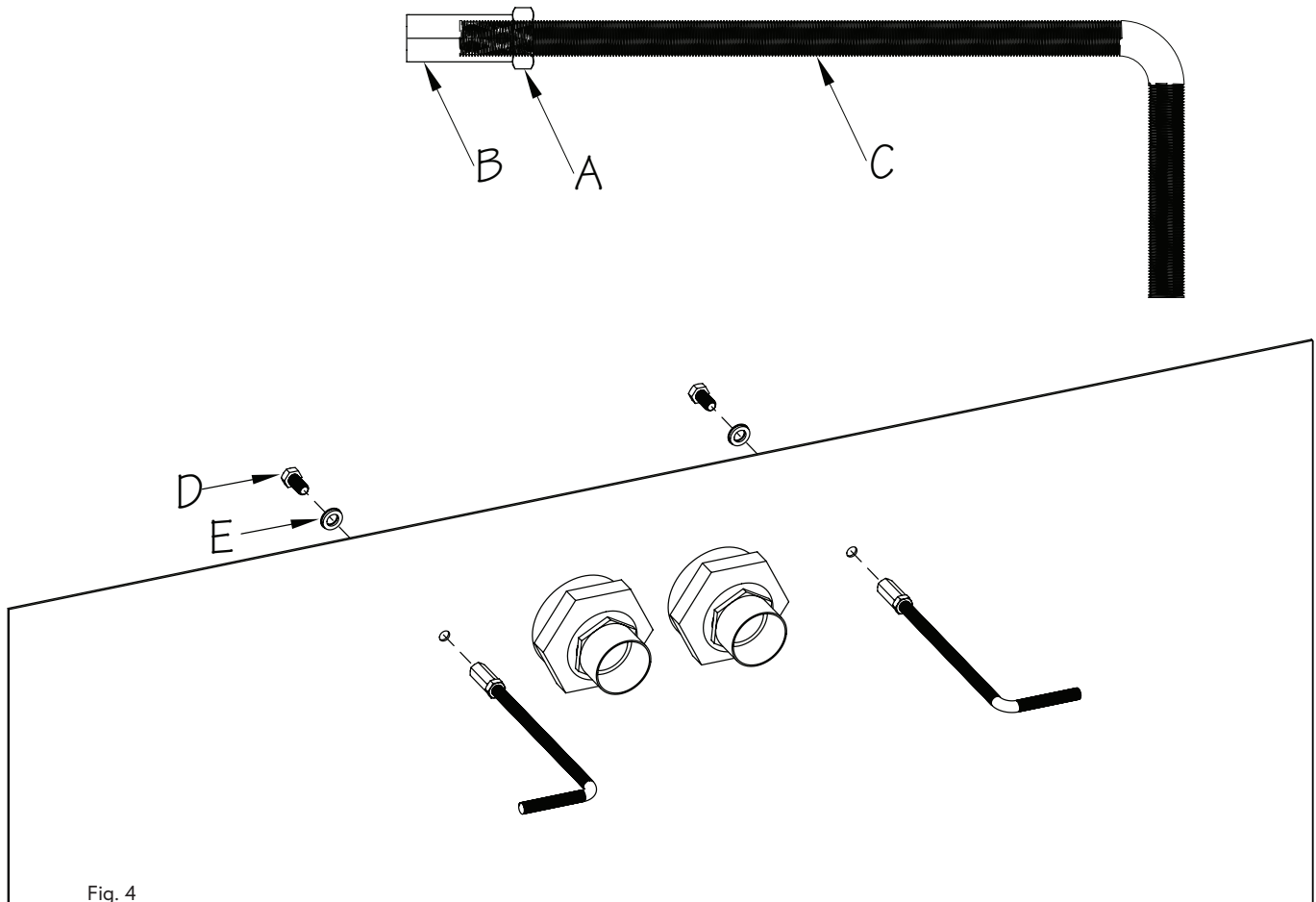

Fig. 4

# Fastlane® Swim Steel Panel Vinyl Liner Pool Mounting Kit Supplemental Guide



- The location of the Hydraulic Power Unit (A) should be determined at this point in the installation. Unroll the lengths of 1-1/2" (38mm) flexible PVC Pipe (B) from the back of the pool wall to the Hydraulic Power Unit. **The conduit run MUST travel above the pool's waterline.** Any bends in the pipe MUST be gradual sweeps and not sharp bends to allow the hydraulic hoses to be easily fed through each conduit. Glue the PVC Pipes into the adapters attached to the Star Thru-Wall Fittings (Fig. 5).

The Threaded Rods MUST be tied into the pool's bonding grid. Install a Bonding Clamp (C) onto each rod. Attach a #8 Solid Copper Wire (D) to each Bonding Clamp and then run these wires to a connection that is incorporated into the pool's bonding grid (Fig. 5).

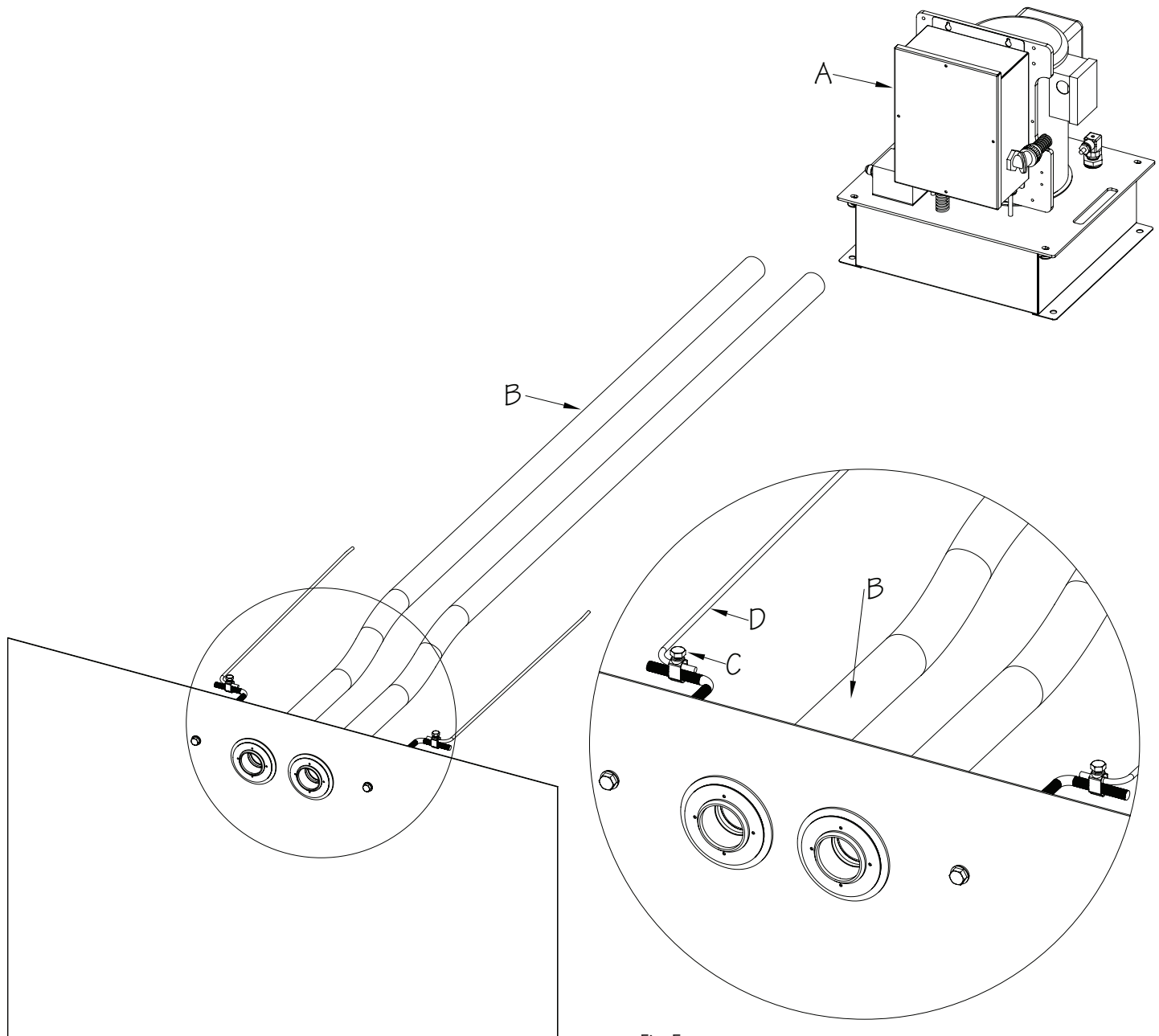

Fig. 5

# Fastlane® Swim Steel Panel Vinyl Liner Pool Mounting Kit Supplemental Guide



5. A Concrete Collar (A) is required to support the Current Unit. If using rebar in the pool's collar, tie the Threaded Rods (B) to the rebar grid using rebar ties. Prior to pouring the concrete, be sure that the openings of the Star Thru-Wall Fittings (C) and Sacrificial Bolts (D) are covered. Concrete cannot be embedded in these areas.

Pour the collar around the top flange of the pool, encasing the Threaded Rods (B) and PVC Pipe (E) in place (Fig. 6).

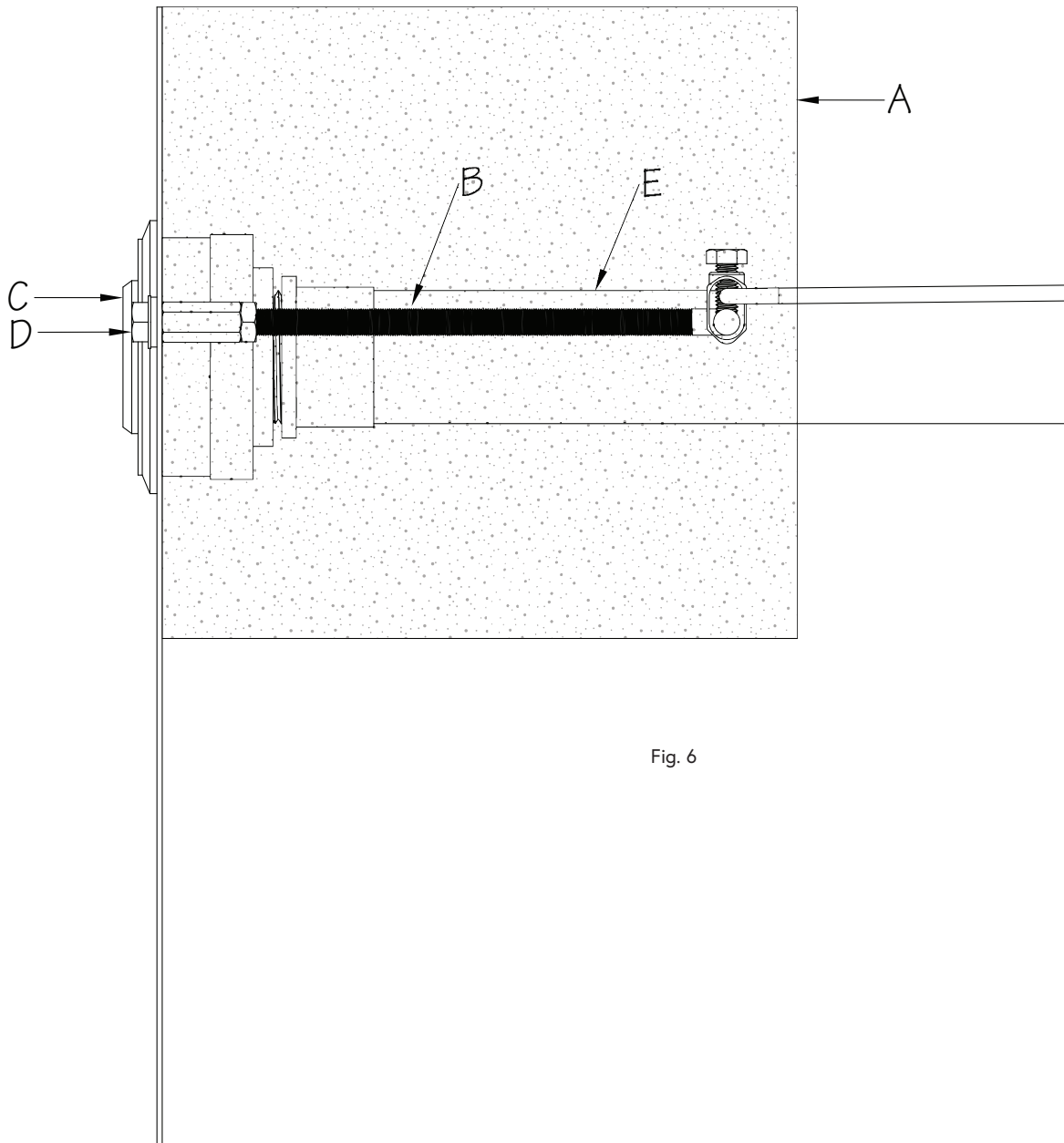
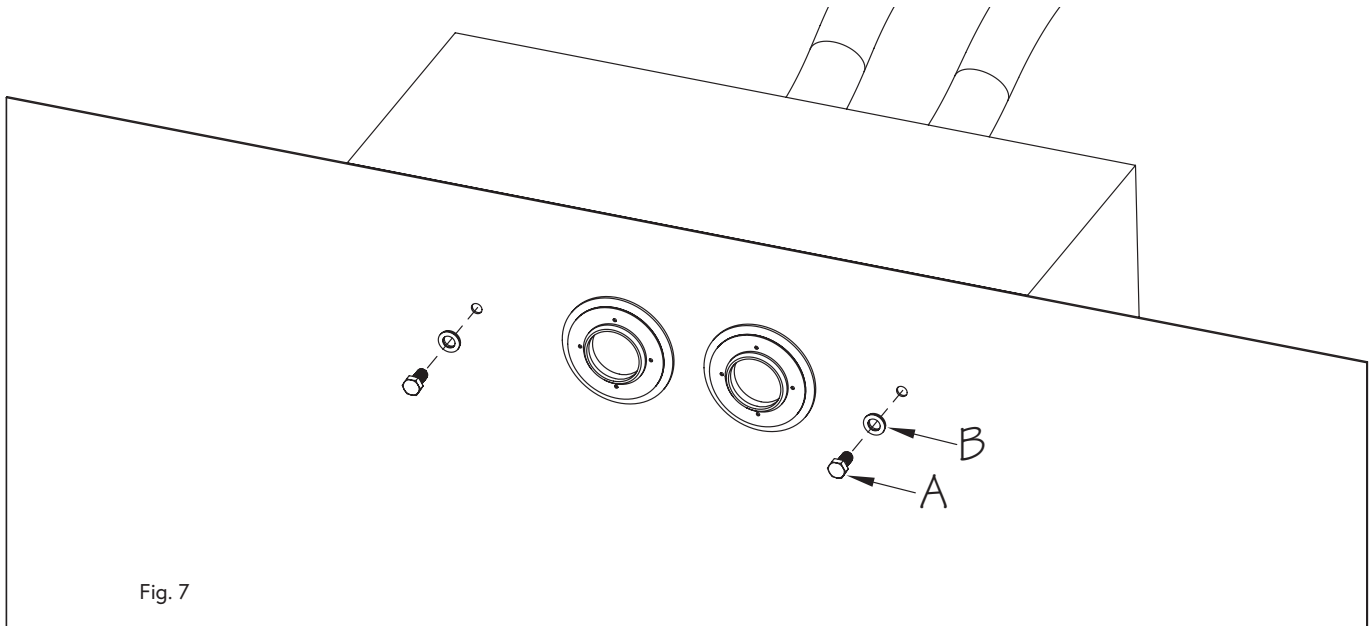

Fig. 6

# Fastlane® Swim Steel Panel Vinyl Liner Pool Mounting Kit Supplemental Guide



6. Remove the Sacrificial Bolts (A) and Washers (B) once the concrete fully cures (Fig. 7).



7. The pool Liner (A) should be installed at this time (Fig. 8).

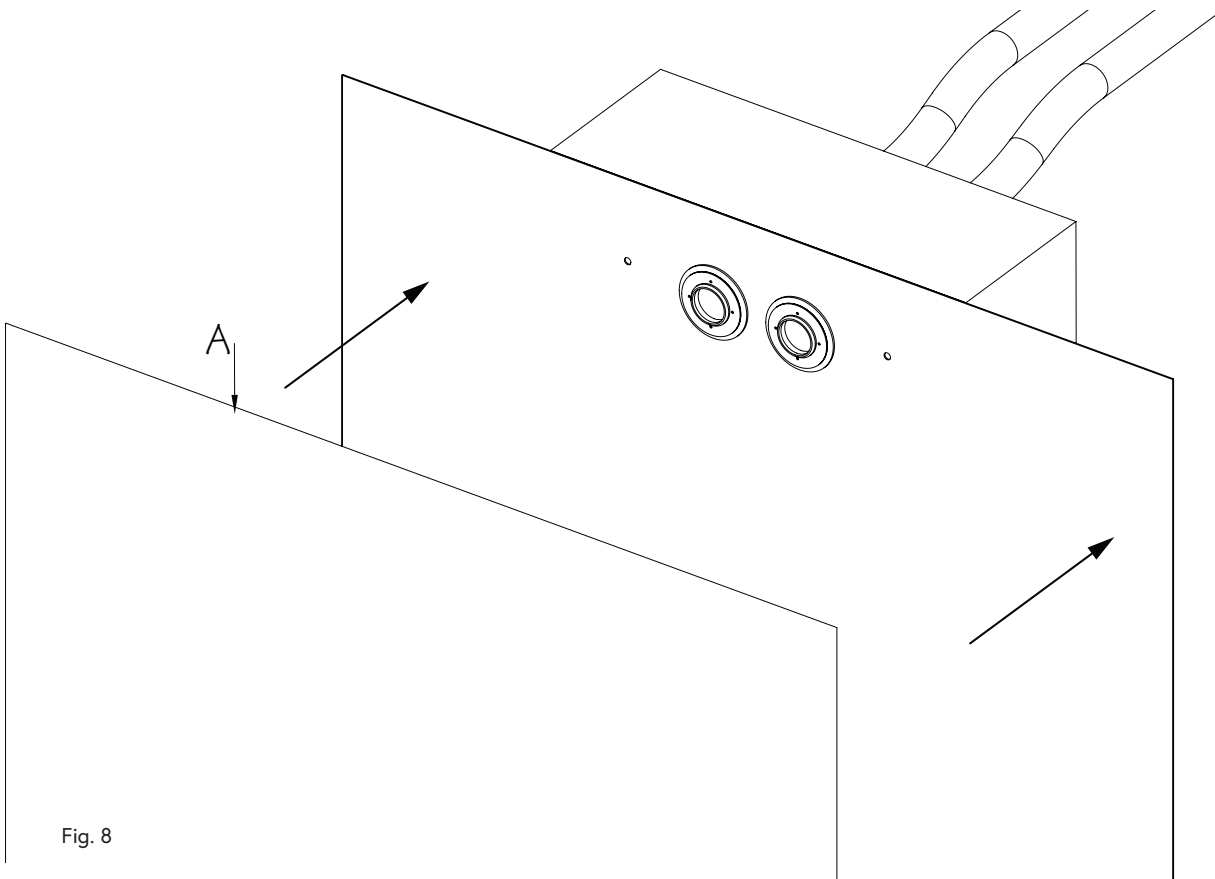

# Fastlane® Swim Steel Panel Vinyl Liner Pool Mounting Kit Supplemental Guide



8. Prior to cutting holes in the pool liner, water should be added to the pool to weigh down the liner.

Locate the Star Thru-Wall Fittings behind the liner. Position the Thru-Wall Faceplate (A) against the liner onto the fitting, making sure the holes in the Faceplate are aligned with the holes in the fitting. Use a scratch awl to poke out the (4) holes in the liner (B). Secure the Faceplate to the fitting with the Faceplate Screws (C). Use a hand screwdriver when installing screws to avoid cracking the Faceplate.

Once the Faceplates are installed, use a sharp utility knife to cut out the round holes in the liner (D) using the inside of the Faceplate as a template (Fig. 9).

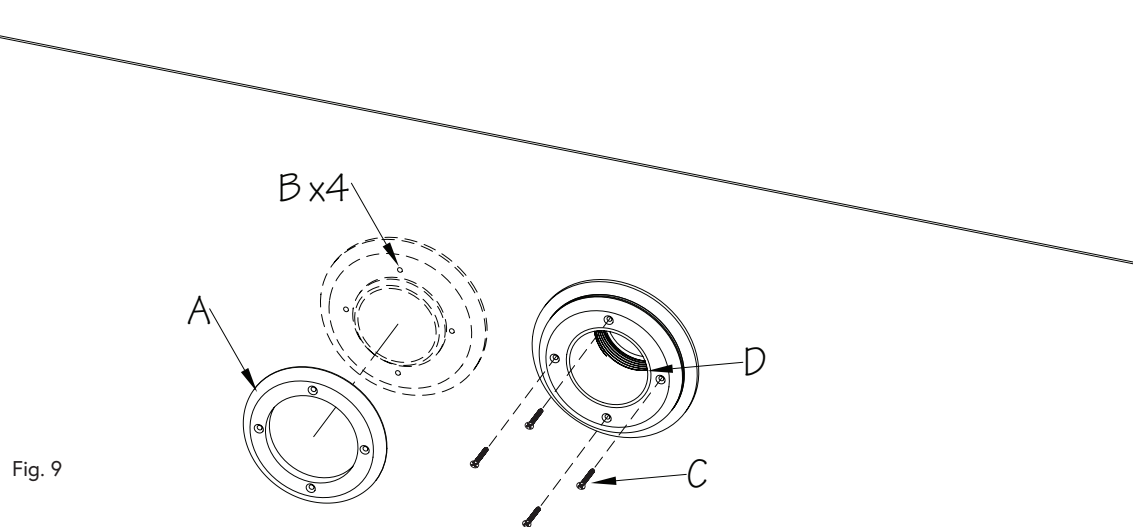

Fig. 9

9. Remove the Faceplates (A) after the holes have been cut in the liner. Spread a thin layer of silicone on the face of the black gasket (B) that is adhered to the Star Thru-Wall Fitting (behind the liner). Spread a thin layer of silicone on the back of the Faceplate (C). Re-attach the Faceplate and allow the silicone to cure (Fig. 10).

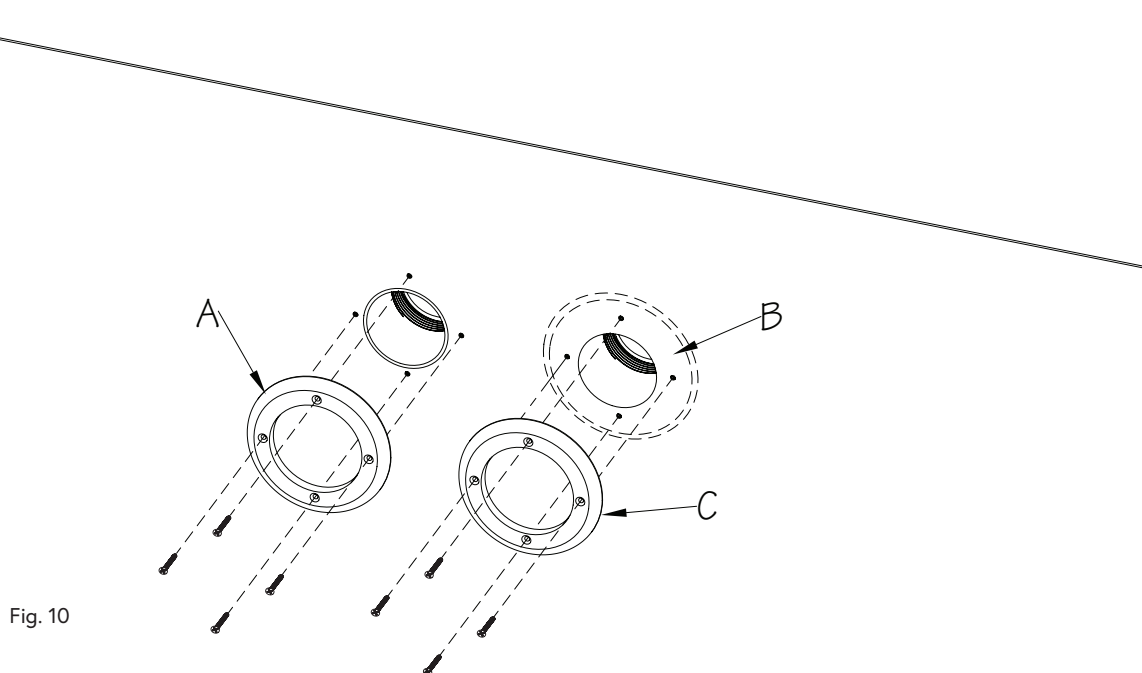

Fig. 10

# Fastlane® Swim Steel Panel Vinyl Liner Pool Mounting Kit Supplemental Guide



10. Locate the mounting holes (A) drilled into the pool wall (behind the liner). Use a sharp utility knife to cut out the round holes in the liner using the mounting holes as a template.

Thread the Stud (B) into the Coupler so that  $1\text{-}1/4" \pm 1/8"$  ( $32\text{mm} \pm 3\text{mm}$ ) of the stud is protruding into the pool. Spread a thin bead of silicone on the face of the Rubber Washer (C) and then install the washer over the Stud, adhering to the liner (Fig. 11).

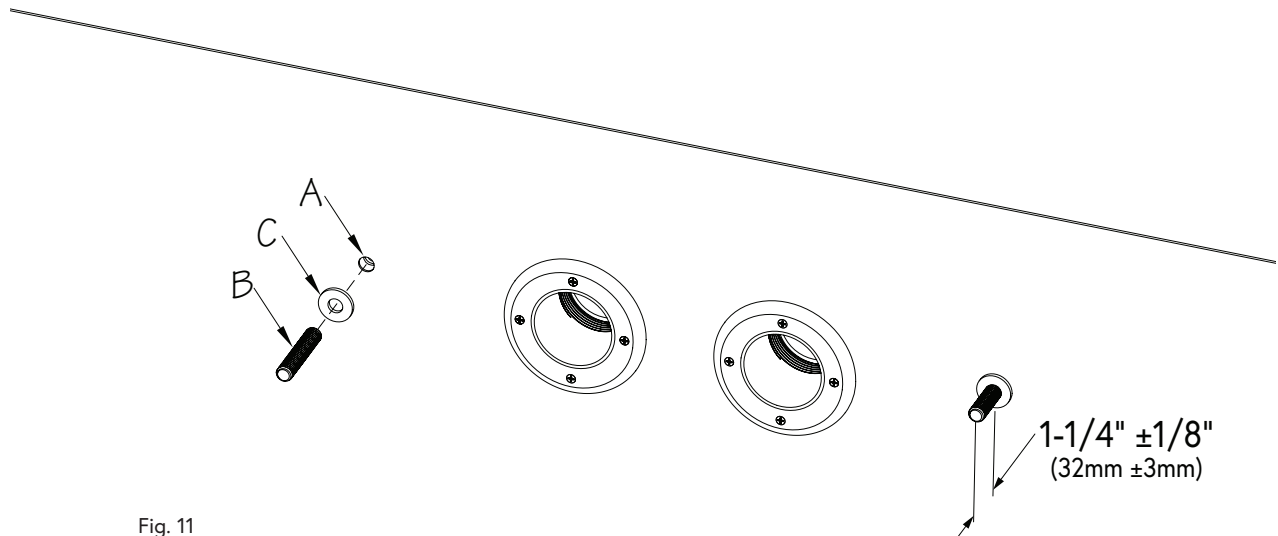

Fig. 11

11. Apply Teflon sealant to the threads of each Bushing Reducer (A) and then thread them into the Star Thru-Wall Fittings (B) (Fig. 12).

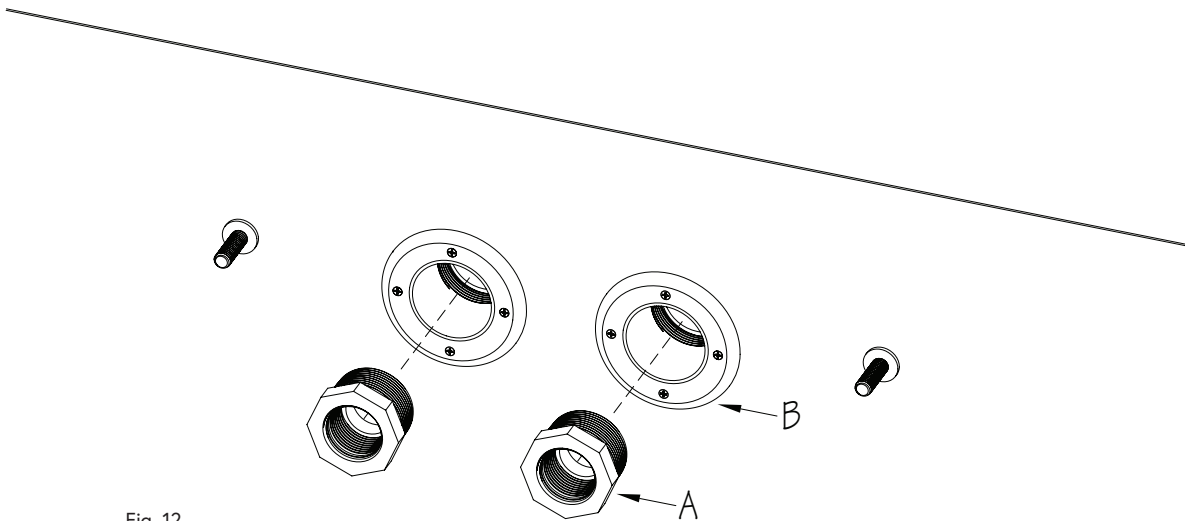

Fig. 12

12. The remaining mounting kit components will be installed when the Current Unit is being mounted to the pool wall. Refer to the Fastlane® Swim Owner's Manual for the assembly and installation of the Current Unit.