

30" FLOOR MOUNT TABLE

- Lightweight, easy to move
- Mount into pool floor
- Includes 54" marine grade stainless steel support pole (may be cut to custom length)
- Rotomolded tabletop
- Optional stainless steel frame umbrella
- Salt water friendly

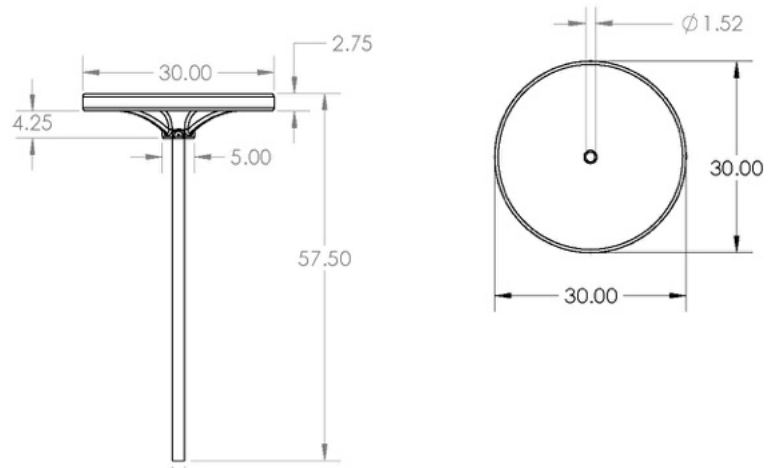

Color Options



Granite Grey



Granite Sandstone



White

*Actual colors may vary

PART NUMBER	DESCRIPTION
GPP-LF-TTUP-G	30" Floor Mount Table - Grey
GPP-LF-TTUP-S	30" Floor Mount Table - Sand
GPP-LF-TTUP-W	30" Floor Mount Table - White
GPP-LF-ANC-G	Gunite Anchor
GPP-LF-ANC-V	Vinyl Anchor

To include optional umbrella (blue), add "-U" to the end of the part number.

Anchor not included.

