



INSTALLATION MANUAL



VIDEO: gatorsa.co.za/installation

STEP 1: PREPARING YOUR FILTRATION SYSTEM

1. Ensure that pump is switched off.
2. Empty the weir leaf basket
3. Empty the pump leaf basket
4. Carry out backwash procedure

STEP 2: IDENTIFY AND REPLACE WEIR REGULATOR

Your weir regulator valve will look similar to:



Replace your weir regulator valve with the
CONNECTOR (part GA13):

STEP 3: CHECK PUMP EFFICIENCY

Attach one section of hose to the CONNECTOR, and insert the GATORGUAGE, (part no.GA14) into the other end of the hose. Ensure that GATORGUAGE is below water surface. Switch pump on and observe the reading after about 30 seconds.

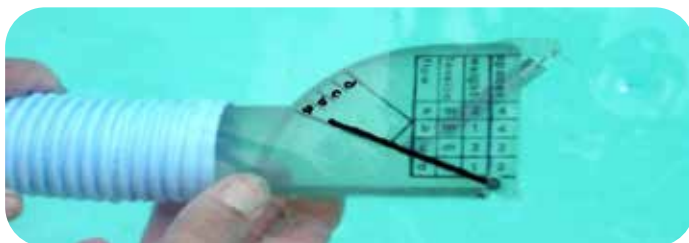

STEP 4: SET GATOR ADJUSTMENTS

The GUAGE will register an **a**, **b**, **c**, or **d** reading. An **a** reading shows excellent suction and a **d** reading very poor suction.

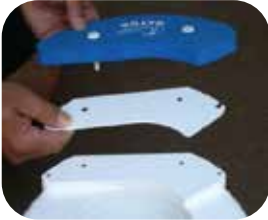

a or b reading:

Assemble with SPACERS (part GA5)

c reading: Assemble floats without SPACERS

IMPORTANT: A **d** reading shows an *inadequate* flow of water and therefore a poorly functioning pump and filter system that needs to be attended to before you can install your GATOR.

The TENSION PLATE (part GA2) is set in the factory to **medium**. It shouldn't be necessary to change this setting. However, should you wish to experiment, the following is applicable: A **higher** setting **increases** the speed of your pool cleaner, and **decreases** the volume of water entering GATOR. A **Low** setting will have the opposite effect.



STEP 5: INSTALLATION

Separate your hose 2 sections from your automatic pool cleaner (3 for deep pools). Take your GATOR and insert the end with the FLOW direction arrow facing toward the weir.



STEP 5: INSTALLATION CONTINUED

VERY IMPORTANT: installing GATOR in the **wrong** direction could cause damage to your pump.

Allow the GATOR to fill with water by turning on its side, then allow it to float level. Your GATOR is now fully installed! Switch the pool pump on. The GATOR should start operating normally, and will begin floating randomly over the water surface, removing surface debris as it moves along. Should any problems be encountered, please refer to the “Troubleshooting”.



PARTS IDENTIFICATION

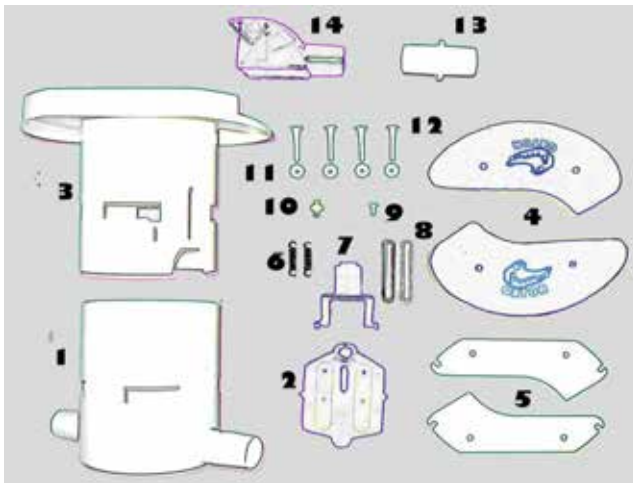

No.	Description	Qty
GA1	Outer Cylinder	1
GA2	Tension Plate	1
GA3	Inner Cylinder	1
GA4	Float	2
GA5	Spacer	2
GA6	Spring	2
GA7	Flap Valve	1
GA8	Lead Ballast	2
GA9	Short Screw	1
GA10	Push Rivet	1
GA11	Thumb Nut	4
GA12	Float Screw	4
GA13	CONNECTOR	1
GA14	GATOR GUAGE	1

www.gatorsa.co.za South Africa email: info@gatorsa.co.za

United States: gatorAutoskim@OnlyAboutInnovation.com Tel: +1-866-875-4607

Australia: newline@newlineproducts.com.au Tel: 1300 677 100



OPTIONAL GATOR INSTALLATION

**For times you wish to remove surface debris quickly
and wish to disengage your automatic pool cleaner**

STEP 1:

Turn off your pool pump. Connect the CAP ADAPTER to the INPUT connector of the Gator. Arrow indicates this part.



STEP 2:

Connect one or two sections of hose to the other side of the gator. Return to pool and install as per normal Gator installation

www.gatorsa.co.za

South Africa email: info@gatorsa.co.za

United States:

gatorAutoskim@OnlyAboutInnovation.com

Australia: newline@newlineproducts.com.au



ADDITIONAL INFORMATION FOR AMERICAN CUSTOMERS WITH 1 ¼" POOL HOSE

Note for American customers: Some of the hoses sold in the United States are smaller than the standard i.e. 1 ¼ inches. The Female-to-Female (Universal) adapter is supplied to secure the connection in this instance. Arrow indicates this part.

STEP 1:

Connect the FEMALE end of the pool hose to the FLOW OUT.

STEP 2:

Connect the Male end of the pool hose using the FEMALE TO FEMALE (Universal) adapter.

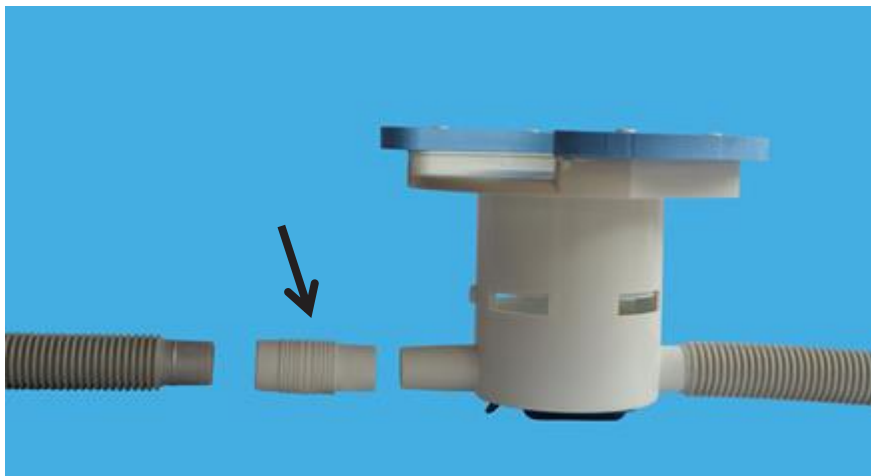

www.gatorsa.co.za

South Africa email: info@gatorsa.co.za

United States: gatorAutoskim@OnlyAboutInnovation.com

Australia: newline@newlineproducts.com.au

GENERAL MAINTENANCE

While the GATOR is designed to reduce pool maintenance time, maintenance of your entire pool system should be completed for optimum GATOR performance.

Important: Switch the pool pump off before carrying out cleaning procedures.

1. Empty leaf baskets frequently
2. Backwash the filter regularly.
3. Check the GATOR for: a) leaves trapped in the flap valve area and b) easy movement of inner and outer cylinders.
4. Periodically use the GATORGUAGE to ensure that no leaks or faults have developed in your pump/ filter system.

TROUBLESHOOTING

Problem: GATOR is sluggish or does not operate at all.

Solution: 1. Check that CONNECTOR is substituted for your weir regulator valve.

2. Check that weir and pump baskets are clean.
3. Backwash the filter.
4. Check that vacuum lid is flush in the weir.
5. Check that water flow direction through GATOR is correct.
6. Check that aim flow(s) is not restricting return water flow.
(E.g. a wall mounted leaf skimmer would create this problem).
7. Increase the tension on the TENSION PLATE on GATOR.

Problem: Surface water enters GATOR too slowly.

Solution: 1. Refer to items 1—4 above.

2. Decrease the tension on TENSION PLATE on GATOR.
3. Add an extra float spacer to each side.

Problem: GATOR rises up out of the water and takes in air.

Solution: 1. Increase the tension on TENSION PLATE.

2. Add one float spacer to each side.
3. Check that inner and outer cylinders move easily in relation to each other. If not, remove the slide stop rivet (part no. GA8), separate the cylinders, rinse off any debris and reassemble.

Problem: Automatic Pool cleaner hose curls up or tangles around GATOR.

Solution: 1. Move GATOR 1 or 2 hose sections closer to the pool pump.

2. Ensure that hoses are not twisted when attaching GATOR.

Problem: Automatic Pool Cleaner moves in a fixed pattern.

Solution: 1. Adjust the return outlet (airflow) towards the bottom of the pool.

2. Ensure that hose lengths are in good condition
3. Pool hose may be too short. Add more lengths of hose.
4. Consult your automatic pool cleaner instruction manual.



WARRANTY: The GATOR Autoskim is warranted to be free of defects in materials and workmanship for a period of one year from date of purchase. The warranty expressly excludes any failure due to improper installation, abuse or lack of reasonable maintenance. In no event will GatorSA (Pty) Ltd or Only About Innovations LLC be held liable for incidental or consequential damages to person or property.