

Roller Shutter Installation Instructions

[Internal Installation]

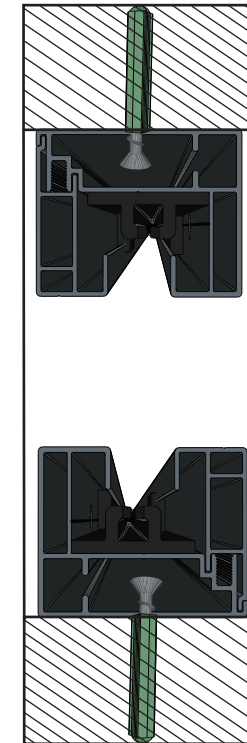
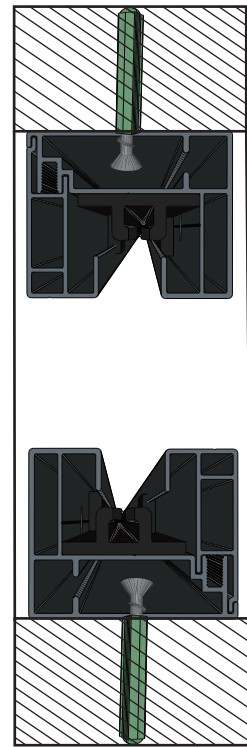

【Internal Installation】 : The roller curtain is mounted inside the frame and secured from the back of the track.

Any technical problems encountered in the installation process should first consult the manufacturer's technical personnel, if the private replacement, damage to the product structure or installation of any accessories, equipment, etc., resulting in the product can not work properly, the manufacturer will not be responsible for the after-sales problems caused!

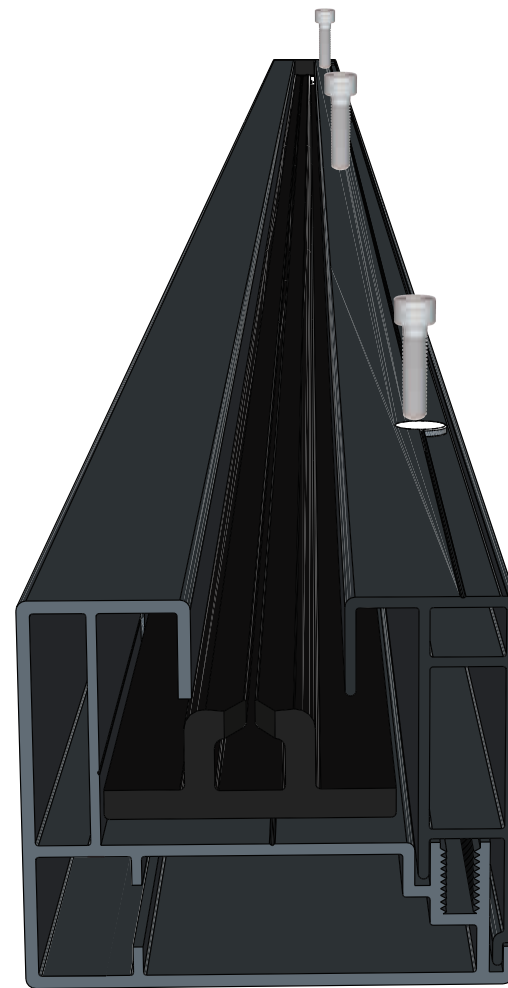
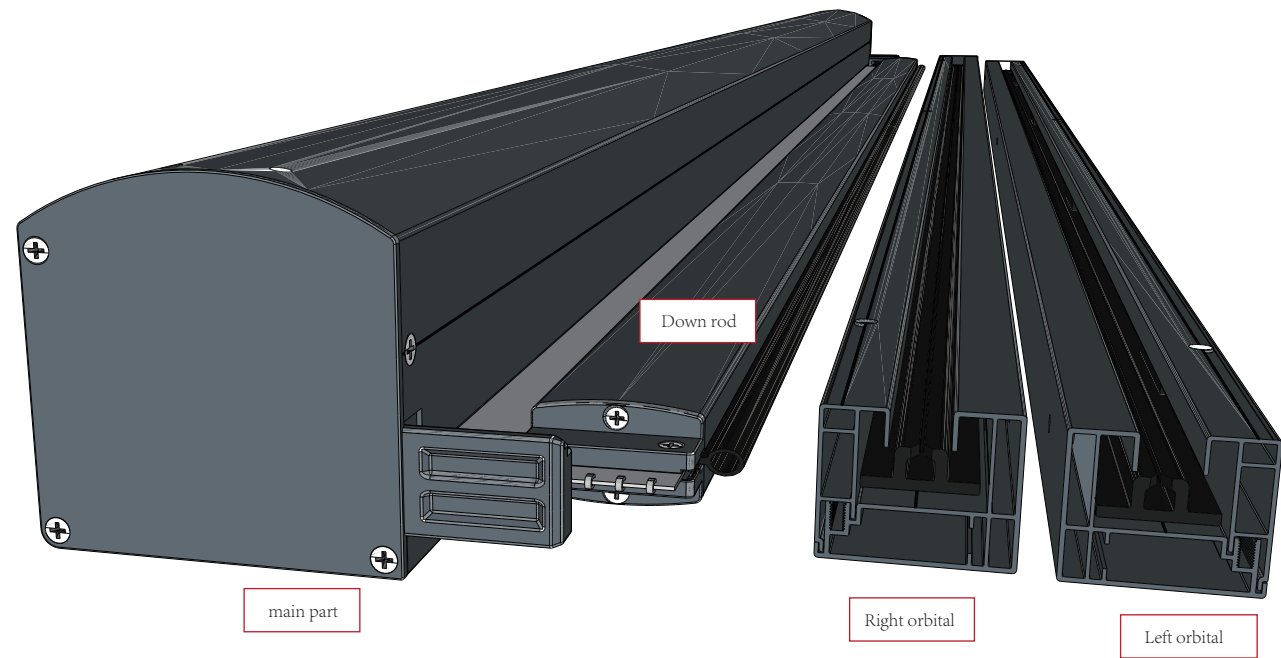

02

Disassemble the track and divide the track into **【upper track】** , **【lower track】** and **【plastic track】** .



①

Remove the plug, put it away, and then reinstall it.

②

Remove the connecting screws of the track.

③

Disassemble the track and divide the track into **【upper track】** , **【lower track】** and **【plastic track】** .

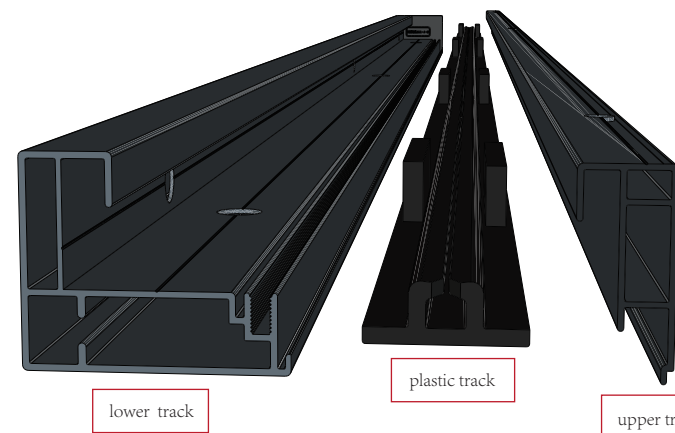

03

Use a laser level to measure the level and verticality of the installation surface, ensure that the installation surface is straight around, and determine the installation height.

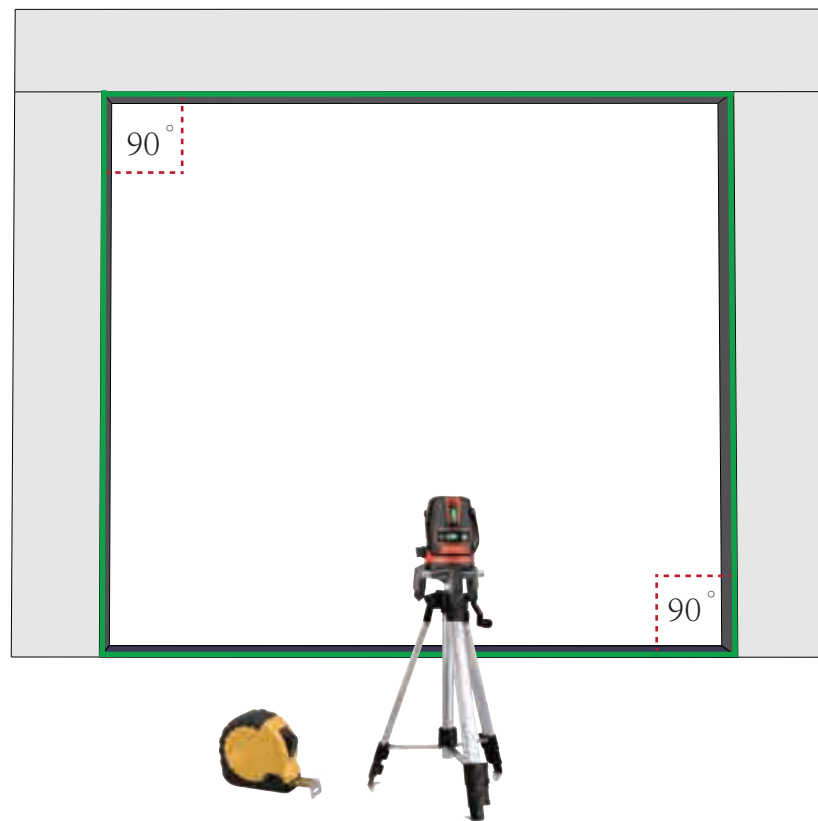

Attention:

Conventional internal installation, default to fill the entire frame: from bottom to top; If it is not installed from the bottom to the top, it is necessary to mark the installation height and ensure that the left and right rails are in the same horizontal plane.

04

Place the lower track on the mounting surface and mark the vertical direction position according to the laser line; Then use a marker to mark the location of the expansion screws on the wall through the fixing holes on the lower track.

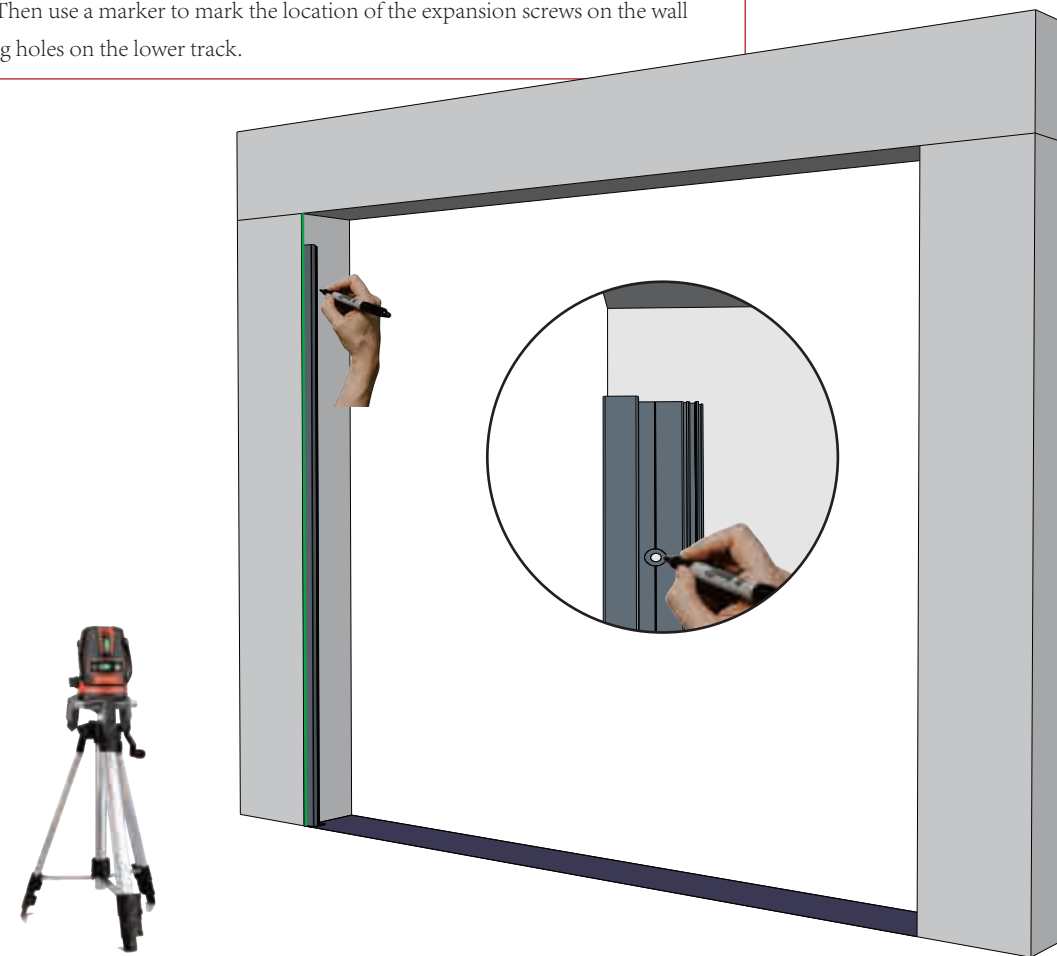

05

Use a hammer drill to drill holes in the marked positions, insert the screw rubber sleeve into the holes, and complete the positioning of the mounting holes on the left and right rails in the same operation.

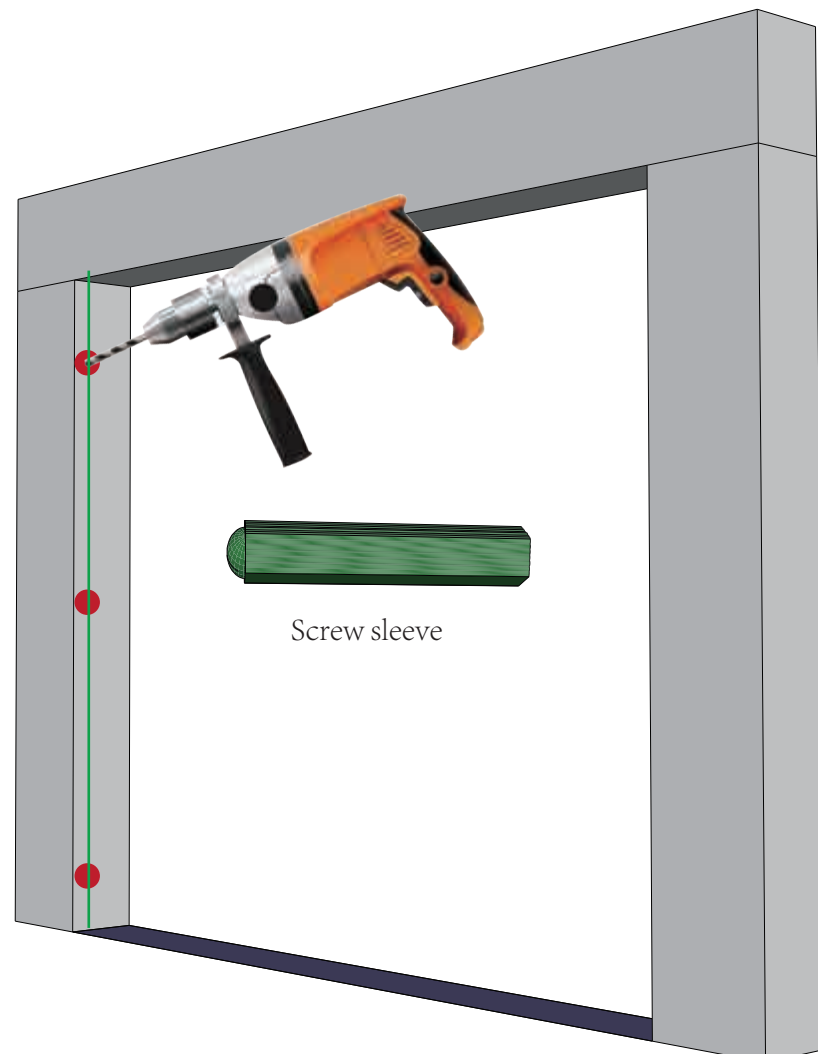

06

The main body of the cover shell of the rolling curtain is assembled with the left and right lower track, and the two end cover brackets are inserted into the card slots of the lower track.

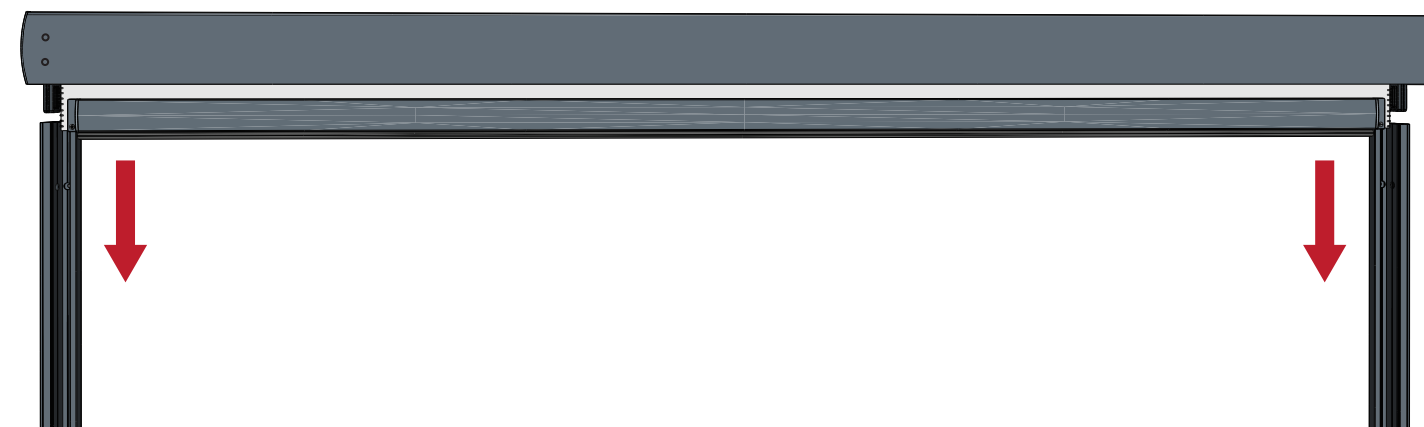
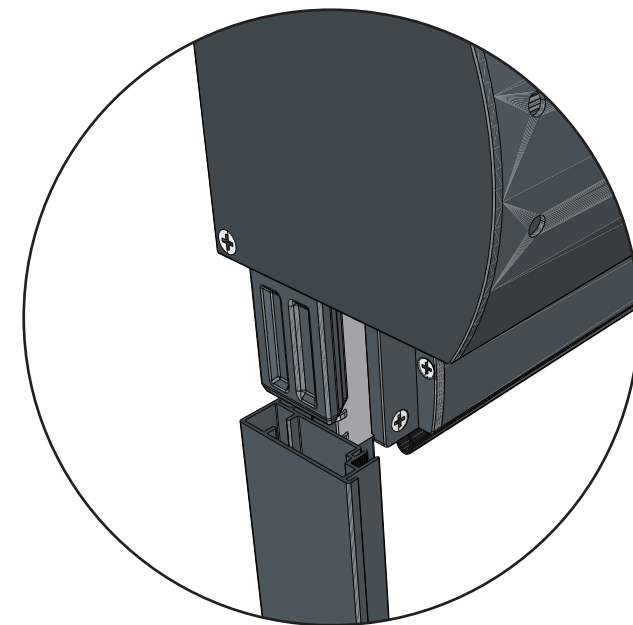

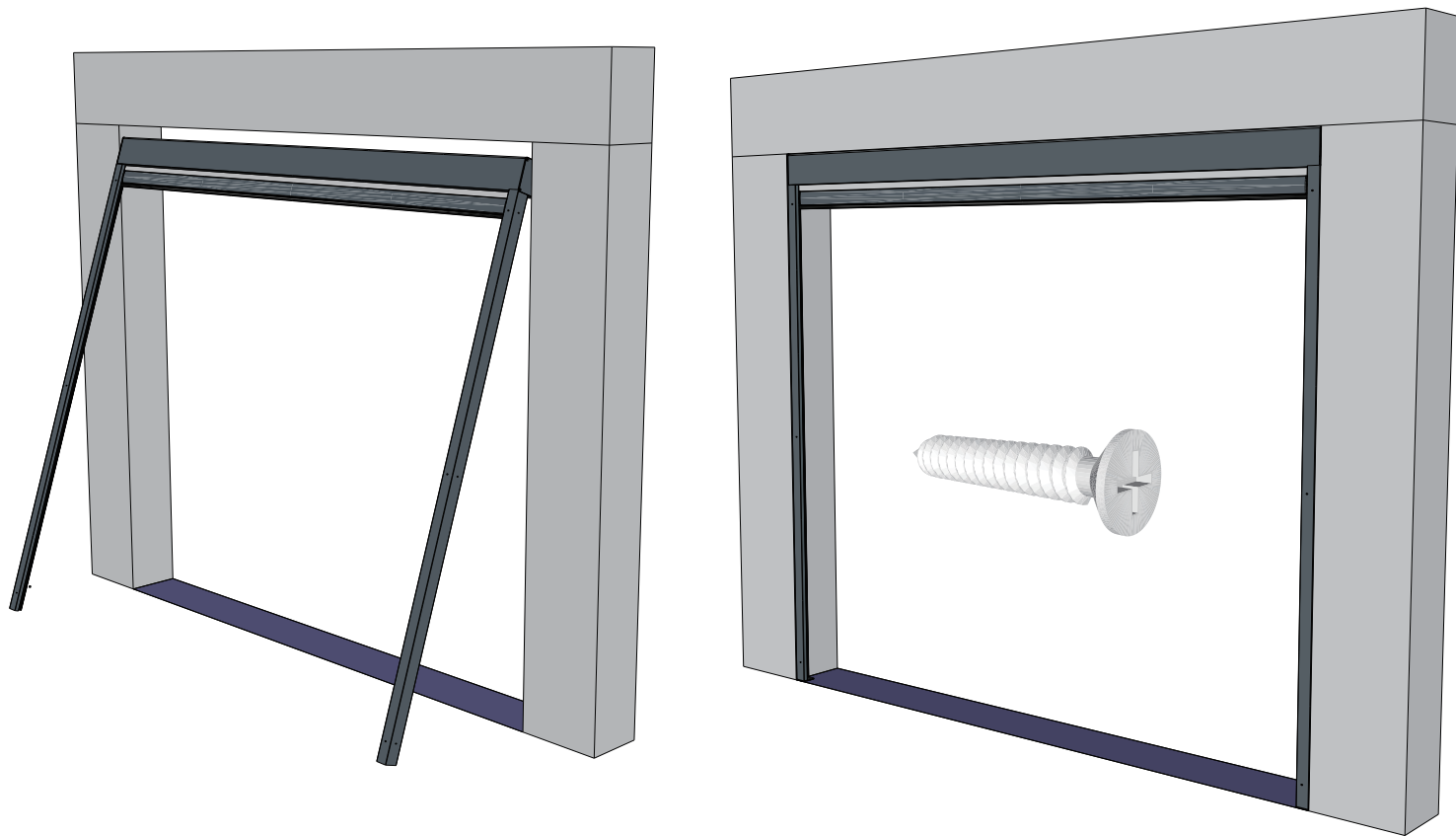

07

Two or more people at the same time, roll the curtain sideways into the frame, and then slowly straighten until the curtain and the track fit into the frame, and then screw the track.

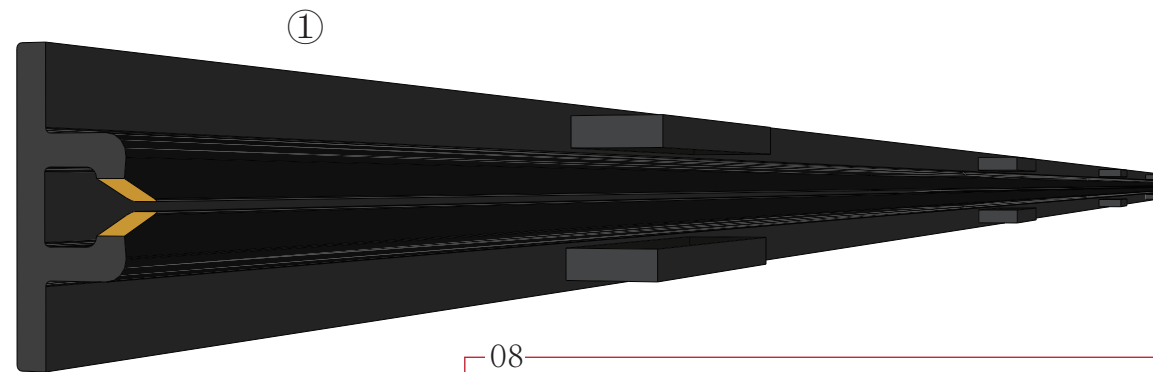

①

08

Take out the plastic track, with the end of the triangular opening facing up, and insert the roller curtain from the direction of the triangular opening.

②

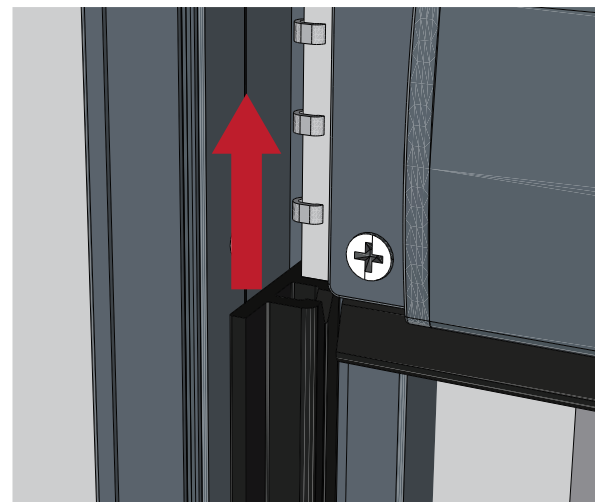

③

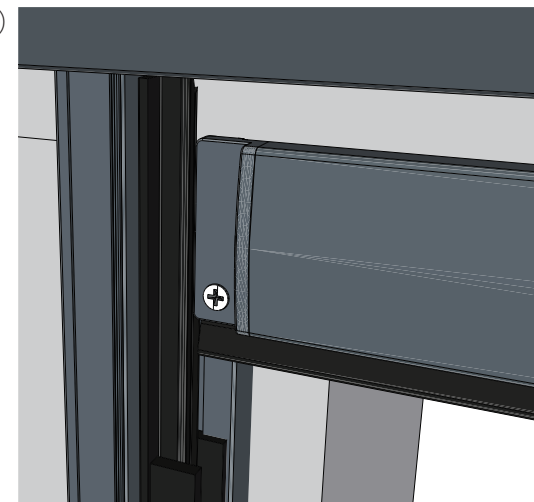

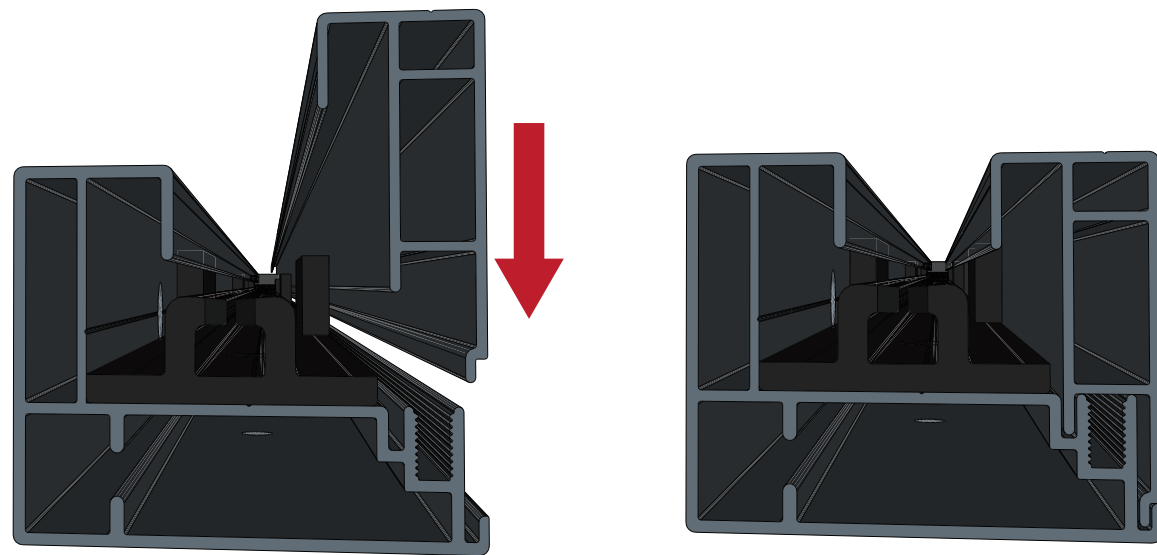

09

Take out the corresponding upper track, install it separately, assemble the complete track, pay attention to the assembly of the track should check whether the sponge on the plastic track is completely stuffed into the track, finally tighten the track screw, and plug back the rubber plug, complete the installation.

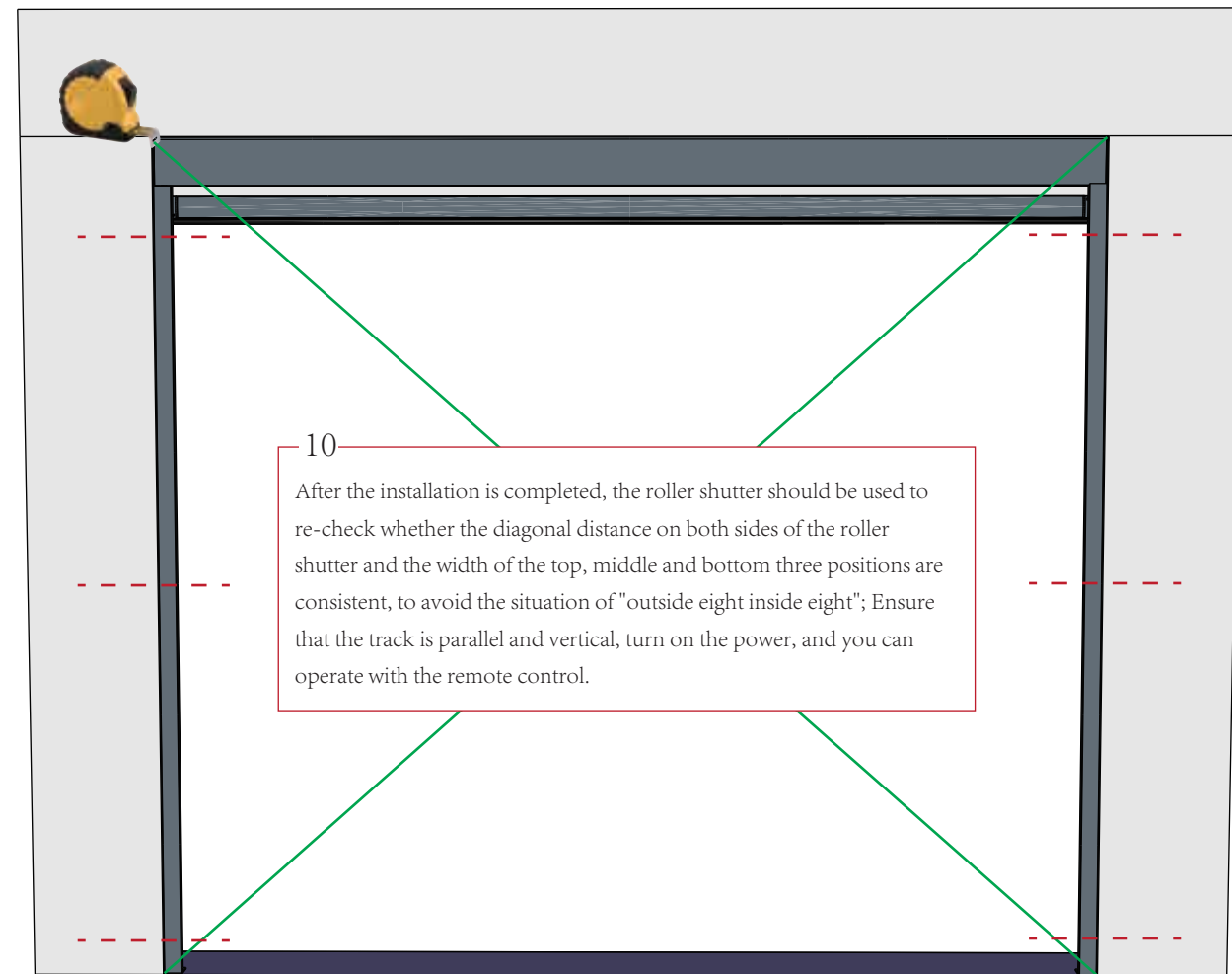

10

After the installation is completed, the roller shutter should be used to re-check whether the diagonal distance on both sides of the roller shutter and the width of the top, middle and bottom three positions are consistent, to avoid the situation of "outside eight inside eight"; Ensure that the track is parallel and vertical, turn on the power, and you can operate with the remote control.