

PS ULTRA / PRO-SPRAY™

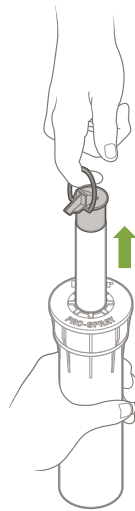

1

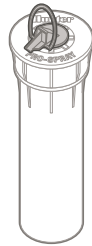

2

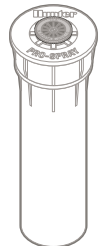
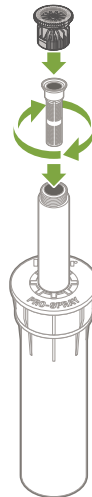
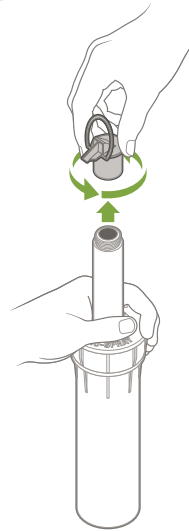

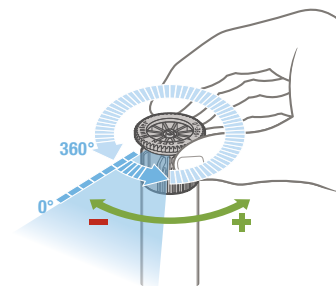
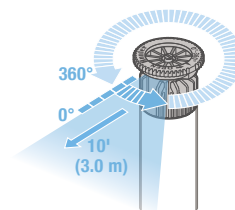
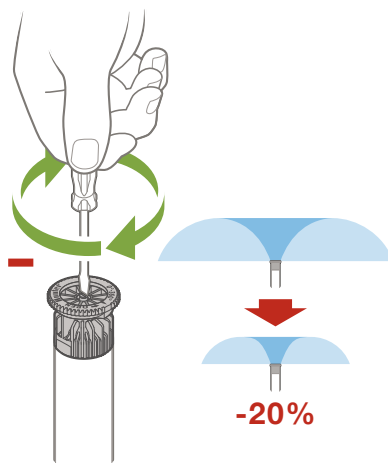
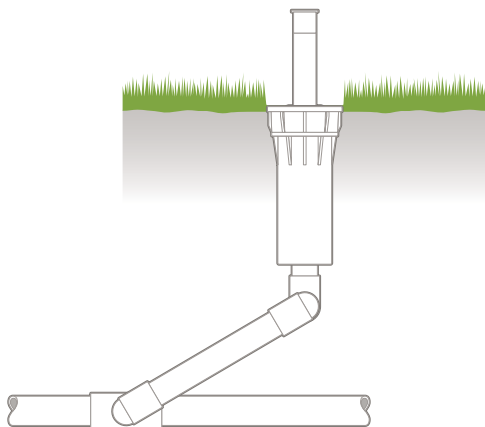

8A-HE

1.0 to 3.0 bar
100 to 300 kPa
20 to 40 PSI

0.87 to 5.50 l/m
0.23 to 1.36 GPM

2.0 m to 2.8 m
(7' to 9')

10A-HE

1.0 to 3.0 bar
100 to 300 kPa
20 to 40 PSI

1.36 to 7.57 l/m
0.36 to 2.00 GPM

2.7 m to 3.2 m
(9' to 10')

12A-HE

1.0 to 3.0 bar
100 to 300 kPa
20 to 40 PSI

2.01 to 11.05 l/m
0.53 to 2.92 GPM

3.3 m to 3.9 m
(11' to 12')

15A-HE

1.0 to 3.0 bar
100 to 300 kPa
20 to 40 PSI

2.95 to 16.78 l/m
0.78 to 4.43 GPM

4.2 m to 4.8 m
(14' to 15')



17A-HE



1.0 to 3.0 bar
100 to 300 kPa
20 to 40 PSI



3.61 to 20.06 l/m
0.95 to 5.30 GPM



SS-530



1.0 to 3.0 bar
100 to 300 kPa
20 to 40 PSI



3.5 to 5.7 l/m
1.1 to 1.5 GPM

