

Cast Iron Cable Weight

Part Number: 7039

QSG00078_Rev04_Cast Iron Cable Weight | May 14, 2024 8:05 PM



QUICK START GUIDE

1. The cable weight consists of two halves, remove the two screws until they release from the screw holes and pull directly away (Fig. 1).
2. Determine desired activation level, place the float switch cable in the cable slot on the bottom half, and tether to appropriate length (Fig. 2).
Note(*): Correct installation position, narrow end of the cable weight up.
3. Secure float switch cable by aligning the screw holes and tighten so both halves of the cable weight are snug against the cable. (Fig. 3). Perform a pull test, if the float switch cable slips, tighten the screws until securely fastened to prevent slipping.
4. Suspend float switch with cable weight at the determined activation level using a mounted float bracket or per local codes (Fig. 4).
5. Wire the float switch cable per manufacturer's instructions.
6. Check installation by cycling the float on and off to ensure proper system operation.

(Fig. 1)

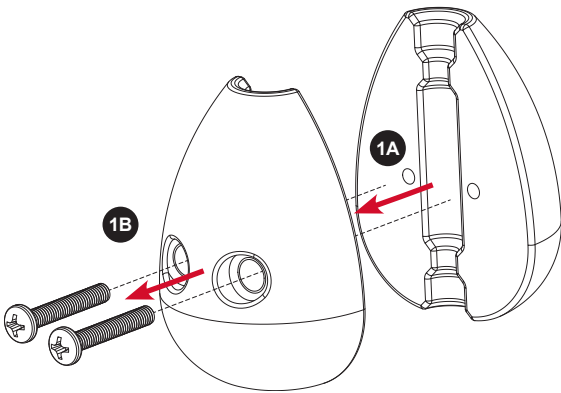

(Fig. 2)

Control Switches (Narrow Angle)

Minimum recommended tether length is 6 inches

Pump Switches (Wide Angle)

Minimum recommended tether length is 6 inches

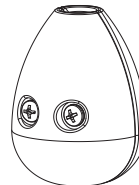

(*) Correct installation position
example, narrow end up.

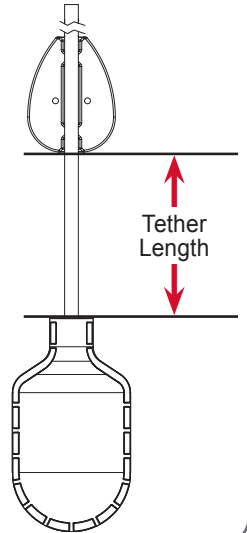

(Fig. 3)

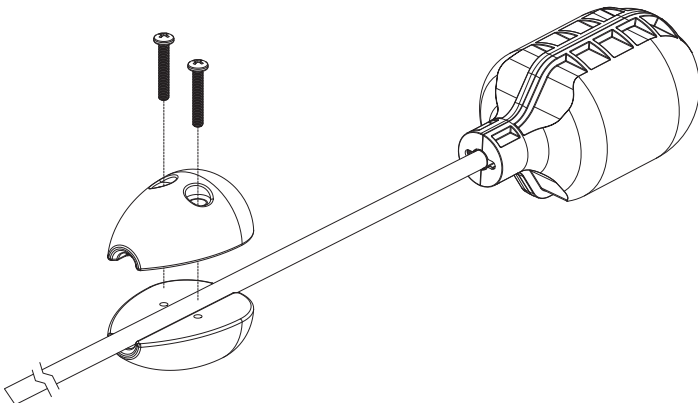

(Fig. 4)

