

JCP COMMERCIAL
POLYMER PUMPS



Jandy®

JCP COMMERCIAL POLYMER PUMPS



OFFICIAL
POOL
EQUIPMENT
SUPPLIER



JCP
COMMERCIAL POLYMER PUMP

Engineered From The Ground Up For Commercial Pools

Jandy JCP Commercial Polymer Pumps deliver a robust, adaptable platform with 3–15 HP and 1-phase or 3-phase power. Available in standard or specialized waterfall models, they drop in seamlessly to replace Pentair® EQ and C Series® pumps.

- Wide Horsepower Range**
 Jandy JCP Commercial Polymer Pumps offer a wide range of horsepower options in 1-phase and 3-phase models
- Seamless Drop-In Replacement**
 Jandy JCP pumps are a direct drop-in replacement for Pentair® EQ Series® and C Series® commercial pumps
- Optional Strainer Configuration**
 Standard models are available with or without a strainer for flexible installation options
- Superior Priming Performance**
 Strainer models are self-priming, and deliver superior, faster priming speeds*
- VFD Compatibility**
 To reduce costs and enhance performance, JCP Pumps are compatible with most VFDs and feature Aegis® Ring technology
- Simplified Motor Replacement**
 Replacement motors that meet or exceed the same electrical specifications of the OEM motor can be used
- Maintenance Accessibility**
 The strainer lid features an innovative integrated relief valve and radial seal for tool-free, easy maintenance
- Motor Efficiency & Protection**
 All 3-phase motors include NEMA Premium Efficiency TEFC motors and Aegis® Ring protection
- Certified Safety & Quality Standards**
 Jandy JCP Commercial Polymer Pumps are UL 1081, CSA C22.2 #108, and NSF-50 listed for certified safety and quality standards
- Specialized Waterfall Application Models**
 Dedicated waterfall models are available for high-flow, low-head applications with TEFC motors in 3 and 5 HP (1-phase and 3-phase)

*Based on internal testing of similar Jandy and competitor pumps. Priming speed varies depending on the pump model.



PRODUCT SPECIFICATIONS

Pump Body	Strainer Assembly	Pump Motor
30% glass-filled thermoplastic blend body, impeller, and diffuser	30% glass-filled thermoplastic blend body and locking ring	Standard JM, NEMA-rated C-flange frame
ANSI-150 flange connections • 6" suction port • 4" discharge port	Polycarbonate lid	Premium-efficiency motors and premium Aegis® Ring protection on all 3-phase models
Back pull-out design	Filled polypropylene basket	VFD Inverter Ready
All stainless-steel hardware	ANSI-150 flange connections	Easily sourced, non-proprietary shaft design with a stainless-steel shaft sleeve
Standard Jandy drain plugs	Radial-seal strainer lid with integrated relief valve	Sealed bearings requiring no lubrication maintenance

Pump With Strainer Pot Dimensions

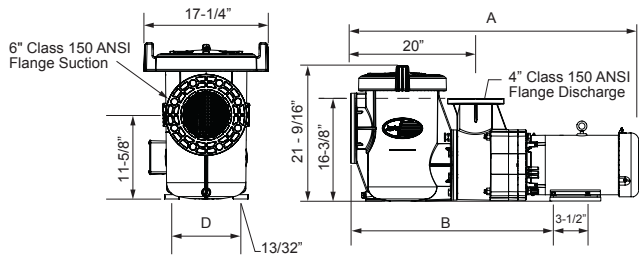

Pump With Strainer Pot

SKU Number	A	B	C	D	Ship Weight (lb)	Ship Dimensions
JCP051CTS	43-1/4"	33"	12-1/2"	9-3/4"	178	48"x 24"x 28"
JCP071BDS	42"	34"	13-1/2"	10-3/4"	197	
JCP053ATS	41-3/4"	33"	12-1/2"	9-3/4"	169	
JCP073ATS	43-1/2"	34"	13-1/2"	10-3/4"	201	
JCP103ATS	43-1/2"	34"	13-1/2"	10-3/4"	209	
JCP153ATS	46"	34"	13-1/2"	10-3/4"	249	

Pump Without Strainer Pot Dimensions

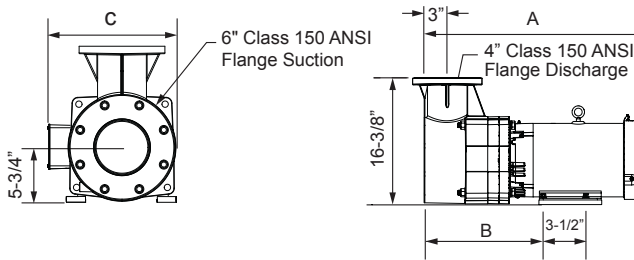

Pump Without Strainer Pot

SKU Number	A	B	C	D	Ship Weight (lb)	Ship Dimensions
JCP051CTN	26-1/4"	16"	12-1/2"	9-3/4"	138	33"x 24"x 25.25"
JCP071BDN	25"	17"	13-1/2"	10-3/4"	157	
JCP053ATN	24-3/4"	16"	12-1/2"	9-3/4"	129	
JCP073ATN	26-1/2"	17"	13-1/2"	10-3/4"	161	
JCP103ATN	26-1/2"	17"	13-1/2"	10-3/4"	169	
JCP153ATN	29"	17"	13-1/2"	10-3/4"	209	
JCPW033ATN	24-3/4"	16"	12-1/2"	9-3/4"	153	
JCPW053ATN	26-1/2"	17"	13-1/2"	10-3/4"	181	
JCPW031CTN	24-3/4"	16"	12-1/2"	9-3/4"	151	
JCPW051CTN	26-1/2"	17"	13-1/2"	10-3/4"	196	

Three Phase Pump Specs (All Models Listed are 3-Phase motors, 6" Suction Port, 4" Discharge Port)

Part No.	Description	HP	Voltage	Amps	Type	Breaker (A)	Startup Amps	Motor Leads	RPM	Strainer
JCP053ATS	JCP 5HP 208-230V/460V TEFC 3Ph w/strainer	5.0	208-230/460	13.6-12.8/6.4	TEFC	20 / 10	118.6/59.3	9 x 16 AWG	3450	Yes
JCP073ATS	JCP 7.5HP 208-230V/460V TEFC 3Ph w/strainer	7.5	208-230/460	22.5-18.0/9.0	TEFC	30 / 15	136.8/68.4	9 x 14 AWG	3520	Yes
JCP103ATS	JCP 10HP 208-230V/460V TEFC 3Ph w/strainer	10.0	208-230/460	29.5-26.8/13.4	TEFC	40 / 20	226/113	9 x 14 AWG	3510	Yes
JCP153ATS	JCP 15HP 208-230V/460V TEFC 3Ph w/strainer	15.0	208-230/460	43-41.6/20.8	TEFC	50 / 25	266/133	9 x 12 AWG	3450	Yes
JCP053ATN	JCP 5HP 208-230V/460V TEFC 3Ph no strainer	5.0	208-230/460	13.6-12.8/6.4	TEFC	20 / 10	118.6/59.3	9 x 16 AWG	3500	No
JCP073ATN	JCP 7.5HP 208-230V/460V TEFC 3Ph no strainer	7.5	208-230/460	22.5-18.0/9.0	TEFC	30 / 15	136.8/68.4	9 x 14 AWG	3520	No
JCP103ATN	JCP 10HP 208-230V/460V TEFC 3Ph no strainer	10.0	208-230/460	29.5-26.8/13.4	TEFC	40 / 20	226/113	9 x 14 AWG	3510	No
JCP153ATN	JCP 15HP 208-230V/460V TEFC 3Ph no strainer	15.0	208-230/460	43-41.6/20.8	TEFC	50 / 25	266/133	9 x 12 AWG	3500	No

Single Phase Pump Specs (All Models Listed are 1-Phase motors, 6" Suction Port, 4" Discharge Port)

Part No.	Description	HP	Voltage	Amps	Type	Breaker (A)	Startup Amps	Motor Leads	RPM	Strainer
JCP051CTS	JCP 5HP 208-230V TEFC 1Ph w/strainer	5.0	208-230	26.0-22.5	TEFC	30	142	2 x 12 AWG	3450	Yes
JCP071BDS	JCP 7.5HP 230V ODP 1Ph w/strainer	7.5	230	38.8	ODP	50	165	2 x 10 AWG	3450	Yes
JCP051CTN	JCP 5HP 208-230V TEFC 1Ph no strainer	5.0	208-230	26.0-22.5	TEFC	30	142	2 x 12 AWG	3450	No
JCP071BDN	JCP 7.5HP 230V ODP 1Ph no strainer	7.5	230	38.8	ODP	50	165	2 x 10 AWG	3450	No

Three Phase Waterfall Pump Specs - Single Phase (All Models Listed are 1-Phase motors, 6" Suction Port, 4" Discharge Port)

Part No.	Description	HP	Voltage	Amps	Type	Breaker (A)	Startup Amps	Motor Leads	RPM	Strainer
JCPW033ATN	JCP Waterfall 3HP 208-230/460V TEFC 3Ph no strainer	3.0	208-230/460	9.6-9.0/4.5	TEFC	15	33.1	9 x 16 AWG	1750	No
JCPW053ATN	JCP Waterfall 5HP 208-230/460V TEFC 3Ph no strainer	5.0	208-230/460	17.0-16.0/8.0	TEFC	20	49.1	9 x 16 AWG	1750	No

Single Phase Waterfall Pump Specs (All Models Listed are 1-Phase motors, 6" Suction Port, 4" Discharge Port)

Part No.	Description	HP	Voltage	Amps	Type	Breaker (A)	Startup Amps	Motor Leads	RPM	Strainer
JCPW031CTN	JCP Waterfall 3HP 208-230V TEFC 1Ph no strainer	3.0	208-230	15.2-14.0	TEFC	20	157	2 x 12 AWG	1750	No
JCPW051CTN	JCP Waterfall 5HP 208-230V TEFC 1Ph no strainer	5.0	208-230	28.2-25.7	TEFC	30	141	2 x 10 AWG	1750	No

Strainer Only

Part No.	Description	Intake	Outlet
JCPSO	JCP Strainer Pot w/Basket	6"	6"

JCP Performance Curves with Strainer

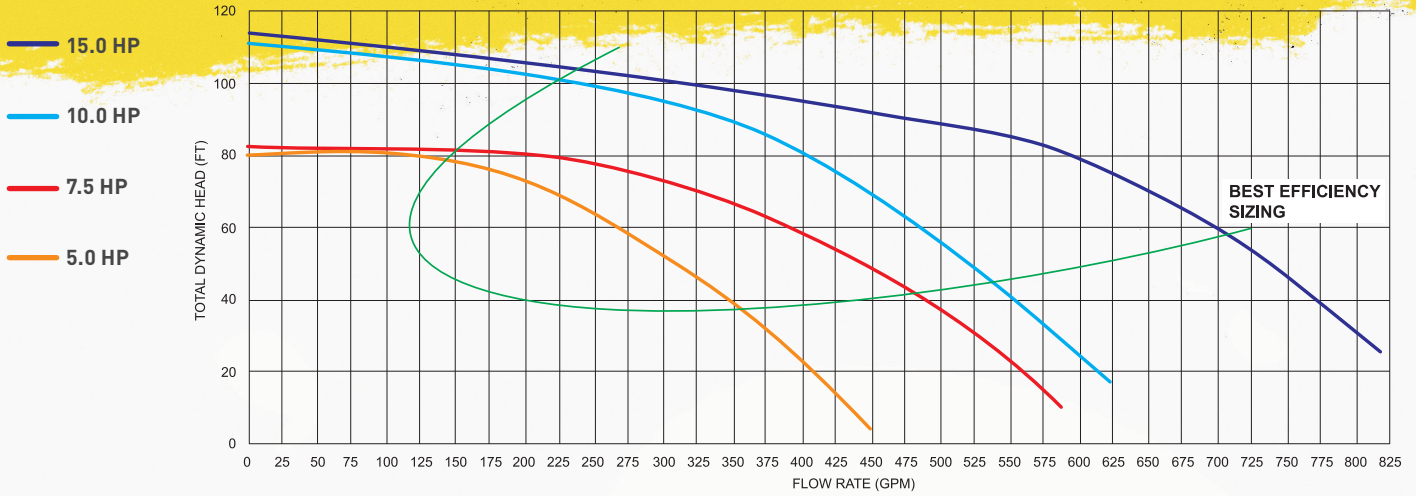

JCP Performance Curves with No Strainer

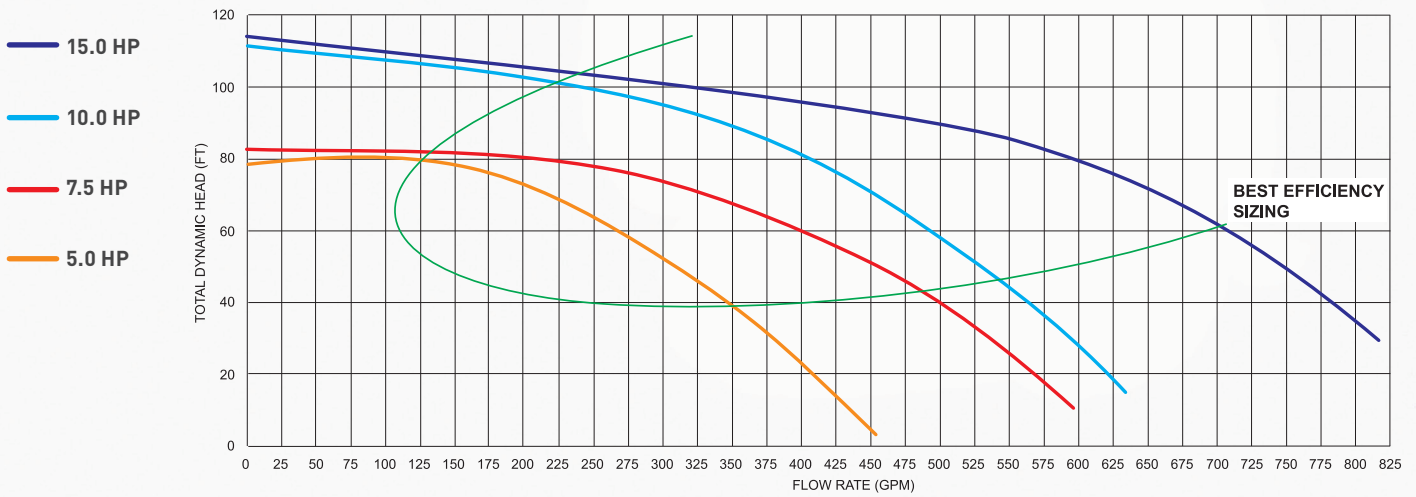

JCPW Waterfall Performance Curves with No Strainer

