

CAUTION – RISK OF SHOCK –

Disconnect Power at the main circuit breaker panel or main fusebox before starting and during the installation.

This fixture is intended for installation in accordance with the National Electric Code (NEC) and Local code specifications. Failure to adhere to these codes and instructions may result in serious injury and/or property damage and will void the warranty. If you are not familiar with code requirements, installation by a certified electrician is recommended.

FOR USE WITH LANDSCAPE LIGHTING SYSTEMS ONLY.

- 1) The device is accepted as a component of a landscape lighting system where the suitability of the CSA or UL labeled combination shall be determined by CSA, UL respectively or the local inspection authorities having jurisdiction.
- 2) Fixture shall be connected to an extra low voltage transformer approved for use with landscape lighting systems.
- 3) This fixture is to be connected to a secondary wiring of the following type:
12 GA 60°C minimum type;
SPT-3 suitable for outdoor use; or
approved landscape lighting cable.
- 4) Xenon lamps do not require additional shielding.
- 5) CAUTION, RISK OF FIRE, 18 MAX WATTS, XENON (NOT TUNGSTEN HALOGEN) LAMP.

CAUTION

WHEN INSTALLING KICHLER LANDSCAPE LIGHTING (LINE VOLTAGE OR LOW VOLTAGE), CARE SHOULD BE TAKEN TO KEEP CLEAR OF POTENTIALLY COMBUSTIBLE MATERIALS. WHEN MAINTAINING THE FIXTURES, BE SURE TO REMOVE LEAVES, PINE NEEDLES, GRASS CLIPPINGS, MULCH, OR ANY DEBRIS THAT HAS ACCUMULATED ON THE LIGHT BULB, LENS, OR BODY OF THE FIXTURE.

ASSEMBLY AND INSTALLATION

1. TURN OFF POWER.
2. Determine desired location for mounting fixture.
3. At desired location, hammer stake into ground. To avoid damage to stake, place a board on top of stake or use a rubber mallet. If ground is hard and stake is difficult to install, make a crosscut in ground using a flat shovel.
4. Clear away area in ground at wireway opening in stake.
5. Remove (2) screws holding cowl in place and remove cowl and lens assembly.
6. Install recommended lamp (not supplied) in socket inside fixture.
7. Fixture is supplied with three glass lens options to create desired lighting effect. To change lens, removed gasket from around glass and replace with selected glass. Reinstall lens and gasket assembly into cowl. Re-assemble cowl onto housing and secure with (2) screws.
8. Route fixture cable through wireway opening and screw stem into stake. Adjust to desired aiming direction. Care should be taken to ensure wire is not twisted
9. Adjust angle of accent light by loosening swivel adjustment screw.
10. If assembly does not look straight, adjust by pushing or pulling on stake only
11. Make wire connections using an approved wiring connectors (not supplied) following instructions provided by manufacturer.

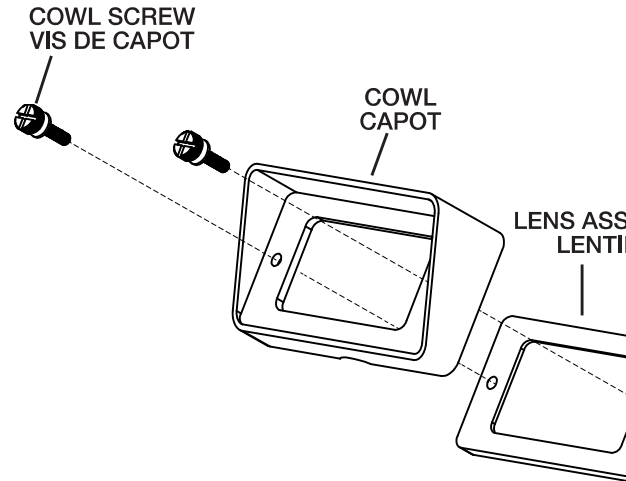

SWIVEL
TÊTE
OSCILLANT

STAKE
PIQUET

ATTENTION – RISQUE DE DÉCHARGES ÉLECTRIQUES –

Couper le courant au niveau du panneau du disjoncteur du circuit principal ou de la boîte à fusibles principale avant de procéder à l'installation.

Cet appareil est prévu pour l'installation conformément au Code électrique National (NEC) et les spécifications du code Local. Ne pas respecter ces codes et instructions peut entraîner des blessures graves et/ou des dommages matériels et annulera la garantie. Si vous ne connaissez pas les exigences de ces codes, il est recommandé de confier l'installation à un électricien certifié.

A UTILISER UNIQUEMENT POUR LES SYSTÈMES D'ÉCLAIRAGE PAYSAGER

- 1) Le dispositif est accepté en tant que composant d'un système d'éclairage

MONTAGE ET INSTALLATION

1. COUPER LE COURANT ÉLECTRIQUE.

SAFETY INSTRUCTIONS READ THIS FIRST KEEP THESE INSTRUCTIONS

CAUTION – RISK OF SHOCK –

Disconnect Power at the main circuit breaker panel or main fusebox before starting and during the installation.

This fixture is intended for installation in accordance with the National Electric Code (NEC) and Local code specifications. Failure to adhere to these codes and instructions may result in serious injury and/or property damage and will void the warranty.

- 1) **WARNING:** This fixture is not to be installed within 10 feet (3M) of a pool, spa or fountain.
- 2) This fixture is to be used only with a power unit (transformer) rated a maximum of 300 W (25 AMPS) 15 volts.
- 3) The unit low voltage cable shall:
 - a) be protected by routing in close proximity to the luminaire or fitting, or next to a building structure such as a house or deck;
 - b) not be buried except for a maximum 6 inches (15.2 cm) in order to connect to the main low voltage cable; and
 - c) have the length cut off so that it is connected to a connector within 6 inches (15.2 cm) from a building structure, a luminaire, or fitting.
- 4) Direct burial rated wire is to be buried a minimum of 6" (152mm) beneath the surface of the ground.

NOTE: If additional Direct Burial wire is needed, contact your local Kichler® landscape distributor.

- 8 GA wire can be purchased in length of 250' (76 M), 15503-BK.
 - 10 GA wire can be purchased in length of 250' (76 M), 15504-BK.
 - 12 GA wire can be purchased in lengths of 100' (30 M), 15501-BK; 250' (76 M), 15502-BK; 500' (152M), 15505-BK; and 1000' (304 M), 15506-BK.
- 5) Fixture shall not use a tungsten halogen lamp unless the fixture is marked for use with such lamps.
 - 6) Wiring connections must be made with approved/listed wire connection device(s) suitable for the application. Do not exceed manufacturers' wiring combination specifications for size and quantity of conductors.
 - 7) Xenon lamps do not require additional shielding.

CAUTION

WHEN INSTALLING KICHLER LANDSCAPE LIGHTING (LINE VOLTAGE OR LOW VOLTAGE), CARE SHOULD BE TAKEN TO KEEP CLEAR OF POTENTIALLY COMBUSTIBLE MATERIALS.

WHEN MAINTAINING THE FIXTURES, BE SURE TO REMOVE LEAVES, PINE NEEDLES, GRASS CLIPPINGS, MULCH, OR ANY DEBRIS THAT HAS ACCUMULATED ON THE LIGHT BULB, LENS, OR BODY OF THE FIXTURE.

ASSEMBLY AND INSTALLATION

1. **TURN OFF POWER.**
2. Determine desired location for mounting fixture.
3. At desired location, hammer stake into ground. To avoid damage to stake, place a board on top of stake or use a rubber mallet. If ground is hard and stake is difficult to install, make a crosscut in ground using a flat shovel.
4. Clear away area in ground at wireway opening in stake.
5. Remove (2) screws holding cowl in place and remove cowl and lens assembly.
6. Install recommended lamp (not supplied) in socket inside fixture.
7. Fixture is supplied with three glass lens options to create desired lighting effect. To change lens, removed gasket from around glass and replace with selected glass. Reinstall lens and gasket assembly into cowl. Re-assemble cowl onto housing and secure with (2) screws.
8. Route fixture cable through wireway opening and screw stem into stake. Adjust to desired aiming direction. Care should be taken to ensure wire is not twisted
9. Adjust angle of accent light by loosening swivel adjustment screw.
10. If assembly does not look straight, adjust by pushing or pulling on stake only.
11. Make wire connections using an approved wiring connectors (not supplied) following instructions provided by manufacturer.

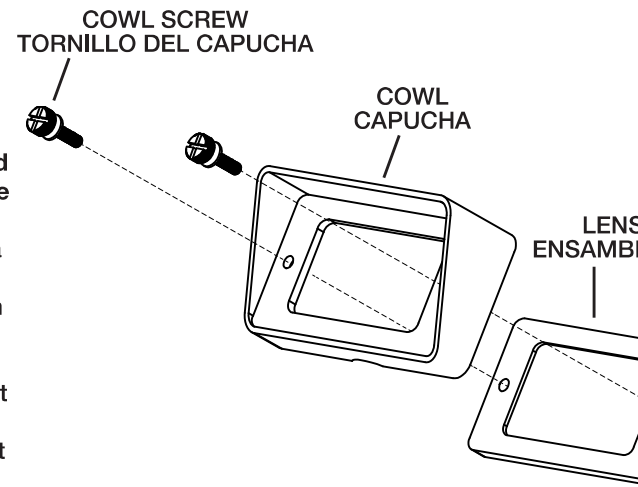

SWIVEL
ARTICULACIÓN
GIRATORIO

STAKE
ESTACA

- 5) El artefacto no debe utilizarse con lámparas a menos que el artefacto esté marcado para usar con tales lámparas.
- 6) Las conexiones de cableado se deben hacer con dispositivos de conexión de cableado apropiados para la aplicación. No exceda las especificaciones de cableado del fabricante para el tamaño y cantidad de conductores.
- 7) Las lámparas de xenón no requieren blindaje adicional.

PRECAUCION

CUANDO SE INSTALE SISTEMAS DE ALUMBRADO KICHLER, DEBE SEGUIRSE LAS INSTRUCCIONES DE INSTALACION Y MANTENIMIENTO.