

Direct Drive Pumps



WGFP-Series

Constructed with stainless steel, cast iron and durable thermoplastic, our solids-handling submersible Little Giant water feature pumps meet the rigorous demands of the most impressive water features. This year we have added a larger size to meet all of your decorative water needs.

- Designed for water features
- Dual seals for added protection in larger models
- Great as replacement pump and for new construction



WGFP SERIES	Item Number	Amps	Watts	Volts	Cord Submerged (ft)	Discharge Use	Discharge FNPT	Gallons Per Hour (GPH) at height								Solids Diameter	Shut Off (ft)
								5'	10'	15'	20'	25'	30'	35'	40'		
WGFP-33	566067	5	455	115 V	19'	✓	1-1/2"	2500	2000	1400	600	-	-	-	-	0.98"	25
WGFP-50	566068	7	590	115 V	19'	✓	2"	4280	3520	2780	1830	800	-	-	-	1.18"	30
WGFP-75	566069	8	847	115 V	19'	✓	2"	4890	4350	3750	3070	2262	-	-	-	1.38"	36
WGFP-100	566070	12	1210	115 V	19'	✓	2"	6400	5500	4700	3700	2500	-	-	-	1.35"	35
WGFP-150	566071	11	1210	115 V	19'	✓	3"	9750	8200	6500	4600	2200	-	-	-	0.75"	32
WGFP-200	566072	9	2085	230 V	19'	✓	3"	16000	15000	13410	11575	9775	7645	5610	3120	0.75"	45

DIMENSIONS (INCHES)

	A	B	C	D	E
WGFP-33	12.86	3.46	7.75	3.98	5.29
WGFP-50	13.85	3.88	8.78	4.53	5.83
WGFP-75	14.44	3.88	8.78	4.53	5.83
WGFP-100	17.35	4.05	10.29	5.18	6.30
WGFP-150	18.50	5.00	11.75	6.50	7.50
WGFP-200	20.31	5.13	11.71	5.96	7.50

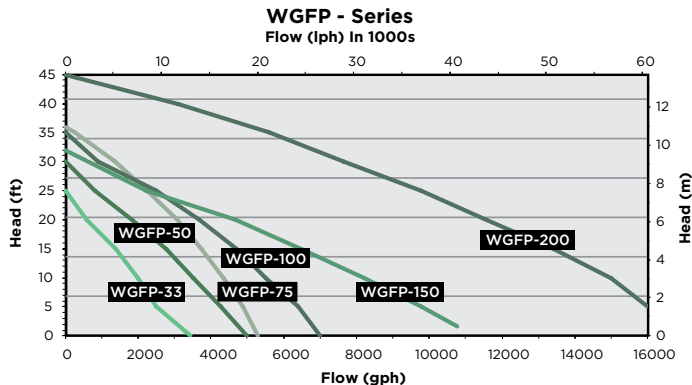
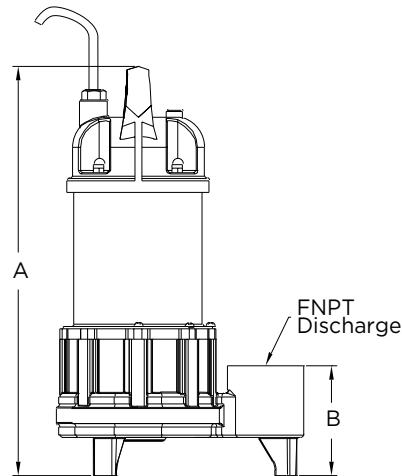
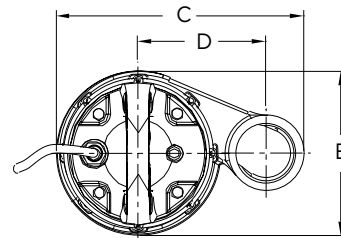

Little GIANT®
Outdoor Living

HOTLINE 888.956.0000

lg-outdoor.com

Rev. 001

