

ROYAL II WITH CLASSIC LADDER

(*Classic Ladder also compatible with Royal Entrance and Festiva steps)

Contents of Accessory box

SCREW KIT 140-0070

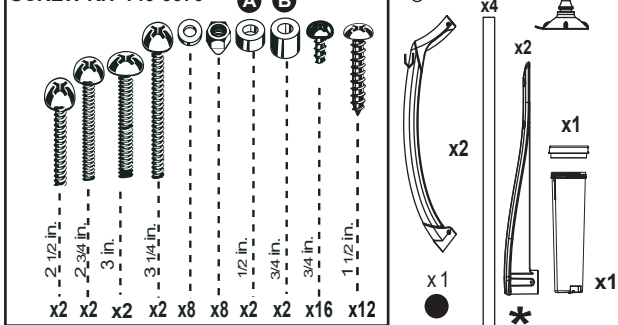

Contents of Ladder box SKU # 6007

SCREW BAG 140-0058

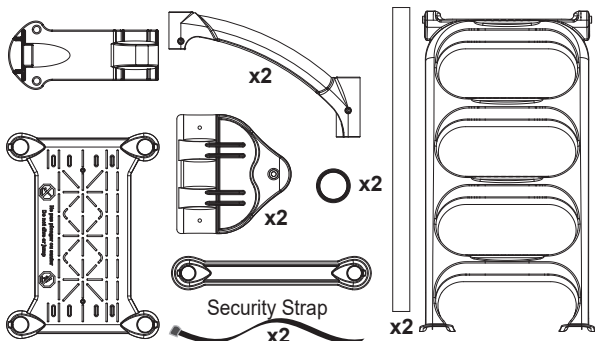
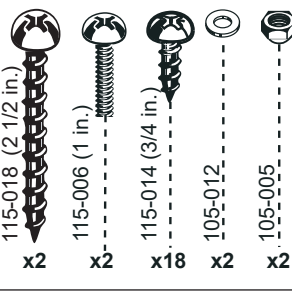

WARNING

- ▶ Do not jump nor dive from the step; you can be permanently injured.
- ▶ To prevent electrocution use only **BATTERY** operated tools to assemble the step.
- ▶ To prevent drowning or injuries, do not use the step outside the pool or to access a pool, and fasten the step firmly to the outside ladder.
- ▶ For 48,52,54" above-ground pool only.
- ▶ The step must be installed per manufacturer's instructions.
- ▶ Maximum capacity is 300 lbs / 135 kg.
- ▶ The outside ladder must be installed on a flat surface.

Tools required (not included)

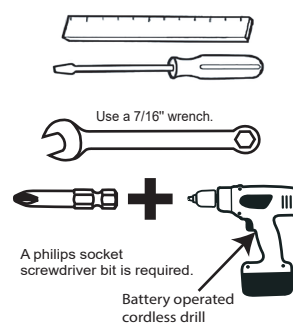

Royal II Step Shell

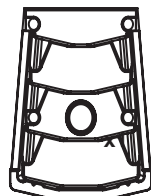

Caution

- ▶ Use of corrosive cleaning solutions can damage the step components.
- ▶ Remove the step from water when temperatures drop below freezing.
- ▶ To prevent damaging the step, never lift the step by its handrails.
- ▶ The manufacturer is not responsible for damages or injuries caused by improper installation or use of the product.
- ▶ Failing to install the Step Cup™ will greatly reduce the steadiness of the step and will void the manufacturer warranty.
- ▶ To prevent pool liner puncture, install the Step Cup™ provided.
- ▶ Damage caused by freezing or winterization is not under warranty.

A

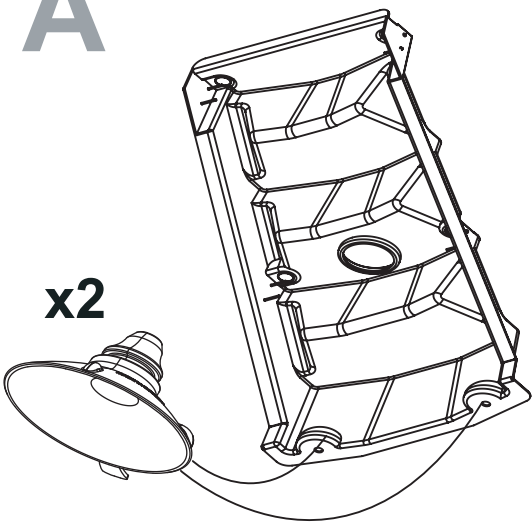

Insertion of Step Cup™ in the step.

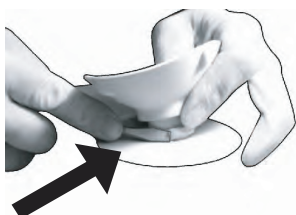

With a flat screwdriver, compress the Step Cup™ mushroom ring while pushing it into the hole. Twist the Step Cup™ to ensure that its mushroom has entirely cleared the wall thickness.

B1

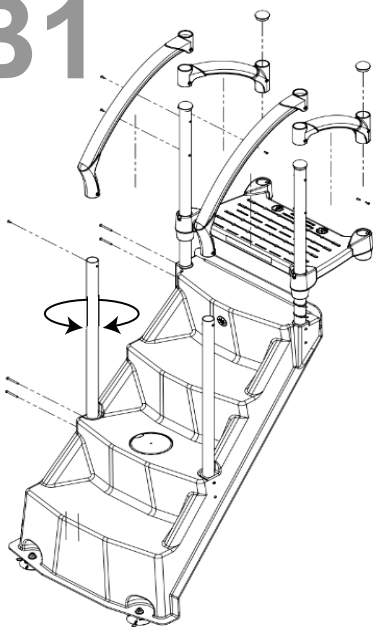

TOP POST

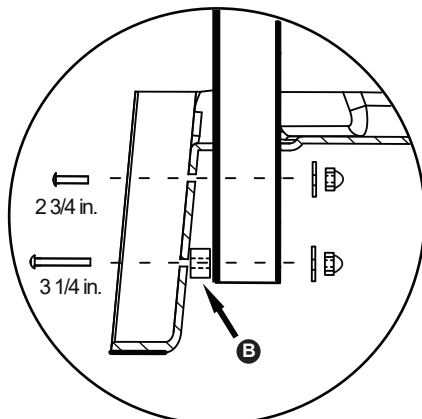

1) Begin the assembly with the two top posts. Using a ruler, pick the bolts you need: two 2 3/4" and two 3 1/4" bolts. Use the two tallest spacers and the washers and nuts as per the schematic Top post. Assemble the two top posts, **DO NOT TIGHTEN, YET.**

BOTTOM POST

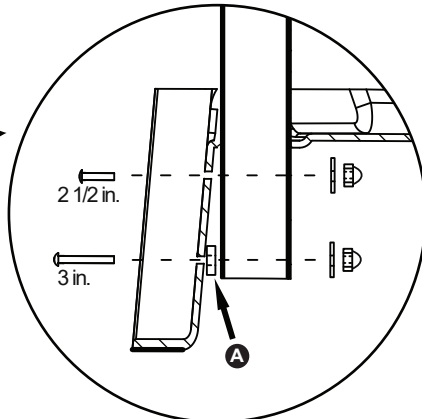

*Adjust by rotating each posts prior to fastening the handrails.

2) Assemble the bottom posts. Using a ruler, pick the bolts you need: two 2 1/2" and two 3" bolts. Use the two thin spacers, washers and nuts as per the schematic Bottom post, **DO NOT TIGHTEN, YET.**

MANUFACTURER WARRANTY

1 year on pool step.
1 year on hardware.



2257 route 139
Drummondville, Québec
J2A 2G2

WWW.INNOVAPLAS.COM

REV. 16/04/2025

PG:1

ROYAL II WITH CLASSIC LADDER

B2

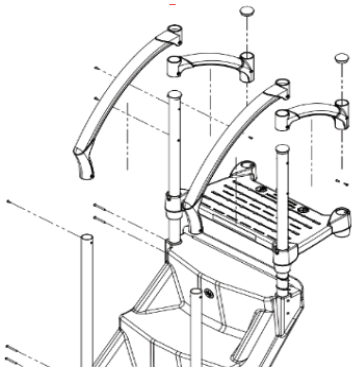

- 1) Install the four post covers.
- 2) Secure the 4 handrails to the posts using the screws provided. **DO NOT SECURE THE PLATFORM UNTIL STEP D2.**

C

- 1) Fill with sand or rock dust
- 2) Screw the lid in place and align the cover ribs with the holes in the ballast base.
- 3) Fasten the 4 screws through the ballast base
- 4) Insert the entire step into the pool. Be careful not to damage the pool liner.
- 5) Drop the ballast in the step hole.

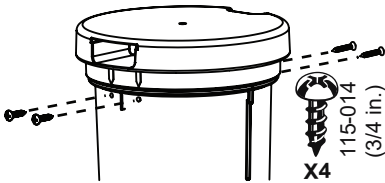
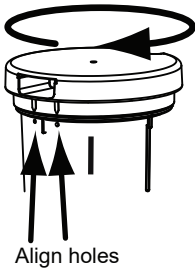
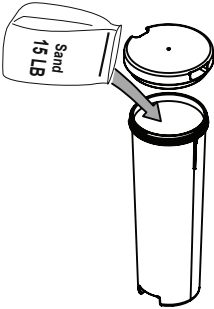

CAUTION
To prevent pool liner puncture keep a minimum of 1" gap between the pool liner and the rear of the step.

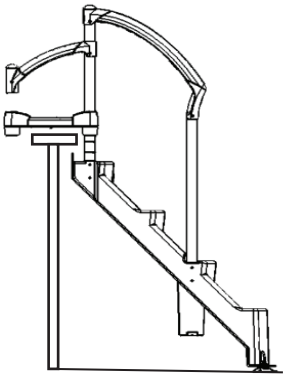

D1

- 1) Trace a line on each post at 39 inches from the ground for 48" and 52" pools. If you have a 54" pool, trace a line at 40.5 inches from the ground.
- 2) Slide the pivot blocks onto the posts and line up with the traced marks. Secure with the screws provided.

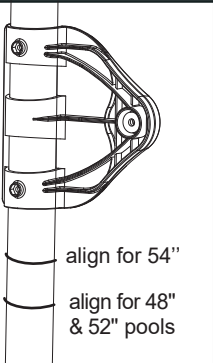

D3

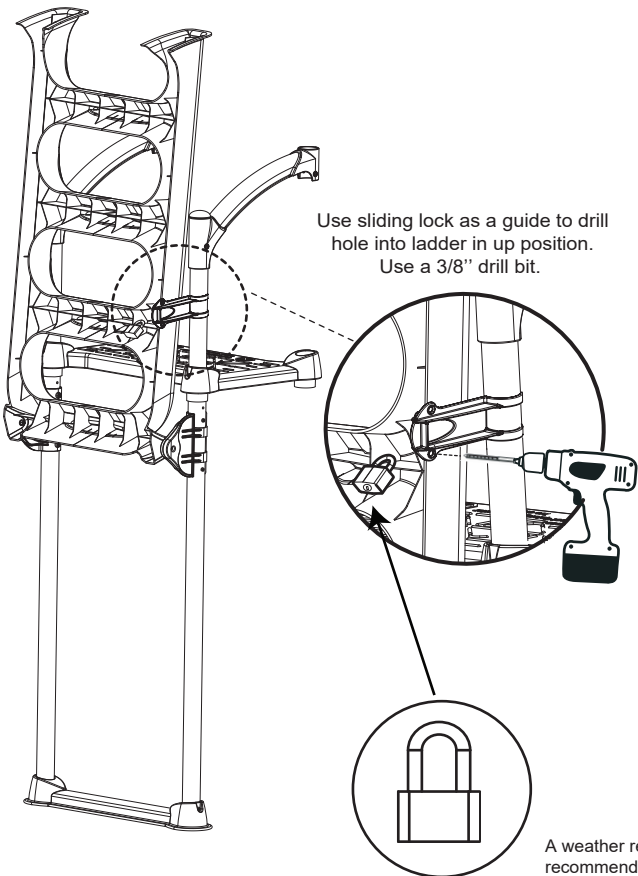

Use sliding lock as a guide to drill hole into ladder in up position. Use a 3/8" drill bit.

A weather resistant padlock is recommended. (NOT INCLUDED. Maximum functional width is 1/4")

D2

- 1) Attach the ladder to the pivot blocks with the bolts, washers and nuts provided.
- 2) Attach the ladder base to the bottom of the posts with the screws provided.
- 3) Slide the platform over the top of the posts. Do not secure yet. Slide lock over right post.
- 4) Insert the post covers into the handrails. Secure the two handrails to the posts as illustrated with the screws provided on both sides of the pool wall.
- 5) Once the platform is slid onto the four posts, secure it to the top seat (see illustration) using the two straps provided.

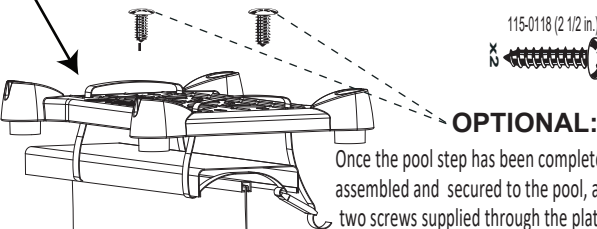
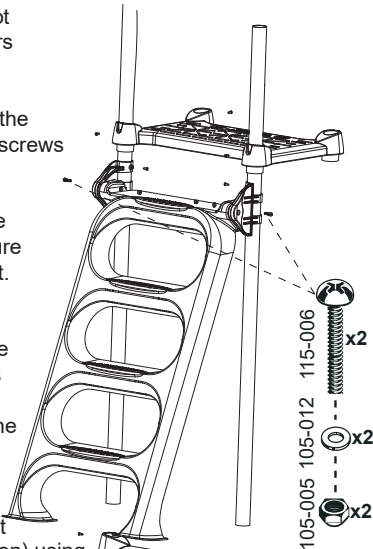

OPTIONAL:
Once the pool step has been completely assembled and secured to the pool, attach the two screws supplied through the platform to the top seat of your pool to provide a more rigid assembly.

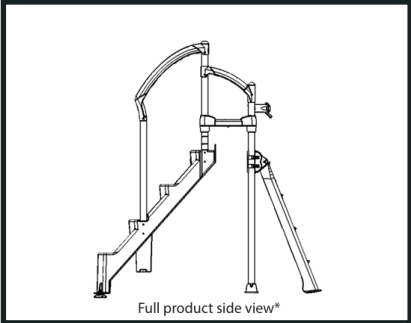

Full product side view*



*Only use this item with deck-installed steps

MANUFACTURER WARRANTY

1 year on pool step.
1 year on hardware.