

LAB-003-8W-27K  
LAB-003-8W-30K

Path Light  
Replacement Module/Shroud  
Accessory



SPECIFICATIONS

Fixture Type	Fixture Components	Fixture Material	Fixture Style
L (Lumien)	A (Accessory)	B (Brass)	003 (Path Light Replacement Module/Shroud)

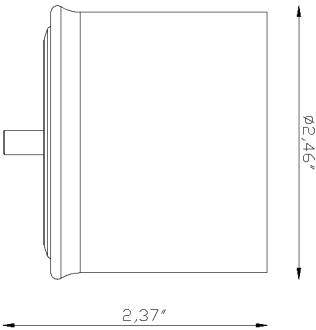

Construction: Brass  
Finish: Antique Brush  
Light Source: Modular LED  
Wattage: 8W  
Operating Voltage: 10-15V  
Lumens: 380 LM  
Color Temperature: 2700K, 3000K  
RGB: No  
CRI: 80+  
Rated Life: 50,000 Hrs

APPLICATION

Environment: Wet, Damp or Dry Area approved.

ACCESSORIES



LAB-038



LAB-039



LAB-015



LAB-085

WARRANTY

Lifetime Warranty on the Housing,  
10 Year Warranty on the LED Light Source

CERTIFICATION

UL Listed I File #E501872

Lumien Lighting reserves the right to modify the design of our products at any time and data listed on spec sheets is subject to change.