

M4B6-5.5W-27K-R

M4B6-5.5W-30K-R

Micro Angled Shroud

Underwater Light

Micro Full Assemblies



SPECIFICATIONS

Fixture Type	Fixture Components	Fixture Material	Fixture Style	Watts	Color Temperature	Finish
M (Micro)	4 (Integrated Modular)	B (Brass)	6 (UWA)	5.5W	27K (2700K) 30K (3000K)	R (Raw)

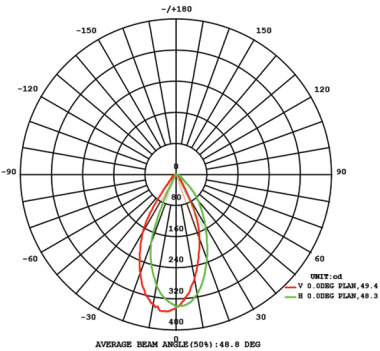
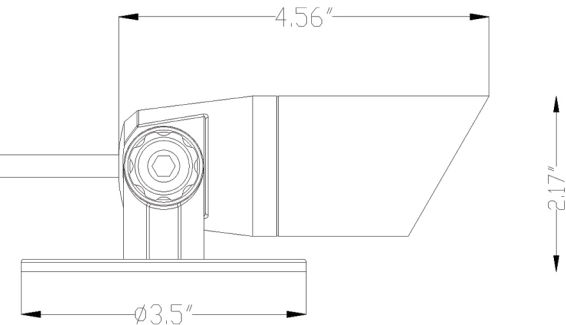

Construction: Brass
Finish: Raw
Lead Wire: 30ft long
Mounting: Underwater Mount
Light Source: Modular LED
Wattage: 5.5W
Operating Voltage: 10-15V
Lumens: 254 LM
Color Temperature: 2700K, 3000K
Volt Amps: 8.11
RGB: No
CRI: 80+
Rated Life: 50,000 Hrs
Dimmable: Primary Dimming Capable

APPLICATION

Environment: Wet, Damp or Dry Area approved.

ACCESSORIES



TR-120

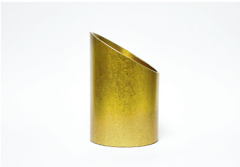

LAB-031-R



M4B1-3.5W-27K-R



M4B1-3.5W-30K-R

WARRANTY

Lifetime Warranty on the Housing,
10 Year Warranty on the LED Light Source

CERTIFICATION

UL Listed I File #E501872

Lumien Lighting reserves the right to modify the design of our products at any time and data listed on spec sheets is subject to change.