

M4B7-5.5W-27K-A

M4B7-5.5W-30K-A

Micro Shell Enclosure

Spot Light

Micro Full Assemblies



SPECIFICATIONS

Fixture Type	Fixture Components	Fixture Material	Fixture Style	Watts	Color Temperature	Finish
M (Micro)	4 (Integrated Modular)	B (Brass)	7 (SMS)	5.5W	27K (2700K) 30K (3000K)	A (Antiqued)

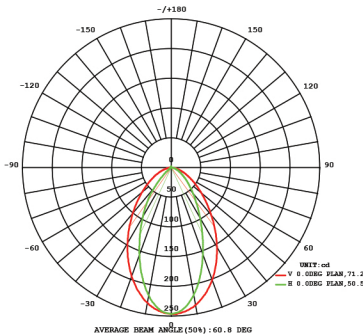
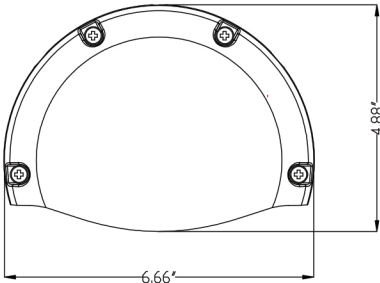
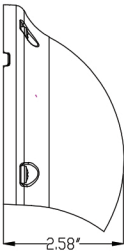

Construction: Brass

Finish: Antique Brush

Lead Wire: 6ft long

Mounting: Surface Mount

Light Source: Modular LED

Wattage: 5.5W

Operating Voltage: 10-15V

Lumens: 275 LM

Color Temperature: 2700K, 3000K

Volt Amps: 8.67

RGB: No

CRI: 80+

Rated Life: 50,000 Hrs

Dimmable: Primary Dimming Capable

APPLICATION

Environment: Wet, Damp or Dry Area approved.

ACCESSORIES



M4B1-3.5W-27K-A



M4B1-3.5W-30K-A



LAP-001



TR-120

WARRANTY

Lifetime Warranty on the Housing,

10 Year Warranty on the LED Light Source

CERTIFICATION

UL Listed I File #E501872

Lumien Lighting reserves the right to modify the design of our products at any time and data listed on spec sheets is subject to change.