

# Grooved Adapter Nipples • Spec Sheet



## FEATURES & BENEFITS

- Schedule 40
- Grooved x Bevel and Grooved x Threaded
- Conforms to ASTM A53 and ASME B1.20.1
- All Grooves are Cut Grooved Per AWWA C606

### GROOVED x BEVEL DIMENSIONS

Part #	Size	A	B	Weight (lbs)
ZNB084GB	2" x 4"	4.00	2.38	1.10
ZNB094GB	2-1/2" x 4"	4.00	2.88	1.68
ZNB103GB	3" x 3"	3.00	3.50	1.55
ZNB104GB	3" x 4"	4.00	3.50	2.19
ZNB114GB	4" x 4"	4.00	4.50	2.79

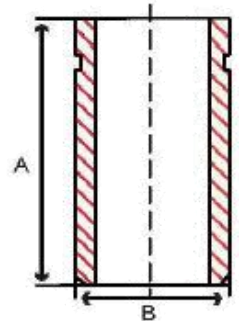

### GROOVED x THREADED DIMENSIONS

Part #	Size	A	B	Weight (lbs)
ZNB074GT	1-1/2" x 4"	4.00	1.90	0.81
ZNB084GT	2" x 4"	4.00	2.38	1.10
ZNB094GT	2-1/2" x 4"	4.00	2.88	1.68
ZNB103GT	3" x 3"	3.00	3.50	1.55
ZNB104GT	3" x 4"	4.00	3.50	2.18
ZNB114GT	4" x 4"	4.00	4.50	3.09
ZNB116GT	4" x 6"	6.00	4.50	4.90

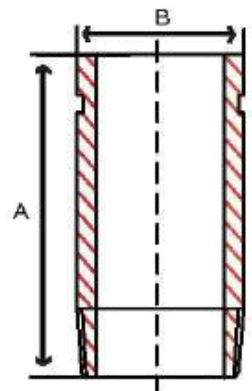

Global sourcing. National compliance. Local service.

**CALIFORNIA** 5595 Fresca Dr., La Palma CA 90623  
**TEXAS** 1150 Silber Rd., Houston TX 77055  
**ILLINOIS** 278 Windy Point Dr., Glendale Heights, IL 60139  
**GEORGIA** 113 Industrial Blvd., Americus, Georgia 31709  
**NEW YORK** PO Box 27, Rt.22, Brewster NY 10509  
 WEB: [www.matco-norca.com](http://www.matco-norca.com)

• Phone: 866-532-8306 • Fax: 866-532-8307  
 • Phone: 800-935-5456 • Fax: 713-680-2999  
 • Phone: 844-412-5068 • Fax: 800-640-2252  
 • Phone: 800-433-7526 • Fax: 800-533-5134  
 • Phone: 800-431-2082 • Fax: 845-278-9056  
 EMAIL: [mail@matco-norca.com](mailto:mail@matco-norca.com)