

HOTSHOT

COMMERCIAL BROADCAST SPREADER

 **meyer**

a brand of aebe schmidt

38170

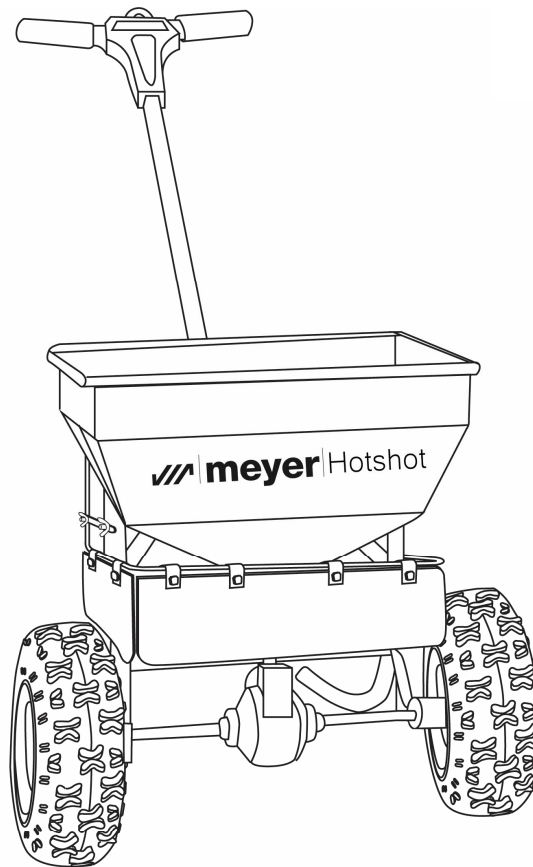

OWNER'S MANUAL

ASSEMBLY INSTRUCTIONS

- 1) Remove components from carton and place spreader upside down on a padded surface. For easier assembly, remove the deflector shield by loosening the two wing bolts. Install LH & RH brace to frame as shown using (4) $\frac{1}{4}$ -20 x 2 $\frac{1}{4}$ " hex bolts and nuts, but do not tighten.

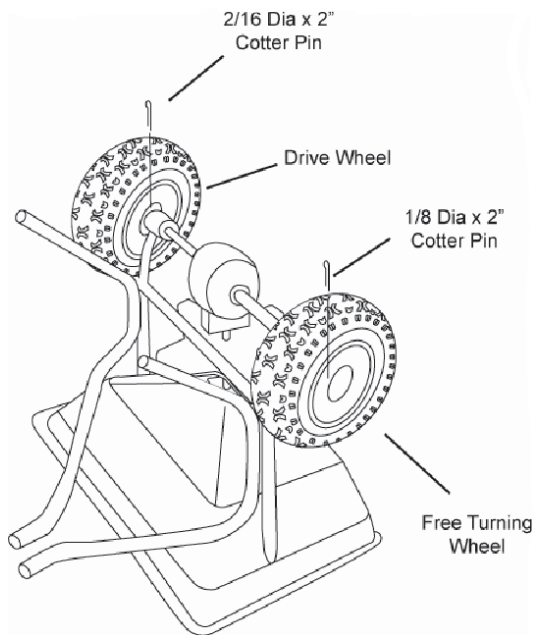
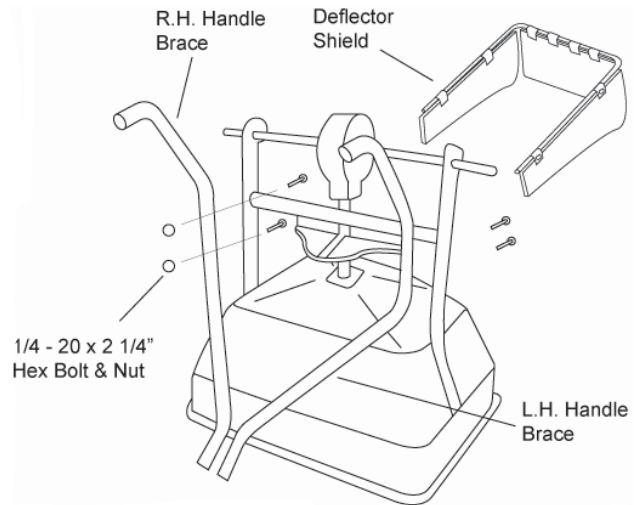

- 2) Slide wheels onto end of axle with the hub facing toward frame. Wheels are identical to ease assembly. Align the hole in the wheel hub and the hole in axle as shown. Secure drive wheel to axle with $\frac{3}{16}$ dia X 2" cotter pin. Insert $\frac{1}{8}$ dia X 1 $\frac{1}{4}$ " cotter pin in the hole near the end of axle to retain free turning wheel.

- 3) Turn spreader upright and install end of handle tube with DOT between handle braces as shown. Secure with (2) $\frac{1}{4}$ -20 x 1 $\frac{1}{2}$ " hex bolts and nuts. Tighten bolts left loose in Step #1

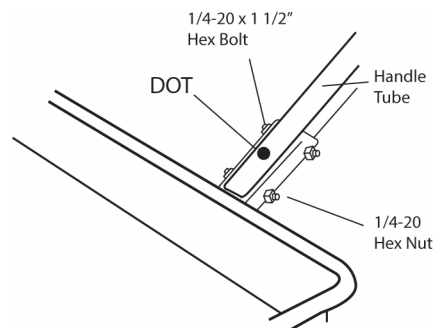

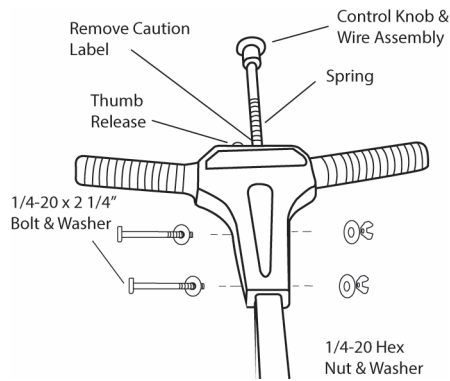

CAUTION: Once knob is latched do not move thumb release until you have completed step # 5.

4) Feed control knob/wire through the T-handle until spring touches the round hole. CAUTION: Do Not Compress Spring at This Time. Feed wire through the square handle tube, be sure wire passes above the bolts in the handle brace. Secure T-handle to the tube with 1/4-20 x 2 1/4" hex bolts, washers, and hex nuts as shown. Remove caution label and push the thumb release toward the center and push down knob and shutoff spring until knob latches.

4b) Slide wire retaining clip onto wire as shown. Insert wire through hole shutoff plate. Slide wire retaining clip over shutoff plate and wire until the clip locks into place.

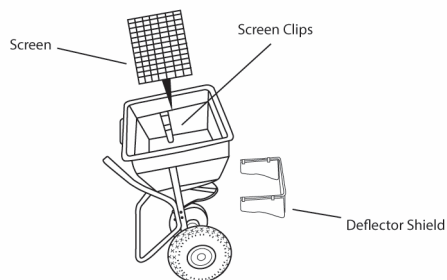
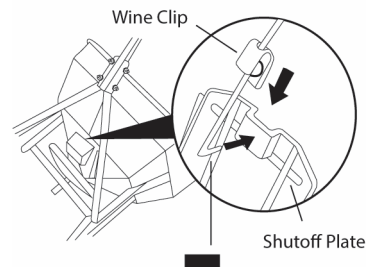

5) Insert screen into hopper by sliding it under the screen clips. Install deflector shield removed in step #1

OPERATION

NOTE: This spreader is equipped with a factory installed deflector shield that is used for applying ice melt to narrow areas. Shield is easily removed when ice melt is applied to large areas or when using turf care products.

- 1) Check the package for the rate setting, and recommended swath width. Turn the spreader OFF by pushing the control knob in. Rotate the rate cam to the proper setting.
- 2) The rate setting is adjusted by rotating the rate cam to the desired setting. The rate cam locks at each setting.
- 3) Always fill the spreader on the driveway or sidewalk-not the lawn. Make sure the spreader is in the "OFF" position. Empty after each use.
- 4) Start spreader moving, then opens spreader by pushing the thumb release on the "ON" position. Always push spreader, never pull. Push knob down to close spreader.
- 5) Hold handle so top of spreader is level. Tipping the spreader too far can cause uneven spreading.
- 6) The settings and swath widths on the product label are recommended starting points. Always check the delivery rate and pattern on a small area before treating a large area. Actual delivery rate can vary due to weather conditions, operating variables, and condition of the product being applied. See "HOW TO DETERMIN SPREADER SETTINGS" for details.
- 7) Push spreader 2 ½ MPH (18 feet in 5 seconds) for full 8' to 14' spread pattern when applying fertilizer products. Apply header strips at each end of area as shown.
- 8) Empty spreader after each use. Return leftover material to its original container.

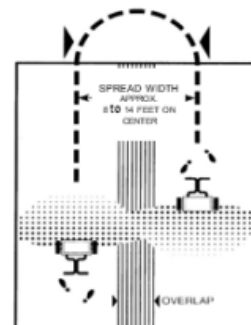
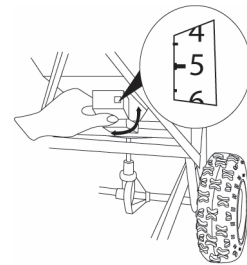
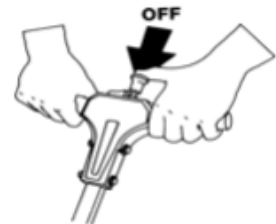

SPREAD WIDTH

Two major factors should be considered when determining correct spreader settings of any product:

- 1) The product application rate, or the amount of material applied per 1,000 sq ft.
- 2) The effective pattern width, or the actual width in which material is applied. Label settings are a guide and can be affected by numerous factors.

A simple visual pattern test can be made by operating the spreader over a non-turf area and evaluating the pattern. A more accurate method is to place a row of common, disposable, aluminum cake pans approximately 1 foot on centers. Set the rate cam at a middle setting and make 3 or 4 passes in the same direction as shown. Pour the material collected from each pan into individual bottles of the same size. Set them side by side in order, and visually inspect their volume. The effective pattern width is the distance out from the spreader to a point where the amount of material is $\frac{1}{2}$ the average amount in the center pans. The distance is multiplied by 2 to achieve the total effective pattern width.

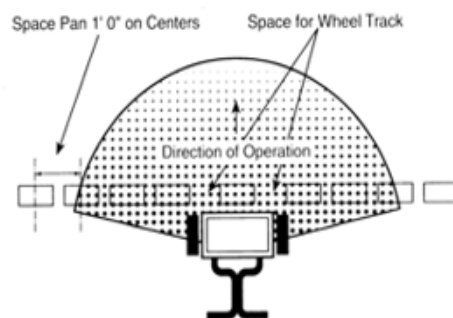

APPLICATION RATE

Knowing the effective pattern width (for example, 10 feet), measure a distance equal to 100 square feet (10' X 10' area covered). Determine the product coverage in pounds/100sq.ft. by taking the weight of the product and dividing it by the recommended square foot coverage (add two zeroes to the weight of the bag).

EXAMPLE:

Product weighs 25 lbs.

Square foot coverage: 5,000 sq. ft

$2500 \text{ lbs} - 5,000 \text{ sq ft} = .5 \text{ lbs} / 100 \text{ sq ft}$





Weigh out between 15 to 20 lbs. of material and spread over the 100 sq ft area. Weigh remaining material left in the hopper and adjust rate setting as required. Repeat test until application rate is correct.

RATE SETTING CONVERSION

The following provides approximate Meyer Hotshot settings for the units listed

MEYER HOTSHOT	2	3	4	5	6	7	8	9	10	11	12	13	14	15	16	17	18
PRIZELAWN BF-1/55, HVO	G	H	J	K	M	N	N1/2	O	P1/2	Q	R	S	T	U	V	X	Z
LESCO HI-WHEEL	E	F	G	H		J	K	L			M	N	O		P	R	S
SCOTT SPEEDY GREEN			2		3		4		5		6		7		8		
SCOTTS RBA/SR-1 AP&SR2000		J	L	M	O	P		Q		S	T	U		V	W	X	Z

The following provides approximate Meyer HOTSHOT settings when only the product weight, square foot coverage, and visual inspection of the material is available.

FERTILIZER PARTICLE SIZE		BAG RATE POUNDS OF FERTILIZER USED PER 1,000 SQ FT COVERAGE	APPROX. SETTING	APPROX. SPREAD WIDTH
LARGE, HEAVY PARTICLES		5 10 15	6 9 11	12ft 12ft 12ft
MEDIUM-MIXED PARTICLES		5 10 15	5 7 9	10ft 10ft 10ft
SMALL PARTICLES (NITROGEN)		1 2 3	2 4 5	10ft 10ft 10ft
MIXED SIZE PARTICLES -SOME FINES		5 10 15	6 9 11	8ft 8ft 8ft
LIGHT WEIGHT PARTICLES		5 10 15	4 5 6	6ft To 8 ft

The conversion should be used as a guideline for establishing proper rate settings for the particular product being applied.

These settings are approximate and may vary due to physical characteristics of the product. Walking speed, wear, condition of the turf, and humidity may cause actual rate settings to deviate. No expressed nor implied warranty or guarantee is provided as to coverage or uniformity indicated by these rate settings.

- 1) Never store unused material in spreader. Return unused product to its original container.
- 2) Wash spreader thoroughly after each use and dry completely in the sun or heated area
- 3) Oil the axle bearings, impeller shaft bearing in hopper, control knob in T-handle
- 4) Remove gear cover and wash gears thoroughly. Oil all bearing areas and face of gear teeth. Re-install gear cover
- 5) Gear mesh should be checked on a regular basis during high use periods. Clearance between the axle gear and pinion gear should be minimal but not tight. If adjustment is necessary, loosen axle collar set screw and hold gears together. Slide axle collar against the gear support and tighten axle collar set screw. Spin drive wheel. Gears should run freely and smoothly.
- 6) Impeller surface should be cleaned periodically to remove build-up of product. Build-up can cause the spread pattern to change.
- 7) Tire pressure should be 20-25 PSI

WARRANTY

WHAT IS COVERED:

Meyer Products, LLC, warrants to the original purchaser of Meyer branded products, that they will be free from defects in materials and/or workmanship, with the exceptions stated below. No person is authorized to change this warranty or to create any additional warranty on Meyer branded products.

HOW LONG COVERAGE LASTS:

This warranty runs for a period of one (1) year* from the date of purchase of the spreader. In addition to the warranties covering the spreader, sprayer, or broom, you will receive a warranty period of one (1) year from the date of purchase of individual parts, components, and accessories. All foregoing warranties apply only to an original purchaser of the product is installed by an authorized distributor, sub-distributor, and terminates if the product is sold or otherwise transferred. Some states do not allow limitations on how long an implied warranty lasts, so the above limitation may not apply to you.

WHAT IS NOT COVERED:

- Problems caused by failure to follow the product instructions, failure to maintain the product as described in the Owner's Manual, or failure to maintain proper levels of fluids and lubricants.
- Problems caused by contamination or restriction of lubricants of damage resulting from rust, corrosion, freezing, or overheating.
- Paint or expendable part such as pins, chrome plating, augers, etc.
- Any spreader, sprayer, broom, component, accessory, or assembly thereof, which has been modified or altered.
- Liability for damage to property, injury to, or death of any person arising out of the operation, maintenance, or use of covered product.
- Liability of cost of modification to the spreader, sprayer, or broom and/or vehicle required for installation and maintenance.
- Products with missing or altered serial numbers.

VISIT MEYERPRODUCTS.COM/WARRANTY FOR COMPLETE WARRANTY INFORMATION.

PARTS LIST FOR MODEL #38170

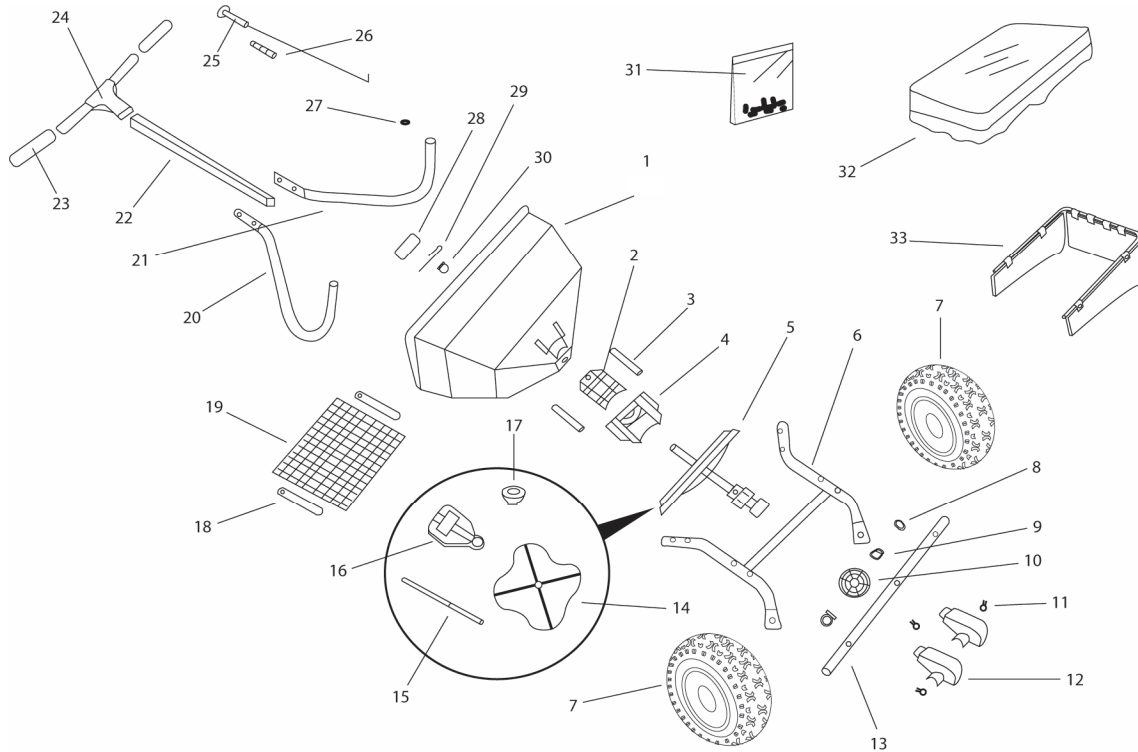

PART OF OUR SERVICE IS PROVIDING REPLACEMENT PARTS. Parts may be obtained through your local distributor. Be sure to give the following: 1) SPREADER MODEL NUMBER 2) SPREADER NAME 3) PART NUMBER 4) NAME OF PARTS AS SHOWN.

IF YOUR LOCAL DISTRIBUTOR CANNOT SUPPLY PARTS, CONTACT:

Meyer Products, Inc.
18513 Euclid Ave
Cleveland, Ohio 44112
216-486-1313

KEY	DESCRIPTION	PART #	KEY	DESCRIPTION	PART #
1	HOPPER	PSB15448	17	PINION GEAR	PSB14833
2	SHUT OFF PLATE	PSB15454	18	SCREEN CLIPS (2)	PSB14022
3	SHUT OFF PLATE GUIDE (2)	PSB15453	19	HOPPER SCREEN	PSB18128
4	CAM & CHUTE ASSEMBLY	PSB15450	20	HANDLE BRACE W/PLUG LH	PSB15852-04
5	IMPELLOR ASSEMBLY	PSB16288	21	HANDLE BRACE W/PLUG RH	PSB15853-04
6	FRAME ASSEMBLY	PSB15859	22	HANDLE TUBE	PSB15283-04
7	DRIVE & FREE TURNING WHEEL	PSB16282	23	HANDLE GRIPS	PSB15264
8	AXLE BUSHINGS (2)	PSB15860	24	T-HANDLE ASSEMBLY	PSB13634-2
9	AXLE COLLAR	PSB14063	25	CONTROL KNOB & WIRE ASS'Y	PSB15882
10	AXLE GEAR	PSB15027	26	CONTROL KNOB SPRING	PSB14462
11	GEAR COVER CLAMPS	PSB14868-1	27	WIRE RETAINING CLIP	PSB13643-1
12	GEAR COVER (2)	PSB15483	28	HOPPER PLUG	PSB15449
13	AXLE	PSB15858	29	AGITATOR	PSB33117
14	IMPELLOR	PSB15459	30	IMPELLOR SHAFT BEARING	PSB14312-1
15	IMPELLOR SHAFT	PSB15856-07	31	PARTS PACKAGE	PSB15864
16	GEAR SUPPORT	PSB15028	32	HOPPER COVER	PSB77003
			33	DEFLECTOR SHIELD	PSB60607