

GRAY MIP NON-SERVICEABLE BALL VALVE

PVC SCHEDULE 40 SOCKETS
 RATED @150 PSI @ 72°F STATIC PRESSURE
 VALVE BODY, BALL, HANDLE & STEM ARE PVC
 BUNA OR TEFLON BALL SEAT
 EPDM O-RING
 ABS CAP

IPS—IRON PIPE SIZE
 (SAME AS SCHEDULE 40 PIPE)
 FPT—FEMALE PIPE THREAD

2" AND SMALLER VALVES HAVE TWO-SIDED HANDLE
 6" VALVE HAS SINGLE LEVER HANDLE

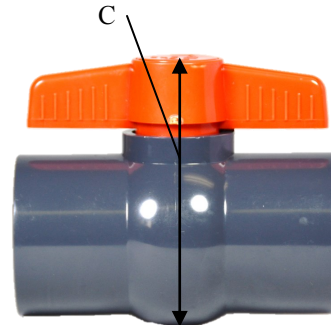
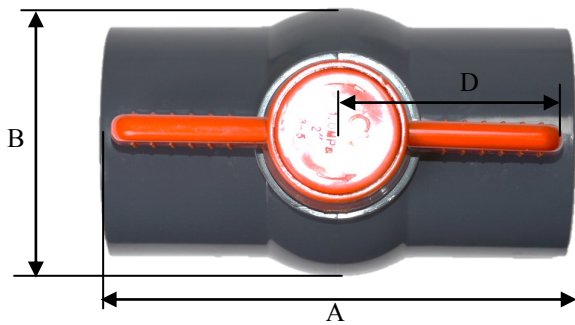

PART NUMBER		A (INCHES)	B (INCHES)	C (INCHES)	D (INCHES)	WEIGHT (LBS)	IPS CONNECTION
SLIP	FPT						
E1610-05	E1620-05	2.98	1.45	2.47	1.33	0.15	1/2" IPS
E1610-07	E1620-07	3.49	1.74	2.89	1.56	0.25	3/4" IPS
E1610-10	E1620-10	3.96	2.17	3.58	1.86	0.40	1" IPS
E1610-12	E1620-12	4.43	2.69	4.13	2.22	0.70	1 1/4" IPS
E1610-15	E1620-15	4.80	2.79	4.21	2.22	0.75	1 1/2" IPS
E1610-20	E1620-20	5.40	3.37	4.85	2.66	1.15	2" IPS
E1610-60	N/A	15.88	9.50	12.00	10.15	21.25	6" IPS