



In-field Cut and Reseal of PAL Lighting LED Strip

Applicable products:

Quick Ship Strip: 64-PAL-NFWB8-RGB-STE-XXXX | 64-PAL-NFLT8-RGB-STE-XXXX

Perimeter Strip Kit: 64-PAL-NFWB8-RGB-STE-XXXFT | 64-PAL-NFLT8-RGB-STE-XXXFT

PAL Lighting, LLC LED Strip lighting is manufactured with a factory-sealed connection, providing a waterproof seal. Strip lighting that has been cut to size and resealed for a specific customer is non-returnable and void of warranty, in the event of damage by water intrusion or submersion. In-field cutting and resealing is possible by following the instructions below; however, we recommend ordering LED strip lighting to your required lengths to ensure factory-sealed connections. All field cutting and capping of PAL Lighting strip lighting products is done so at the risk of the installer. **AT NO POINT SHOULD THE LED STRIP LIGHT BE FULLY SUBMERGED.**

NOTE: Before cutting, connect the strip to the driver (transformer + controller) and power it on. Verify proper operation by cycling through colors and testing the dimming range.

Step 1: Cutting the Strip

- Always disconnect power before cutting.
- Find Cut Points – Look for a dark line between copper pads on the strip.
- Measure Carefully – Mark the closest safe cut point to your desired length.
- Make a Clean Straight Cut – use a utility knife on a flat, hard surface; avoid crushing or tearing the silicone.

Side View

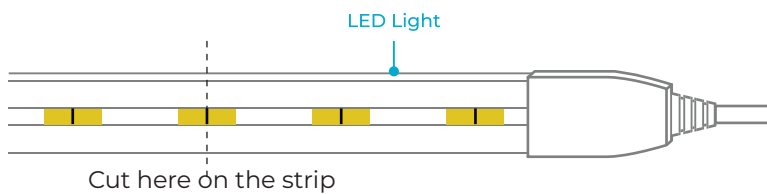

Top View

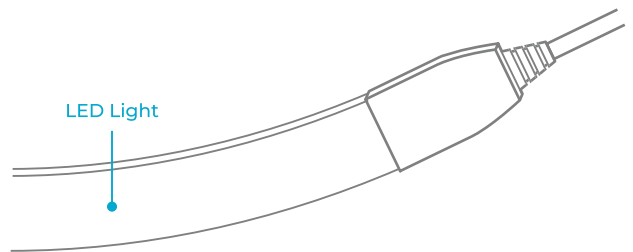

Step 2: Resealing the Strip

- Apply Provided Waterproof Sealant – Coat the cut end with PROVIDED silicone sealant to close all gaps.
- Install End Cap
 - Fill end cap at least 50% with silicone sealant. Slide on end cap and seal around it with more sealant.
- Cure Time – Let silicone cure for 24 hours.

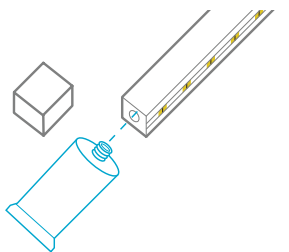

Apply silicone into the small hole on the cut end.

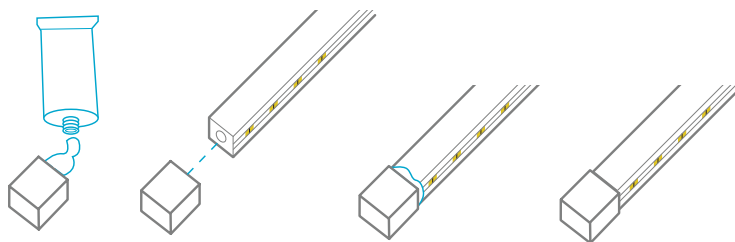

Apply silicone into the end cap and secure tightly to the strip. Make sure there are no air bubbles. Remove excess silicone by smoothing out run-off sealant.

MUST USE PAL LIGHTING SEALANT 64-PAL-NF-GLUE
No other silicone / sealant is approved for use.

Additional Tips and Warnings:

- **Test Before Final Install** – Ensure the strip functions after resealing.
- **DO NOT submerge LED strip under water.** These strips are designed to be near water but not fully submerged.
- **DO NOT TWIST STRIP** – Strip lighting is designed to bend side to side or up and down. NEVER bend in opposite direction or twist, this may result in LED strip breaking

Seek Help If Needed – For complex jobs, contact PAL Lighting (713 946-4343) to manage all strip cuts/seals.



PAL Lighting – 3-Year Warranty (Customer Summary)

PAL Lighting stands behind the quality of our products. Every PAL pool, spa, fountain, and strip light is backed by a 3-Year Warranty.

What's Covered:

- Parts: if your product stops working due to a manufacturing defect.
- Coverage for three (3) years from the date of installation for strip, excluding water intrusion or submersion damage.
- Applies to products purchased from authorized PAL dealers, pool builders, and service companies.

How It Works:

1. Keep your proof of purchase.
2. If you experience a problem, contact your dealer or PAL Lighting directly.
3. We'll repair, replace, or refund the product at our discretion.

Peace of Mind:

This warranty gives you specific rights and works alongside your local consumer protection laws, which may give you additional protections. If your PAL light fails due to a defect within 3 years, we've got you covered.

Limited Warranty Statement:

PAL Lighting ("PAL") warrants to the original purchaser that its lighting products, when installed in a pool or spa environment and operated under normal conditions and in accordance with PAL's published installation and operating instructions, will be free from defects in materials and workmanship for a period of three (3) years from the date of installation.

This Limited Warranty includes parts for qualifying claims, subject to the terms below.

Products Covered: Pool and Spa Lights / Fountain and Water Feature Lights / LED Strip Lights.

Eligibility Requirements:

- Products must be purchased directly from an authorized retailer, licensed pool builder, or professional pool service company.
- Products purchased from unauthorized online sellers or unapproved resellers are not covered.
- A valid proof of purchase (original invoice or bill of sale) must accompany all claims.
- Products must be installed at the same residential property as listed on the proof of purchase.
- Warranty is valid for the original purchaser only and is non-transferable unless otherwise decided at PAL Lightings discretion.

Exclusions and Limitations:

Improper installation, handling, or storage.

- Negligence, misuse, abuse, or failure to follow PAL's instructions.
- Unauthorized modifications, alterations, or repairs.
- Use with incompatible power sources, drivers, or control systems.
- Incorrect voltage, electrical surges, or installation methods not approved by PAL.

This Warranty does not cover damage, defects, or failures caused by...

Physical damage (impact, crushing, stepping on components).

- Improper mounting, bending, twisting, or kinking of components.
- Exposure to chemicals, moisture, or sunlight beyond the product's rated tolerances (e.g., IP rating, chlorine concentration, UV resistance limits).
- Cosmetic issues such as fading, discoloration, or surface scratches that do not affect product function.

Field Cutting of LED Strip Lights:

PAL permits strip lights to be cut to custom lengths. However, warranty coverage does not cover submersion or water intrusion due to installation error

Warranty Claims Process:

1. Customer must contact PAL or the authorized reseller where the product was purchased.

Telephone: +1 (713) 946 4343 (USA) | +61 (2) 9531 1555 (Australia / rest of the world)
 Web: <https://pallighting.com/contact-us>
 Warranty form: <https://pallighting.com/faulty-goods-return/>

2. Customer must provide proof of purchase and a description of the defect.
3. PAL may require inspection, photographs or return of the product. Shipping costs will be covered by PAL for all approved warranty claims. Where a claim is declined due to exclusions and limitations, any shipping costs for replacement parts or repairs will be charged to the customer.
4. If a claim is accepted, PAL will, at its sole discretion:
 - o Repair the defective product,
 - o Replace the defective product with the same or a comparable model, or
 - o In rare occasions, refund the purchase price (less reasonable depreciation, if applicable).

Limitations of Liability:

- This Warranty is limited to the repair or replacement of the defective product or in rare occasions refund of purchase price.
- PAL shall not be liable for any indirect, incidental, special, or consequential damages, including but not limited to property damage, water damage, labor charges for removal/reinstallation, or loss of use.
- Warranty remedies are the exclusive remedies available to the customer.

Consumer Rights:

This Limited Warranty provides specific legal rights. Some jurisdictions don't allow the exclusion or limitation of incidental or consequential damages, so certain limitations may not apply. This Warranty is offered in addition to, and does not limit, any rights the purchaser may have under applicable consumer protection laws (inc. mandatory statutory guarantees).

Governing Law:

This Warranty shall be governed by and construed in accordance with the laws of the jurisdiction in which the product was purchased. Any disputes arising from this Warranty shall be subject to the exclusive jurisdiction of the courts in that jurisdiction.

