

**SE Spa Electrics®**

***retro***®

REPLACEMENT LED POOL LIGHT



**POOL LIGHT  
1½" THREAD INSTALL**

**T1**

**R1 - 1½" THREAD  
INSTALLATION & OWNER'S MANUAL**

# CONTENTS

READ THIS FIRST	3
TOOLS REQUIRED	4
INCLUDED PARTS	5
INSTALLATION	A: CONNECTION TO CABLE 6
	B: LIGHT ASSEMBLY 13
RIM & SLEEVE REMOVAL	19
RIM & SLEEVE INSTALL	20
WINTERIZATION	22
KEY DIMENSIONS	27
TROUBLESHOOTING	28
ELECTRICAL GROUNDING	29
FCC COMPLIANCE STATEMENT	29

## IMPORTANT



A **12V AC** TRANSFORMER MUST BE INSTALLED.  
DC POWER SUPPLIES ARE NOT COMPATIBLE.

## NOTE



FRESH WATER USE ONLY  
NOT INTENDED FOR OPERATION OUT OF WATER

# PRE-INSTALLATION CHECK

## 1 CHECK POWER SUPPLY

**1A:** IF THE POOL LIGHTS ARE DIRECTLY CONNECTED TO A 120V POWER SUPPLY, DO NOT CONTINUE INSTALLATION.

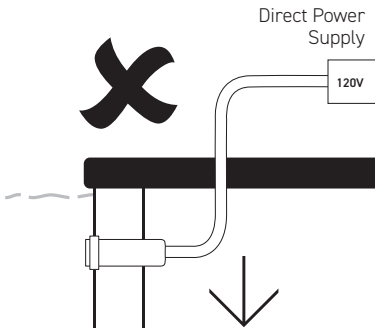

**1B:** A 12V AC TRANSFORMER **MUST** BE INSTALLED BETWEEN THE 120V POWER SUPPLY AND POOL LIGHT.

**2A:** IF THE POOL LIGHTS ARE CONNECTED TO A TRANSFORMER CHECK THAT IT MEETS STEP 2 REQUIREMENTS.

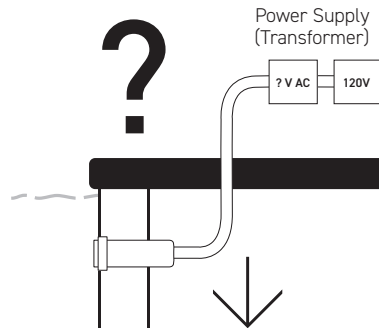

**2B:** IF THE TRANSFORMER DOES NOT MEET THE REQUIREMENTS, IT WILL REQUIRE REPLACEMENT.

## 2 ADD TRANSFORMER (IF NEEDED)

### EXISTING TRANSFORMER MUST BE:

- UL Listed Isolating Low Voltage power supply, evaluated for swimming pool use
- Installed as per current NEC wiring rules
- 12~14v AC output
- Minimum 8w per **Retro T1** light
- In good working order

### EXISTING TRANSFORMER MUST NOT BE:

- DC or 'LED Driver'
- Electronic or Switch mode
- Weather damaged or in otherwise poor condition

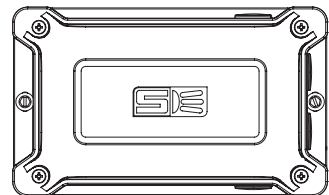

Spa Electric recommends "LVX" safety transformers for use with **Retro T1** lights

(LVX 50 & LVX 100)

# PRE-INSTALLATION CHECK

## 3 CHECK CABLE THICKNESS

RETRO T1 CAN BE FITTED TO CABLES FROM 9/32" (7MM) UP TO 15/32" (12MM) DIAMETER.

Max  $\emptyset$   
15/32 inch  
(12mm)



## 4 CHECK FITTING TYPE

THIS SPA ELECTRICS RETRO T1 LIGHT IS DESIGNED TO BE INSTALLED IN A 1 1/2" SCH40 THREADED BULKHEAD IN EITHER A FIBERGLASS, VINYL OR CONCRETE POOL.

SEE THE FOLLOWING ILLUSTRATIONS OF EXAMPLES FOR REFERENCE ONLY.

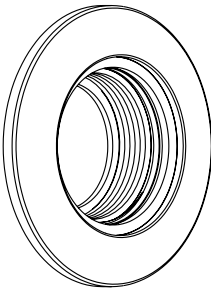

**FIBERGLASS**

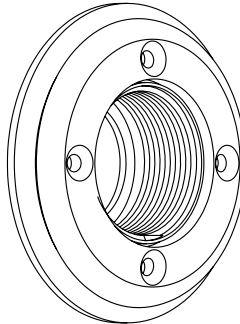

**VINYL**

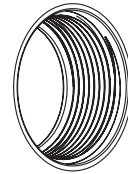

**CONCRETE**

THE FOLLOWING INSTALLATION INSTRUCTIONS SHOW AN EXAMPLE OF A FIBERGLASS BULKHEAD.

# READ THIS FIRST

Congratulations on your purchase of a Spa Electrics **Retro T1** Series Pool Light. This light has been designed in conjunction with leading pool professionals across the USA and manufactured solely in Australia.

The **Retro T1** Series light is designed to quickly and easily replace existing LOW VOLTAGE, nicheless light fittings (1 ½" Sch40 threaded fittings) from major brands.

**For safe and proper installation, please read this manual in full before commencing installation and use only the parts (screws, plugs, sealant etc) as provided.**

**For operating instructions, please refer to the MULTI PLUS Installation & User Guide.**

- For safe and proper installation, ensure that only those parts supplied with the system are used.
- Maximum installation depth for the **Retro T1** light is 20" below water line (to top of light).
- The **Retro T1** light must be correctly installed in or on the wall of the pool with the top of the lens no less than **4"** below the nominal water level.
- All lights should be mounted in a location that is easily accessible without the need for entering or lowering the pool water.
- If cleaning the product is required, only use warm water and a soft brush or cloth to clean **Retro T1** lights. **DO NOT** use detergents or spirits as this can damage the light and void your warranty.
- Operating the light for at least 15 minutes every week is advised (unless removed and stored safely for winter months).
- **Retro T1** lights are suited for both domestic and commercial installations and can be operated continuously (24/7) if required.
- Temperature range for installation, operation and servicing: +32°F ~ +104°F (0°C ~ +40°C)

## WARNING



- The **Retro T1** Light must be water cooled at all times. DO NOT switch the light on until installation is complete and the light is fully submerged in water.
- Ensure only circular cable not exceeding 15/32" (12mm) diameter is connected to the **Retro T1** Light. The use of Fig. 8 or non circular cable will not seal correctly & will void the product warranty.
- The **Retro T1** LED Light does not contain any user serviceable parts, opening the light will void the product warranty.
- Pool chemicals & PH levels: Due to the corrosive nature of unbalanced pool chemicals, Spa Electrics strongly recommend that your pool water is balanced prior to installing your pool Lights or any plastic or stainless steel components, and tested weekly to maintain these levels. pH levels should be maintained between 7.2- 7.6 at all times to ensure the longevity of these components.
  - Failure to do so can result in chemical damage to the light housing and pool fittings, including stainless steel components.
  - Please note: Lights or components found to have excessive chemical damage will not be covered under our manufacturer's warranty policy

## TOOLS REQUIRED

✓ Draw wire

✓ Small flat-blade screw driver

✓ Pliers or side cutters

## IMPORTANT NOTES



- The use of power tools during installation is **not** recommended as these devices can cause faults and damage to light components.
- All installation steps should be carried out with manual tools only.
- The enclosed images are for illustrative purposes only. Appearances of parts and assemblies may vary from the enclosed illustrations
- Please contact Spa Electrics or contact us below if you have any questions regarding the correct installation of this product.

## PRODUCT SUPPORT AND INFORMATION

For the most up to date installation information and contact information for assistance in your region, please visit [www.spaelectrics.com](http://www.spaelectrics.com)

# INCLUDED PARTS

## CABLE ASSEMBLY (P/N: T1 18AWG 0.5)

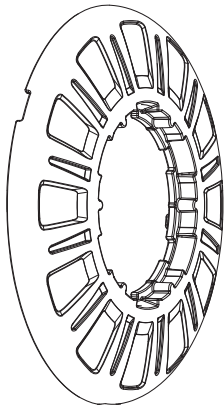
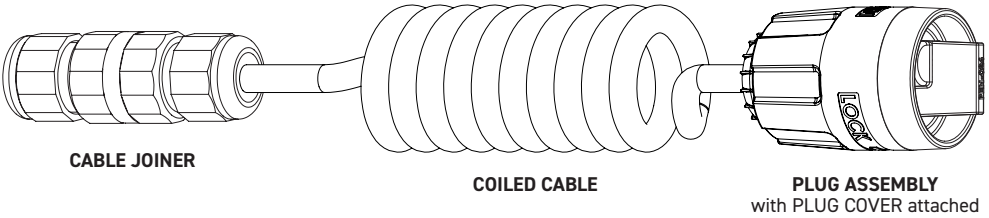

**LARGE RIM**  
typically used for Fiberglass  
& Vinyl fitments  
(P/N: T1FV 004)  
also included

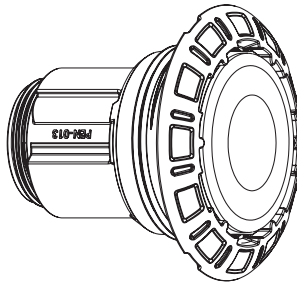

**LIGHT ASSEMBLY**  
with SMALL RIM typically used for  
Concrete fitments  
(P/N: T1C 004)  
& THREADED SLEEVE (P/N: T1 017)  
attached

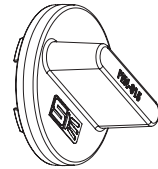

**LIGHT INSTALLATION  
TOOL**  
(P/N: T1 016)

## REQUIRED PART (NOT INCLUDED)



### UL LISTED ISOLATING LOW VOLTAGE POWER SUPPLY, EVALUATED FOR SWIMMING POOL USE.

Installed as per current NEC wiring rules. 12~14v AC output. Minimum 8W per Retro Series Pool Light. Spa Electrics recommends "LVX" safety transformers for use with Retro Universal lights

# A: CONNECTION TO CABLE

**STOP! WARNING  
ELECTROCUTION**

CHECK POWER  
IS TURNED OFF  
FIRST

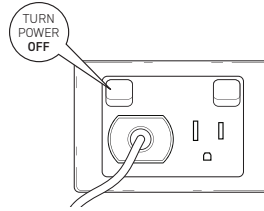

## 1 REMOVE EXISTING LIGHT

- 1: REMOVE EXISTING LIGHT FROM BULKHEAD/ PIPE AND BRING ABOVE THE WATER LINE.
- 2: CUT POWER CABLE AS CLOSE TO BACK OF EXISTING LIGHT AS POSSIBLE.

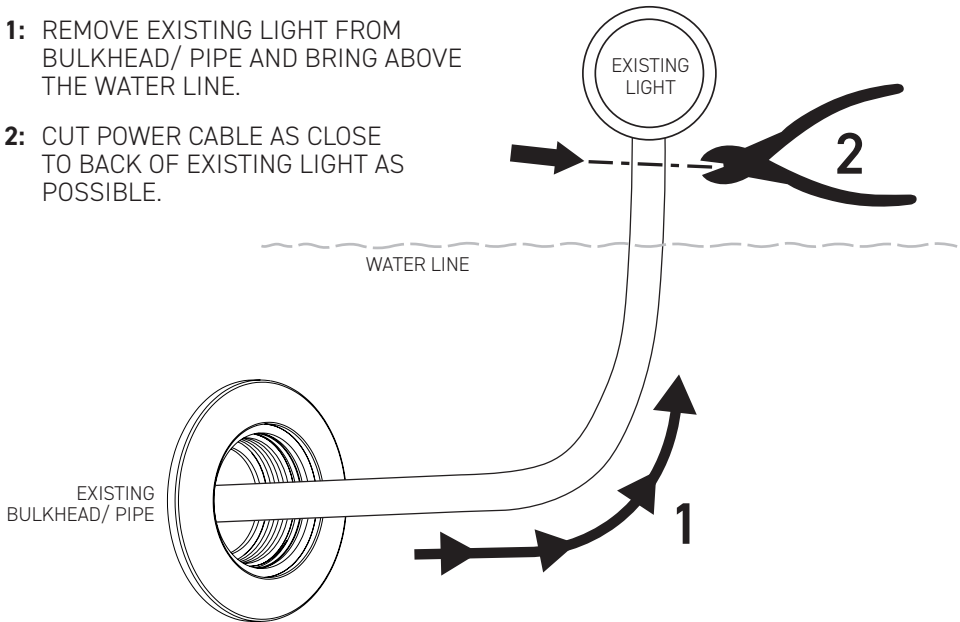

### NOTE



IF EXISTING CABLE IS NOT LONG ENOUGH TO BRING ABOVE WATER LINE, THE CABLE WILL NEED TO BE DRAWN THROUGH CONDUIT/PIPE. ENSURE APPROPRIATE MEASURES ARE TAKEN TO PULL BACK CABLE FOR RE-CONNECTION.

**ALL CABLE CONNECTIONS ARE TO BE DONE AT SURFACE LEVEL,  
AND OUT OF WATER.**

# 2

## CABLE PREPARATION

STRIP THE END OF EXISTING POWER CABLE TO SPECIFIED LENGTH.

### NOTE



IF CABLE LENGTH ALLOWS, CUT CABLE BACK UNTIL FRESH COPPER APPEARS.

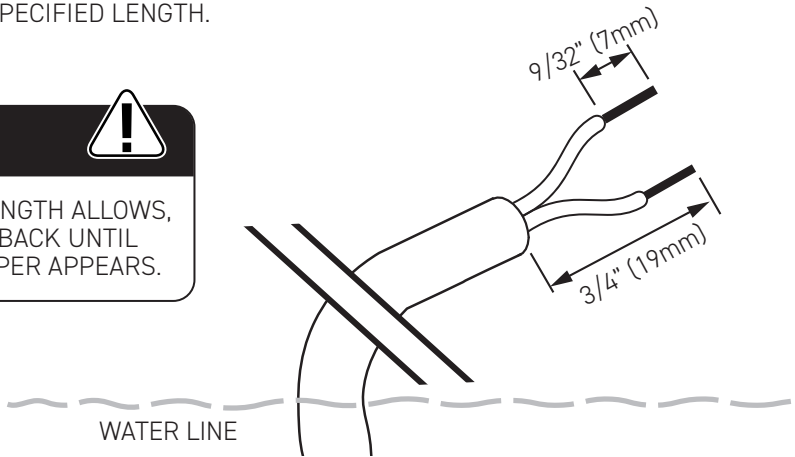

# 3

## DISASSEMBLE CABLE JOINER

**1:** ON THE SUPPLIED CABLE ASSEMBLY, STARTING FROM THE OPEN END, LOOSEN THE FIRST PART OF THE CABLE JOINER BY TWISTING THE INDICATED NUT ANTI-CLOCKWISE A FEW TIMES UNTIL IT IS FREE SPINNING.

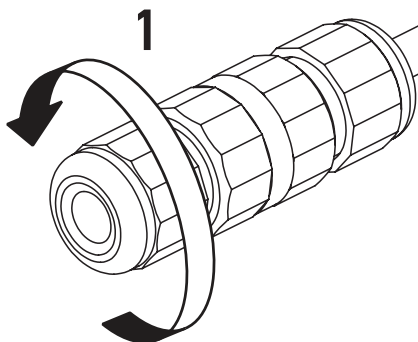

**2:** PULL OFF THE NUT AS INDICATED.

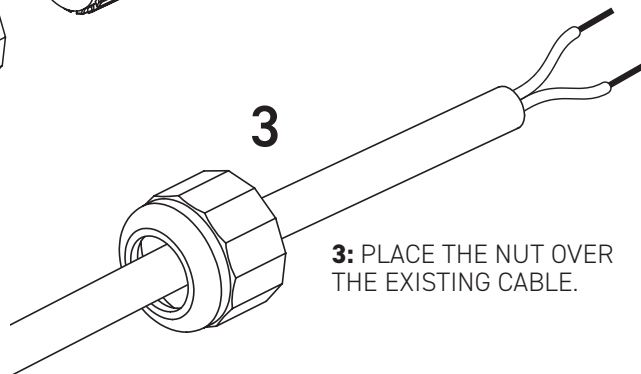
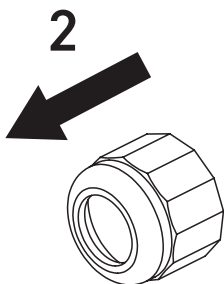

**3:** PLACE THE NUT OVER THE EXISTING CABLE.

**4:** LOOSEN THE SECOND PART OF THE CABLE JOINER BY TWISTING THE INDICATED NUT ANTI-CLOCKWISE A FEW TIMES UNTIL IT IS FREE SPINNING.

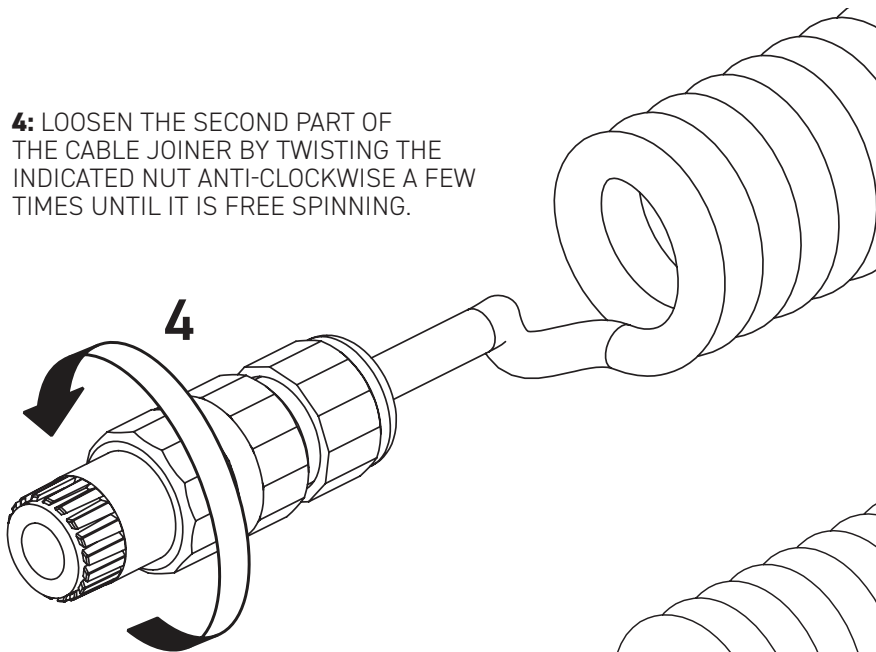

**5:** PULL OFF THE NUT WITH GROMMET INSIDE AS INDICATED.

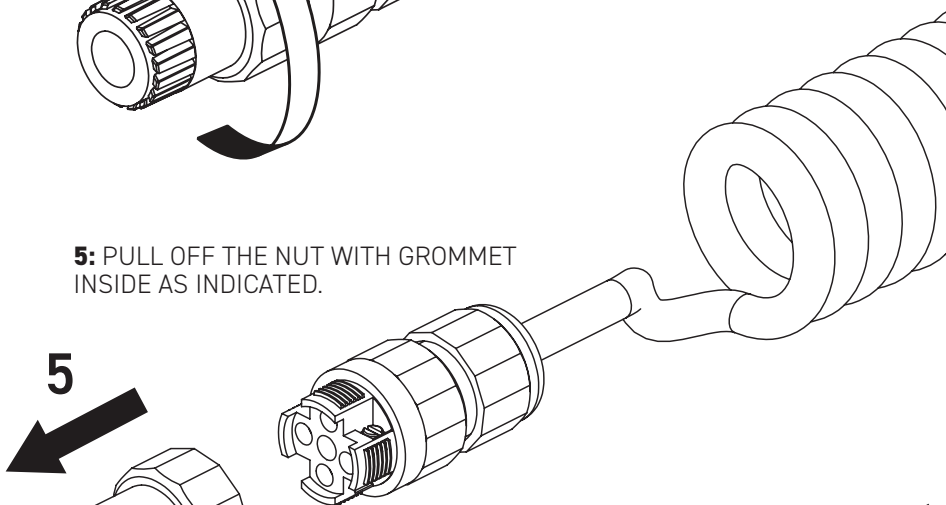

6

**6:** PLACE THE NUT WITH GROMMET OVER THE EXISTING CABLE.

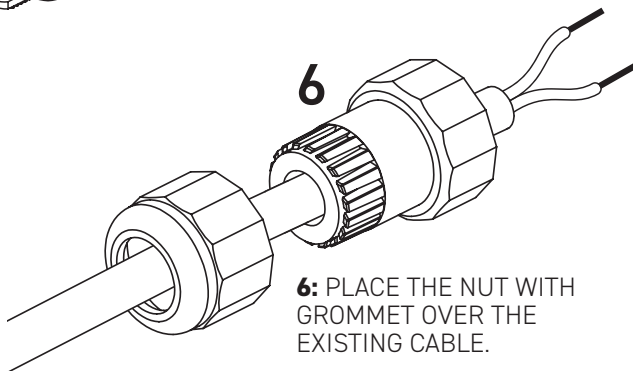

# 5

## ATTACH EXISTING CABLE TO JOINER

- 1: USE A FLAT BLADE SCREWDRIVER TO LOOSEN THE FASTENERS ON EITHER SIDE OF THE CABLE JOINER.
- 2: FEED THE TWO STRIPPED ENDS OF THE EXISTING CABLE INTO THE METAL TERMINALS IN THE CABLE JOINER.

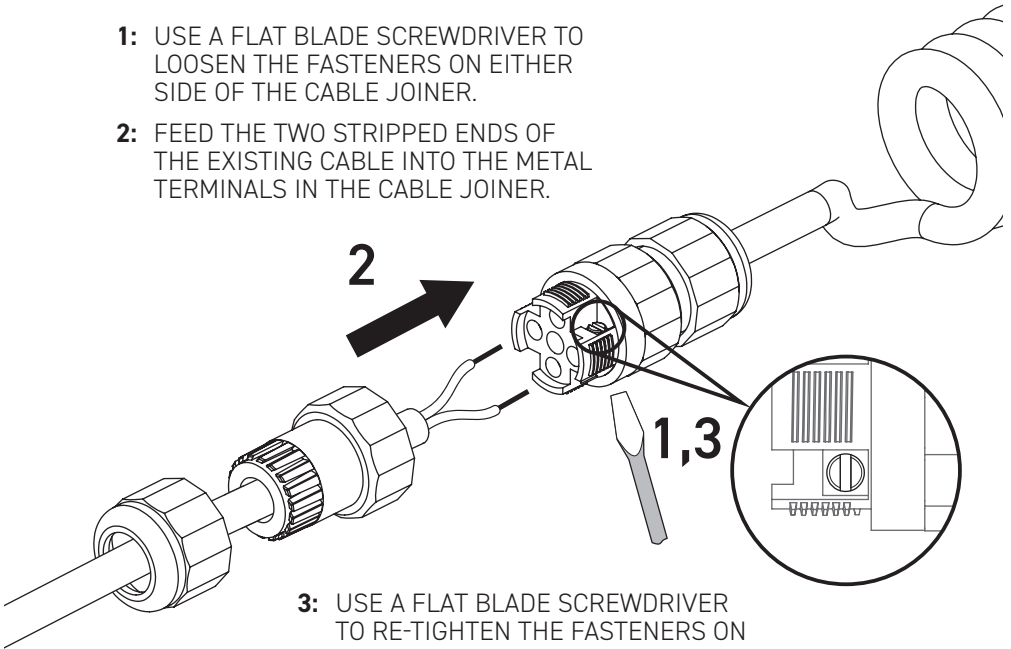

- 3: USE A FLAT BLADE SCREWDRIVER TO RE-TIGHTEN THE FASTENERS ON EITHER SIDE OF THE CABLE JOINER.

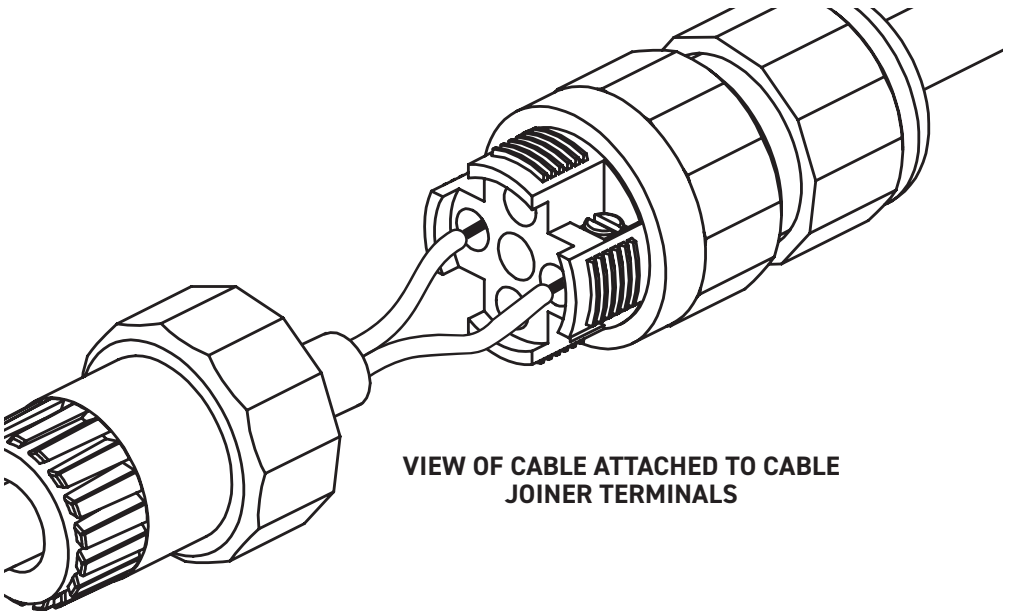

# 6

## REASSEMBLE CABLE JOINER

**1:** FEED THE NUT WITH GROMMET BACK ONTO THE CABLE JOINER.

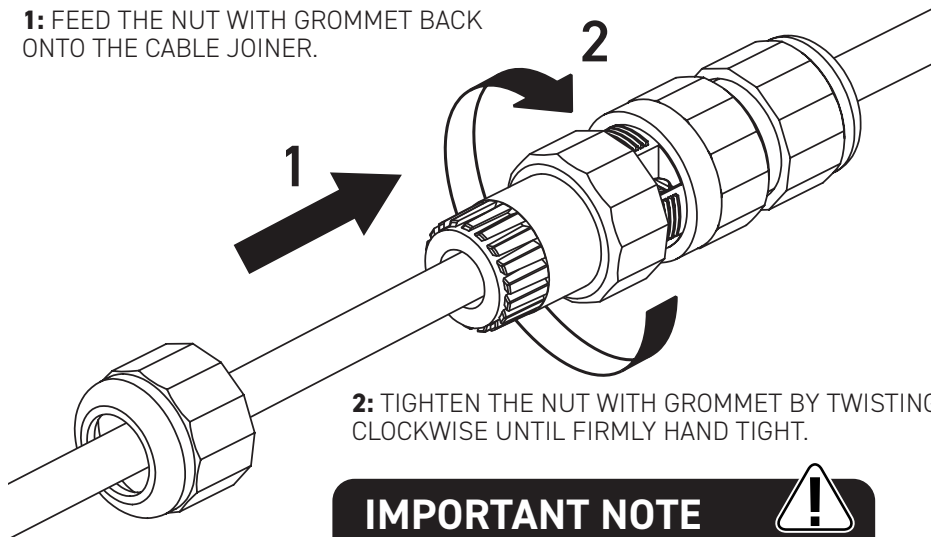

**2:** TIGHTEN THE NUT WITH GROMMET BY TWISTING CLOCKWISE UNTIL FIRMLY HAND TIGHT.

### IMPORTANT NOTE



ENSURE NUT IS NOT CROSS-THREADED AND EVENLY SEATED ONCE RE-ATTACHED.

# 7

## REASSEMBLE CABLE JOINER ...CONTINUED

**1:** FEED THE NUT BACK ONTO THE CABLE JOINER.

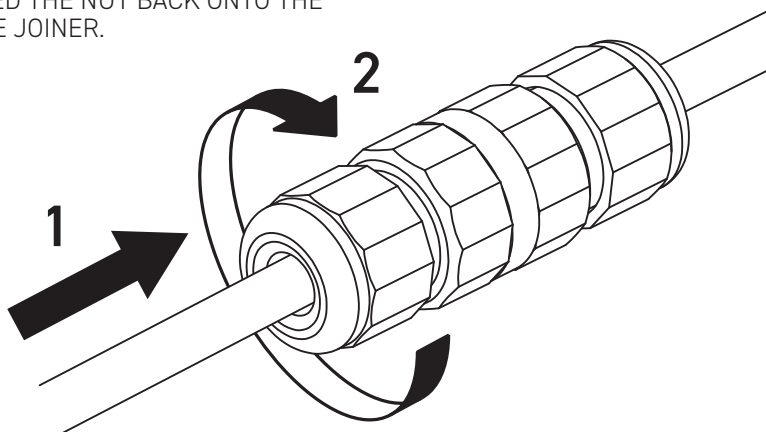

**2:** TIGHTEN THE NUT BY TWISTING CLOCKWISE UNTIL FIRMLY HAND TIGHT.

# 8

## REASSEMBLE CABLE JOINER ...CONTINUED

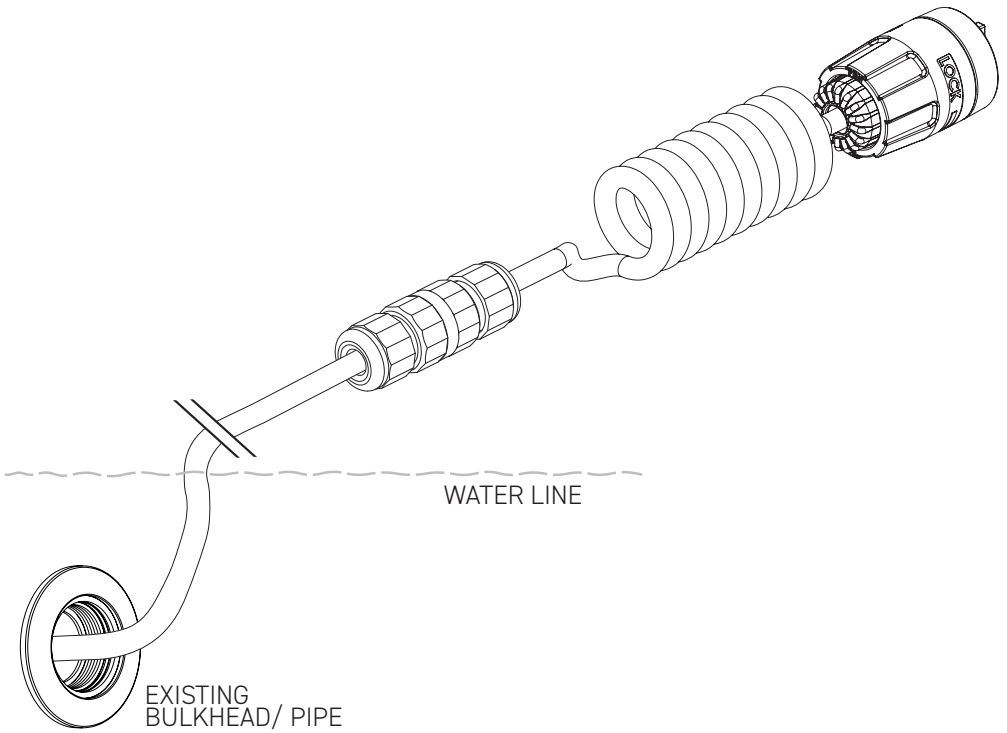

**VIEW OF COMPLETED CABLE ASSEMBLY  
ATTACHED TO EXISTING CABLE.**

## B: LIGHT ASSEMBLY

BEFORE ATTACHING THE LIGHT ASSEMBLY TO THE CABLE, CONSIDER WHICH OF THE TWO SIZES OF INCLUDED RIMS YOU WISH TO USE.

BOTH RIMS CAN BE USED FOR ANY INSTALLATION TYPE BUT, DEPENDING ON THE EXISTING BULKHEAD AND POOL WALL, YOU MAY WISH TO USE ONE OVER THE OTHER.

BY DEFAULT THE LIGHT ASSEMBLY COMES WITH THE SMALLER RIM ATTACHED WHICH IS TYPICALLY USED FOR CONCRETE FITMENTS.

IF YOU WISH TO CHANGE TO THE LARGER RIM WHICH IS TYPICALLY USED FOR FIBERGLASS & VINYL FITMENTS, PLEASE FOLLOW THE "RIM & THREADED SLEEVE REMOVAL" AND "RIM & THREADED SLEEVE INSTALL" STEPS IN THIS INSTALLATION GUIDE.

THESE STEPS WILL GUIDE YOU THROUGH REMOVING THE PRE-ATTACHED SMALLER RIM AND REPLACING IT WITH THE LARGER SIZED RIM.

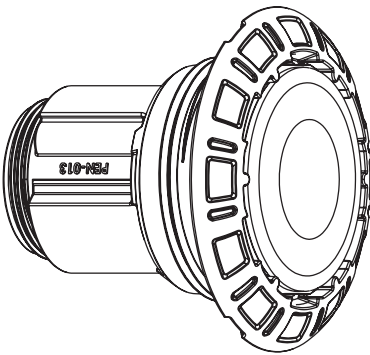

**VIEW OF LIGHT ASSEMBLY WITH SMALL RIM ATTACHED.**

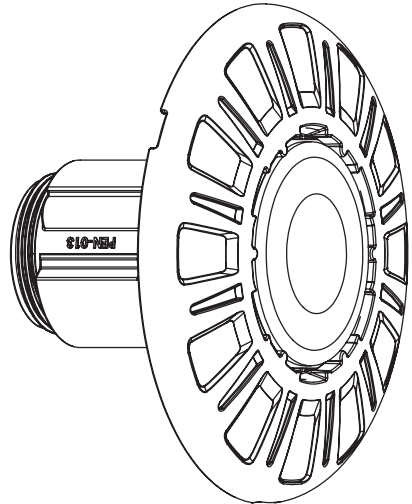

**VIEW OF LIGHT ASSEMBLY WITH LARGE RIM ATTACHED.**

# 1

## REMOVE PLUG COVER

WHEN READY TO ATTACH THE LIGHT ASSEMBLY, REMOVE THE PLUG **COVER** BY TWISTING THE **COLLAR** ANTI-CLOCKWISE A FEW TIMES UNTIL IT IS FREE SPINNING.

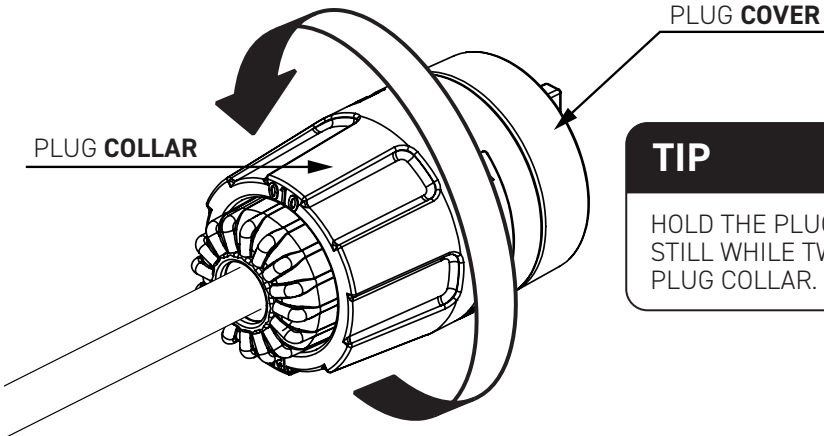

### TIP



HOLD THE PLUG COVER STILL WHILE TWISTING THE PLUG COLLAR.

# 2

## REMOVE PLUG COVER

DISCONNECT PLUG COVER FROM PLUG BY PULLING APART.

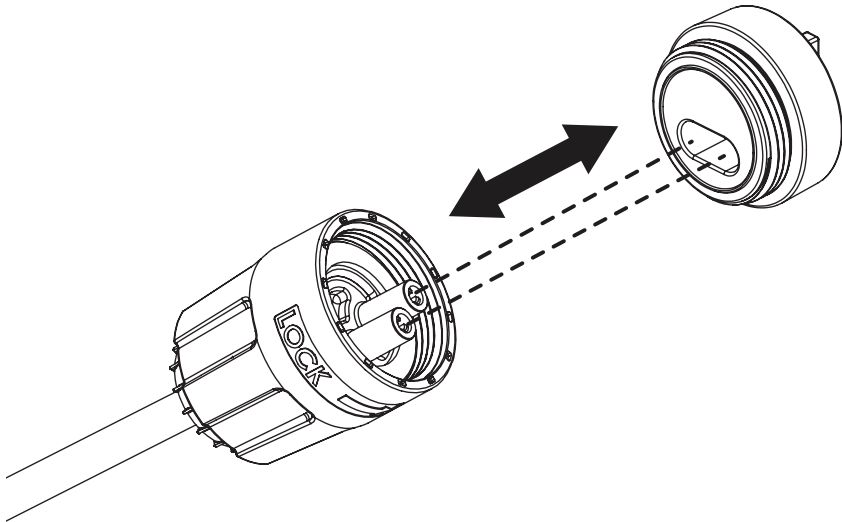

### 3

## CONNECT THE TERMINALS

ALIGN THE TERMINAL PINS ON THE PLUG AND BACK OF THE LIGHT ASSEMBLY AND FIRMLY CONNECT TOGETHER.

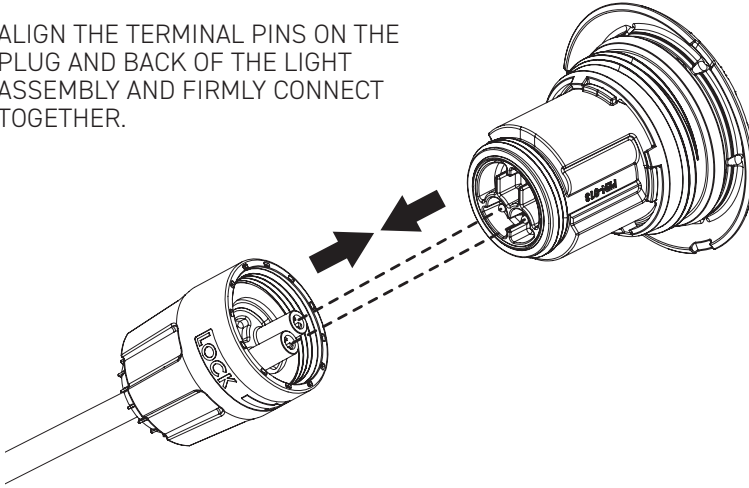

### 4

## FASTEN PLUG TO LIGHT

TO LOCK INTO PLACE:  
TWIST COLLAR CLOCKWISE A FEW  
TIMES UNTIL IT'S HAND TIGHT.

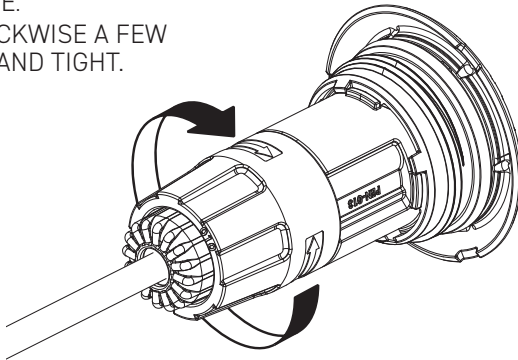

# 5

## FEED FULL ASSEMBLY INTO BULKHEAD

FEED FULL ASSEMBLY WITH LIGHT, CABLE, CABLE JOINER, AND EXISTING CABLE INTO THE BULKHEAD FITTING.

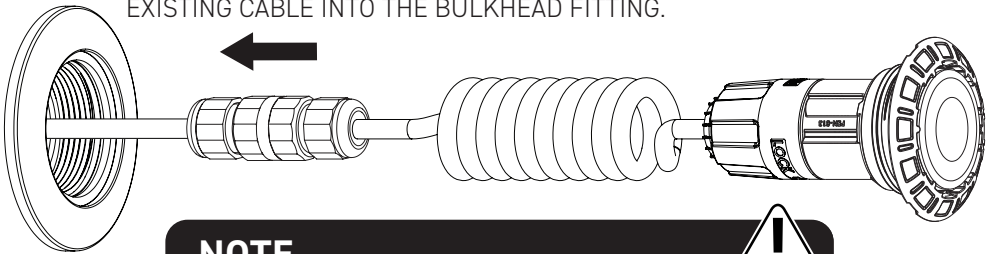

### NOTE



IF FITMENT INTO THE PIPE IS TIGHT, ROTATING THE COILED CABLE SECTION CLOCKWISE WILL HELP PROVIDE CLEARANCE TO THE PIPE.

# 6

## THREAD LIGHT INTO BULKHEAD FITTING

1. JUST BEFORE FULLY INSERTING THE LIGHT INTO THE BULKHEAD, ROTATE THE LIGHT CLOCKWISE A COUPLE TURNS.
2. INSERT THE LIGHT INSTALLATION TOOL INTO THE FRONT OF THE LIGHT ASSEMBLY, ALIGNING THE TEETH ON THE TOOL WITH THE SLOTS ON THE RIM.
3. TWIST THE LIGHT ASSEMBLY WITH THE TOOL CLOCKWISE INTO THE BULKHEAD FITTING UNTIL FIRMLY HAND TIGHT.

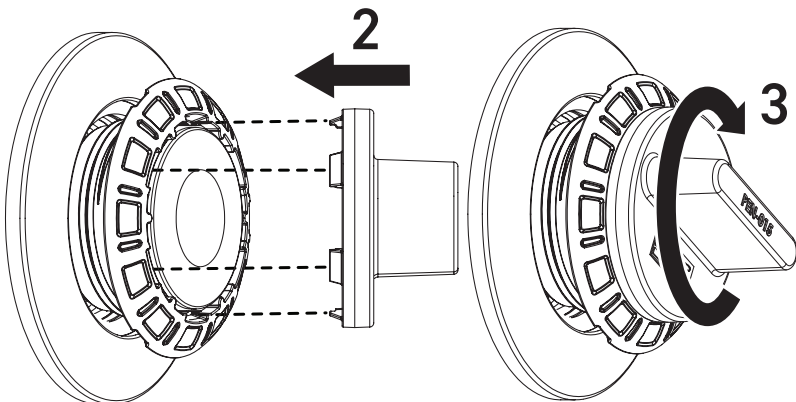
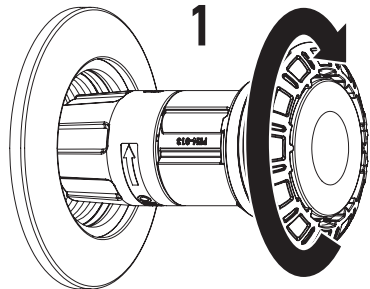

# RIM & THREADED SLEEVE REMOVAL

## 1 REMOVE THREADED SLEEVE

1. INSERT THE LIGHT INSTALLATION TOOL INTO THE FRONT OF THE LIGHT ASSEMBLY. ALIGNING THE TEETH ON THE TOOL WITH THE SLOTS ON THE RIM.
2. HOLD THE LOCKING TOOL SO THE LIGHT ASSEMBLY DOES NOT ROTATE WHEN REMOVING THE THREADED SLEEVE IN STEP 3 BELOW.

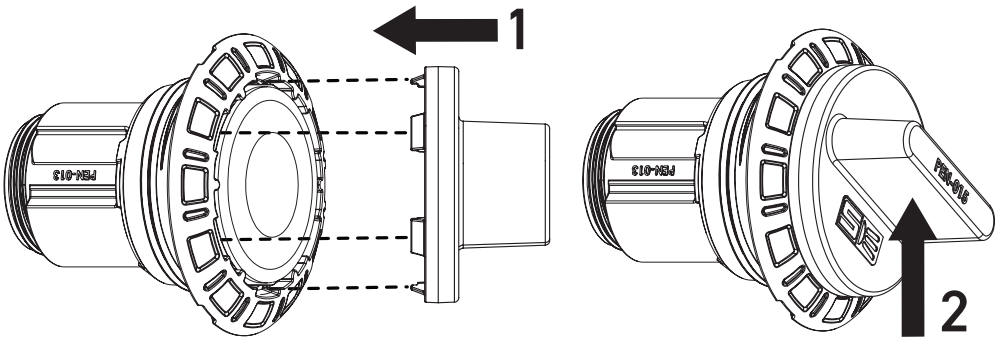

3. TWIST THE THREADED SLEEVE ANTI-CLOCKWISE TO UNLOCK IT.
4. THEN SLIDE THE SLEEVE OFF THE LIGHT ASSEMBLY.

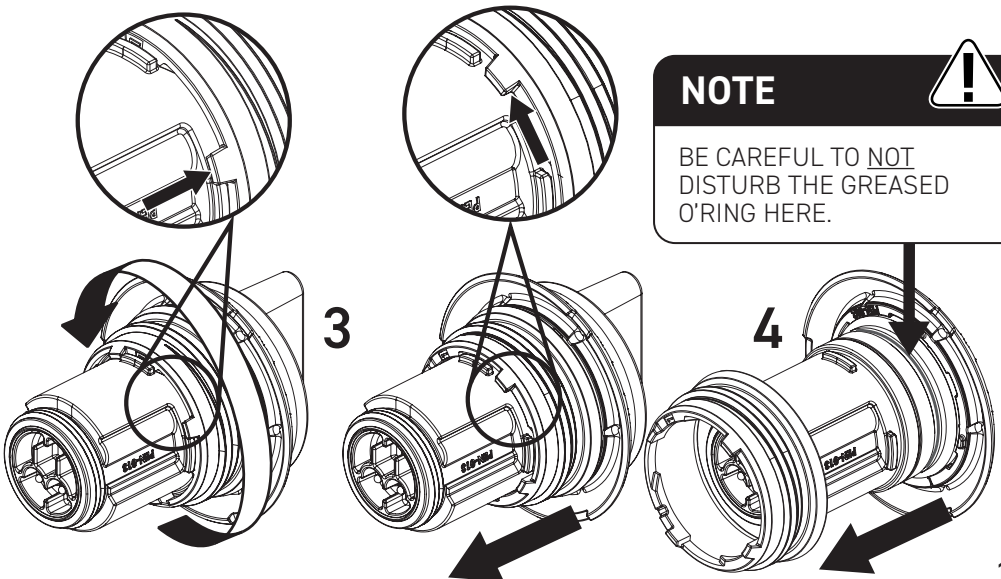

## 2

## REMOVE RIM

WITH THE SLEEVE REMOVED, THE RIM CAN BE CLIPPED OFF THE LIGHT ASSEMBLY. REMOVE THE RIM BY HAND ONLY.

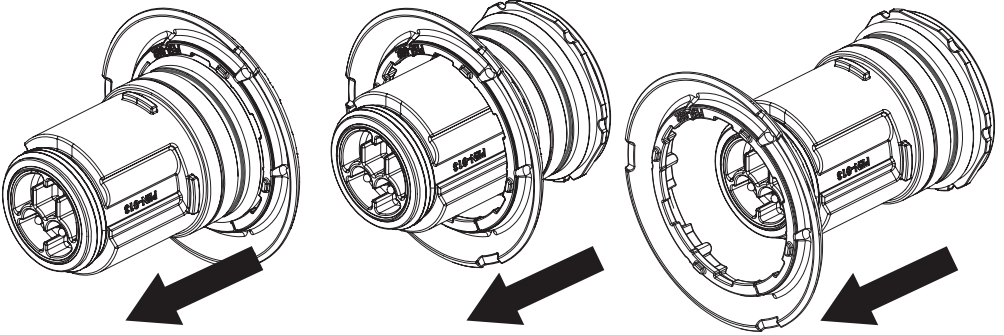

## RIM & THREADED SLEEVE INSTALL

## 1

## ATTACH RIM

ALIGN THE RIM AND SLIDE IT OVER THE LIGHT ASSEMBLY UNTIL IT SNAPS INTO PLACE AND IS FULLY SEATED AS INDICATED. DO THIS BY HAND ONLY.

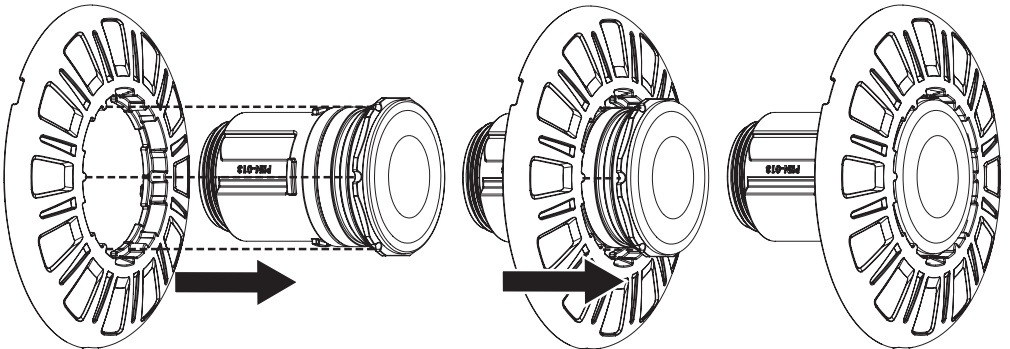

**NOTE THE INDICATED ALIGNMENT POINTS ON THE RIM AND LIGHT ASSEMBLY.**

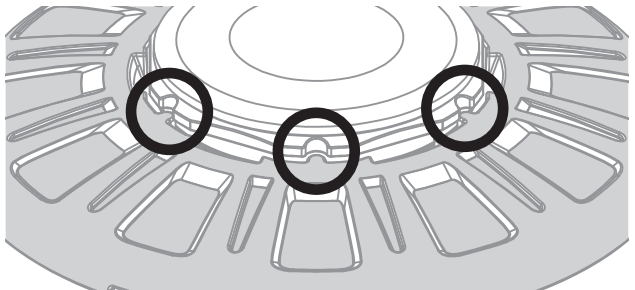

## 2

# ATTACH THREADED SLEEVE

1. INSERT THE LIGHT INSTALLATION TOOL INTO THE FRONT OF THE LIGHT ASSEMBLY. ALIGNING THE TEETH ON THE TOOL WITH THE SLOTS ON THE RIM.
2. HOLD THE LOCKING TOOL SO THE LIGHT ASSEMBLY DOES NOT ROTATE WHEN ATTACHING THE THREADED SLEEVE IN STEP 4 BELOW.

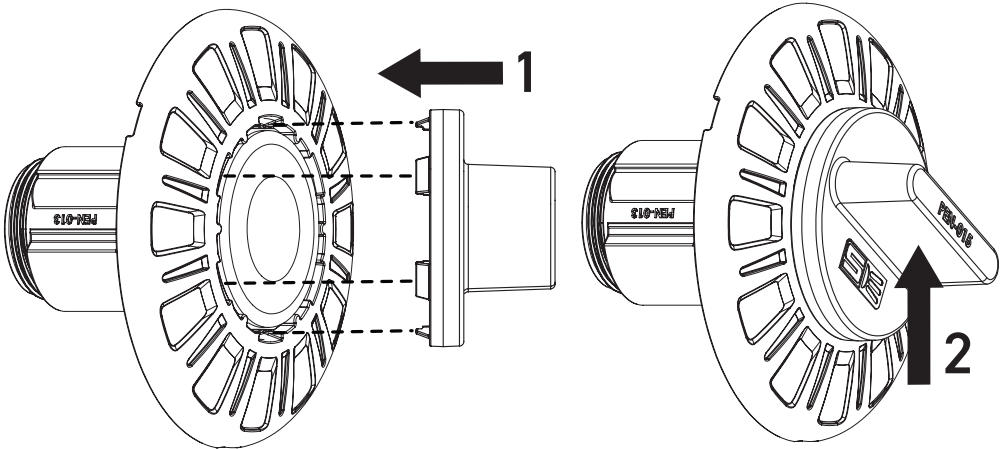

3. TWIST THE THREADED SLEEVE CLOCKWISE TO LOCK IT. NOTE THE POSITION OF THE INDICATED TAB.
4. SLIDE THE THREADED SLEEVE ONTO THE LIGHT ASSEMBLY.

### NOTE



BE CAREFUL TO NOT DISTURB THE GREASED O'RING HERE.

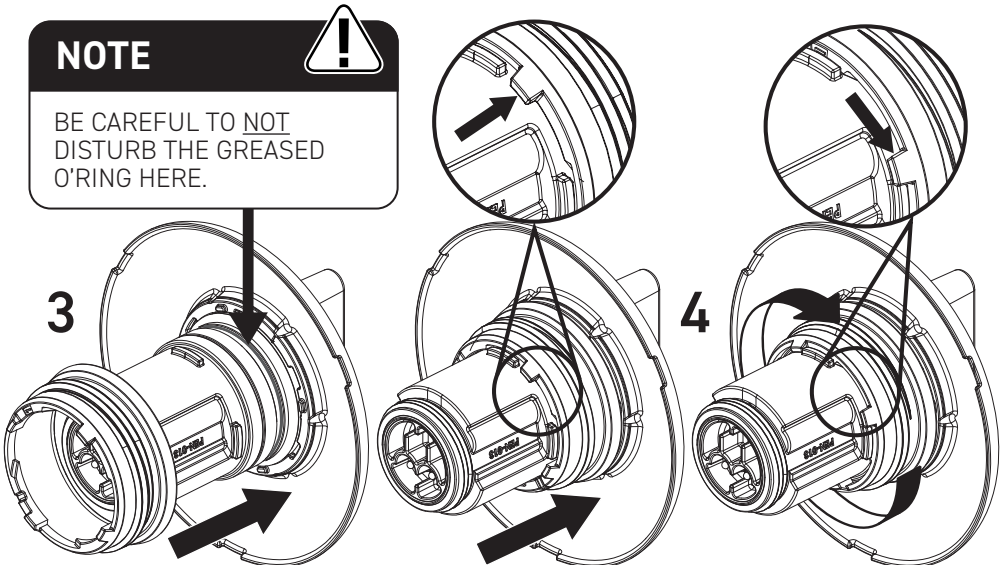

# WINTERIZATION

## 1 UN-THREAD LIGHT FROM BULKHEAD

1. INSERT THE LIGHT INSTALLATION TOOL INTO THE FRONT OF THE LIGHT ASSEMBLY, ALIGNING THE TEETH ON THE TOOL WITH THE SLOTS ON THE RIM.
2. TWIST THE LIGHT ASSEMBLY WITH THE TOOL ANTI-CLOCKWISE TO UN-THREAD FROM THE BULKHEAD FITTING.

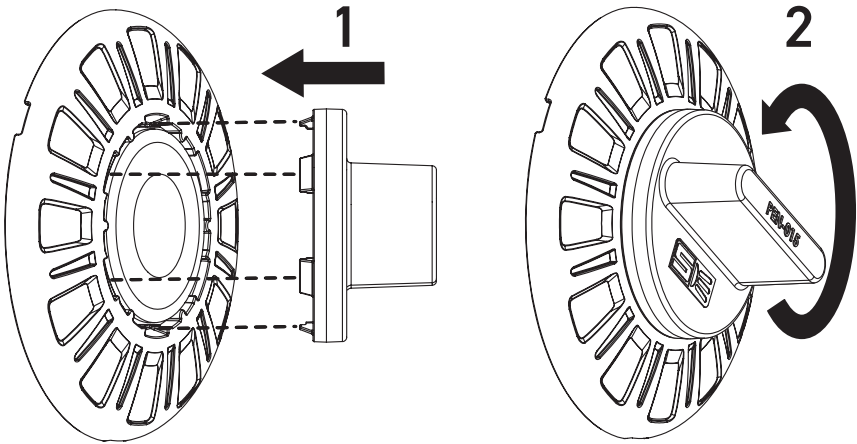

## 2 PULL LIGHT OUT OF BULKHEAD FITTING

PULL LIGHT ASSEMBLY WITH PLUG ATTACHED OUT OF THE BULKHEAD FITTING.

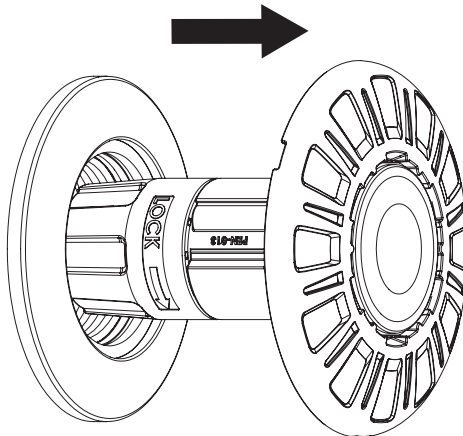

### 3

## REMOVE PLUG COLLAR FROM LIGHT

UNSCREW PLUG COLLAR ANTI-CLOCKWISE UNTIL IT IS FREE SPINNING.

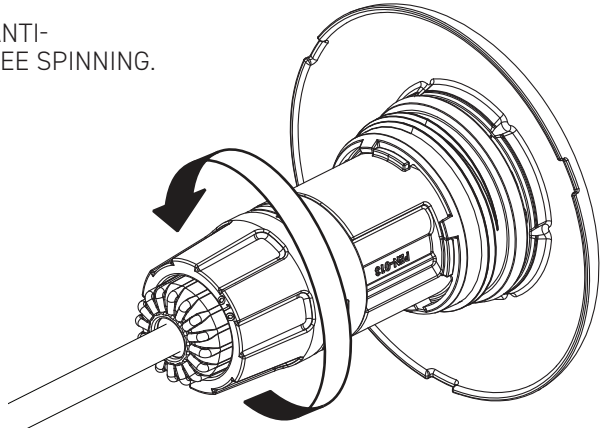

### IMPORTANT NOTES



CABLE SHOULD BE SECURED ABOVE WATER AND WEATHER PROTECTED WHILE LIGHT IS DETACHED.

### 4

## REMOVE PLUG FROM LIGHT

DISCONNECT LIGHT ASSEMBLY FROM PLUG BY PULLING APART.

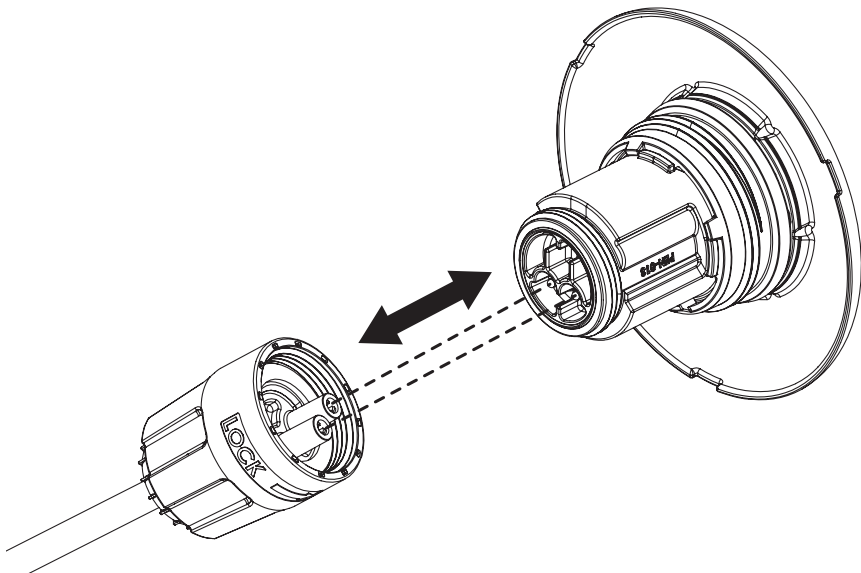

# 5

## ATTACH PLUG COVER TO PLUG

ALIGN THE TERMINAL PINS ON THE PLUG WITH THE SLOT ON THE PLUG COVER AND CONNECT TOGETHER.

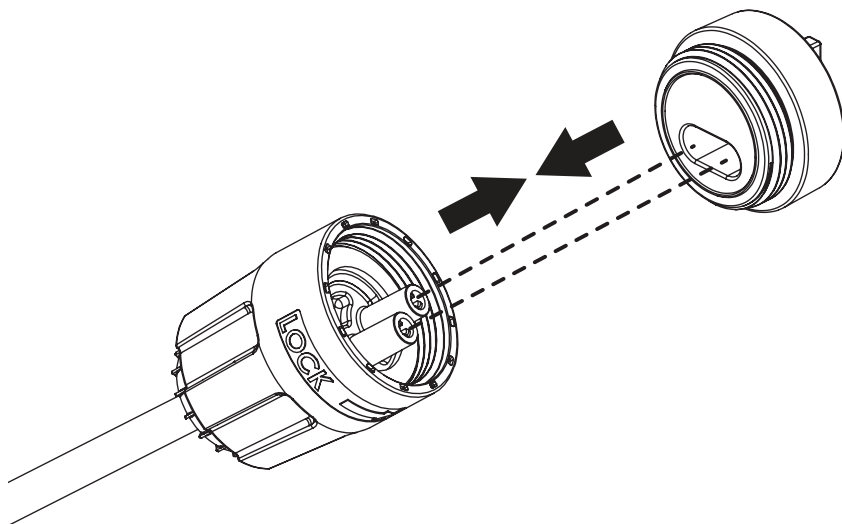

# 6

## FASTEN PLUG COVER

TO LOCK INTO PLACE:

TWIST THE PLUG **COLLAR** CLOCKWISE A FEW TIMES UNTIL IT'S HAND TIGHT.

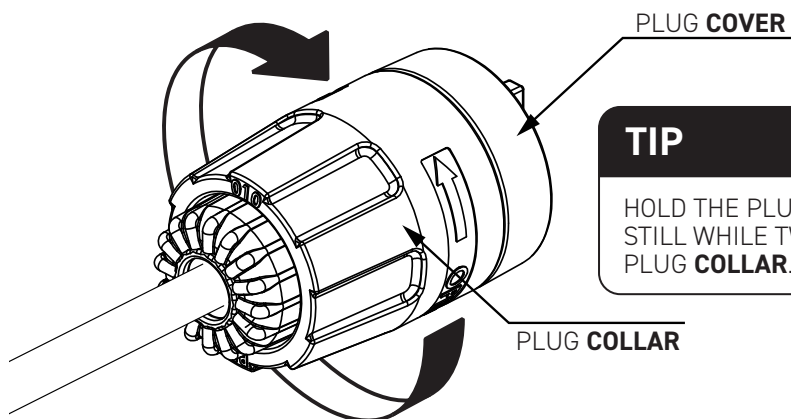

### TIP



HOLD THE PLUG **COVER** STILL WHILE TWISTING THE PLUG **COLLAR**.

# 7

## REMOVE WATER FROM PIPE

REMOVE THE REMAINING WATER FROM THE PIPING, THIS MAY INVOLVE BLOWING OUT WITH COMPRESSED AIR.

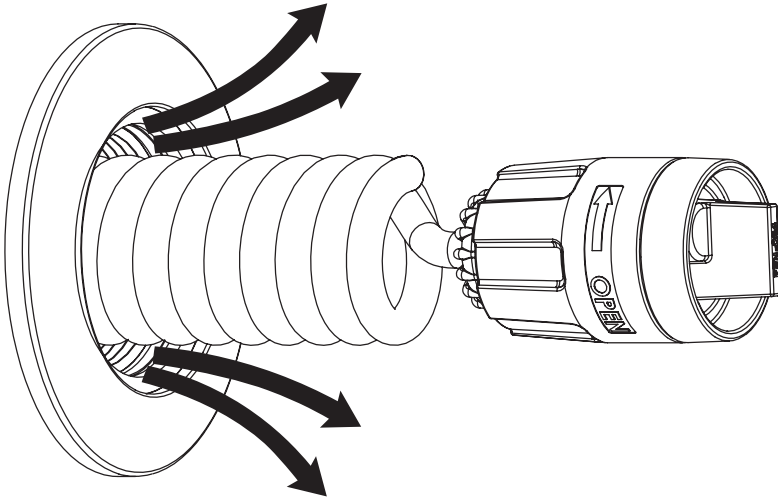

# 8

## STORE CABLE

STORE CABLE BACK INTO THE PIPING.

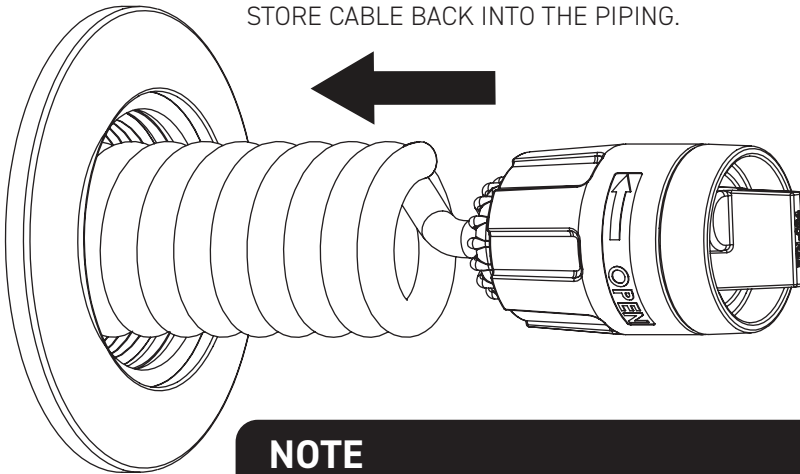

### NOTE



IF FITMENT INTO THE PIPE IS TIGHT, ROTATING THE COILED CABLE SECTION CLOCKWISE WILL HELP PROVIDE CLEARANCE TO THE PIPE.

# 9

## SEAL PIPE OPENING

SELECT FROM COMMONLY AVAILABLE WINTERIZATION FITTINGS TO SEAL OFF THE BULKHEAD FITTING, IT IS IMPORTANT TO ENSURE THEY ARE APPROPRIATELY SELECTED AND INSTALLED TO ACHIEVE A WATER TIGHT SEAL.

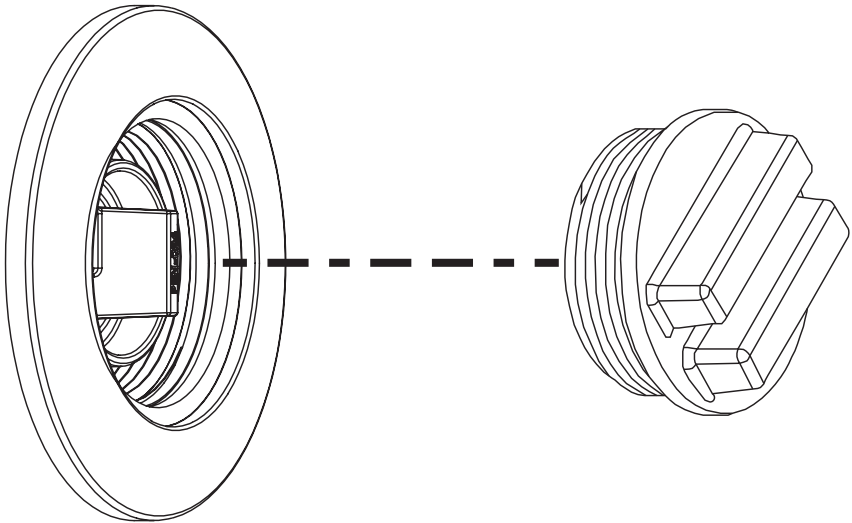

### IMPORTANT NOTE



IMAGE OF SEALED FITTING SHOWN FOR REFERENCE ONLY. ENSURE THE CORRECT TYPE IS SELECTED TO SEAL OFF BULKHEAD FITTING.

# KEY DIMENSIONS

## A LARGE RIM (FIBERGLASS/ VINYL)

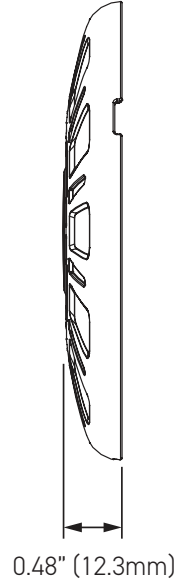
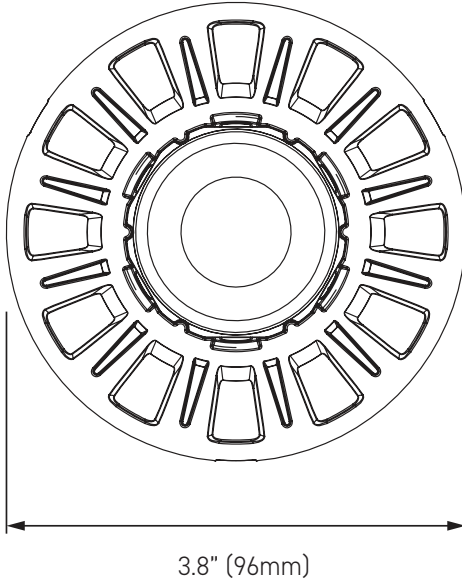

## B SMALL RIM (CONCRETE)

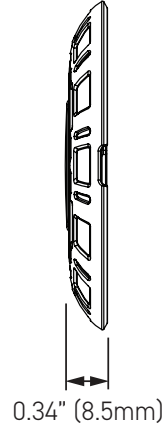
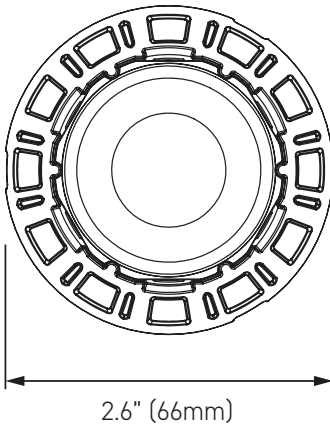

# TROUBLESHOOTING

ISSUE	REASON	ACTION
Light returns to WHITE color during manual color change	Light synchronization process has been triggered	Refer to MULTI PLUS Installation & User Guide
Light flashes 2 times (RED)	Light over heating.	Check light is fully submerged. Check vents are not obstructed
Light not operating (1)	Faulty connection to transformer	Ensure cable correctly connected to transformer terminals
Light not operating (2)	Mains power not connected	Check transformer is plugged in to GPO and switched on
Light not operating (3)	Damaged cable	Disconnect plug top and test voltage under load using multi-meter (ie. 20w 12v)
Light not operating (4)	Transformer not working	Check fuses & test transformer using multimeter under load (ie.15W 12V)
Light colors not synchronized	Incorrect operating mode selected.	Refer to MULTI PLUS setup procedure

**If these issues cannot be resolved with the above recommended actions, please contact your local Spa Electrics reseller or Spa Electrics directly.**

[www.spaelectrics.com](http://www.spaelectrics.com)

# ELECTRICAL GROUNDING

## Underwriters Laboratories (UL) Statement

Per the NEC, NFPA 70, Article 680.23 (B)(5), states that bonding shall not be required for luminaires that are listed for the application and have no non-current carrying metal parts. In addition, per Article 680.26 (B)(4), exception states that Listed low-voltage lighting systems with non-metallic forming shells shall not require bonding.

Therefore, luminaires with polymeric/non-current carrying metal parts are not required to be grounded / bonded.

## Manufacturers Statement

Spa Electrics **Retro T1** luminaires with their plastic housing designs do not require grounding / bonding.

Spa Electrics **Retro T1** lights have also been determined to comply with the applicable requirements for wet-niche, LED type Swimming Pool and Spa Luminaires.

# FCC COMPLIANCE STATEMENT

This device complies with part 15 of the FCC rules. Operation is subject to the following two (2) conditions:

1. This device may not cause harmful interference, and
2. This device must accept any interference received, including interference that may cause undesired operation.

**Note:** This equipment has been tested and found to comply with the limits for a Class B digital device, pursuant to part 15 of the FCC Rules. These limits are designed to provide reasonable protection against harmful interference in a residential installation. This equipment generates, uses and can radiate radio frequency energy and, if not installed and used in accordance with the instructions, may cause harmful interference to radio communications. However, there is no guarantee that interference will not occur in a particular installation. If this equipment does cause harmful interference to radio or television reception, which can be determined by turning the equipment off and on, the user is encouraged to try to correct the interference by one or more of the following measures:

- **Reorient or relocate the receiving antenna.**
- **Increase the separation between the equipment and receiver.**
- **Connect the equipment into an outlet on a circuit different to that to which the receiver is connected.**
- **Consult the dealer or an experienced radio / TV technician for help.**

**Do not make any changes or modifications to the equipment unless otherwise specified in the manual.**

PAGE INTENTIONALLY LEFT BLANK

PAGE INTENTIONALLY LEFT BLANK



## IMPORTANT NOTE

PLEASE STORE THIS MANUAL IN A SAFE PLACE  
FOR FUTURE REFERENCE



 **Spa Electrics<sup>®</sup>**

*The underwater lighting specialists*

[spaelectrics.com](http://spaelectrics.com)

©COPYRIGHT 2025 SPA ELECTRICS INC.  
ALL RIGHTS RESERVED

US 2025 01 30